

Escalated Cable Replacement
9922 Ives Ln N, Maple Grove

Feeder. ECK321/B phase/ 7.97Kva

Directional Bore. Bore in 6000' of #2 AL 1 phase cable
From X to Y, D3 to Splice pit, Splice pit to E2, E2 to F2, F2 to G2,
G2 to H2, H2 to K, K to L, I to M, N to P

Terminations. 22 terminations at X, Y, D3, E2, F2,
G2, H2, J, K, L, M, N & P

Replace Transformer and Basement at L
Replace Basement only at X, Y, J, K, M, & N

Restorations.

Plant ID # D214 Maple Grove
SP# 754360

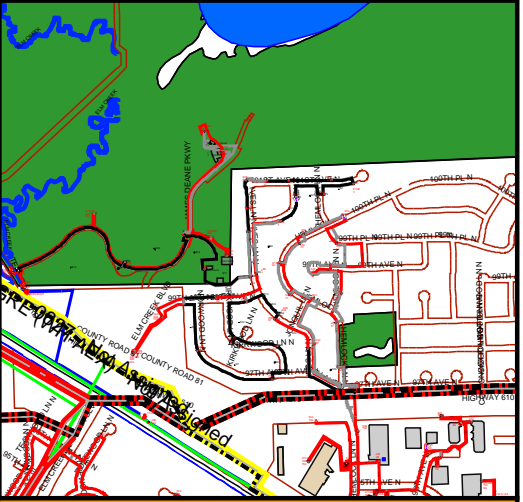

Brad Lylum
O (651)-229-5571

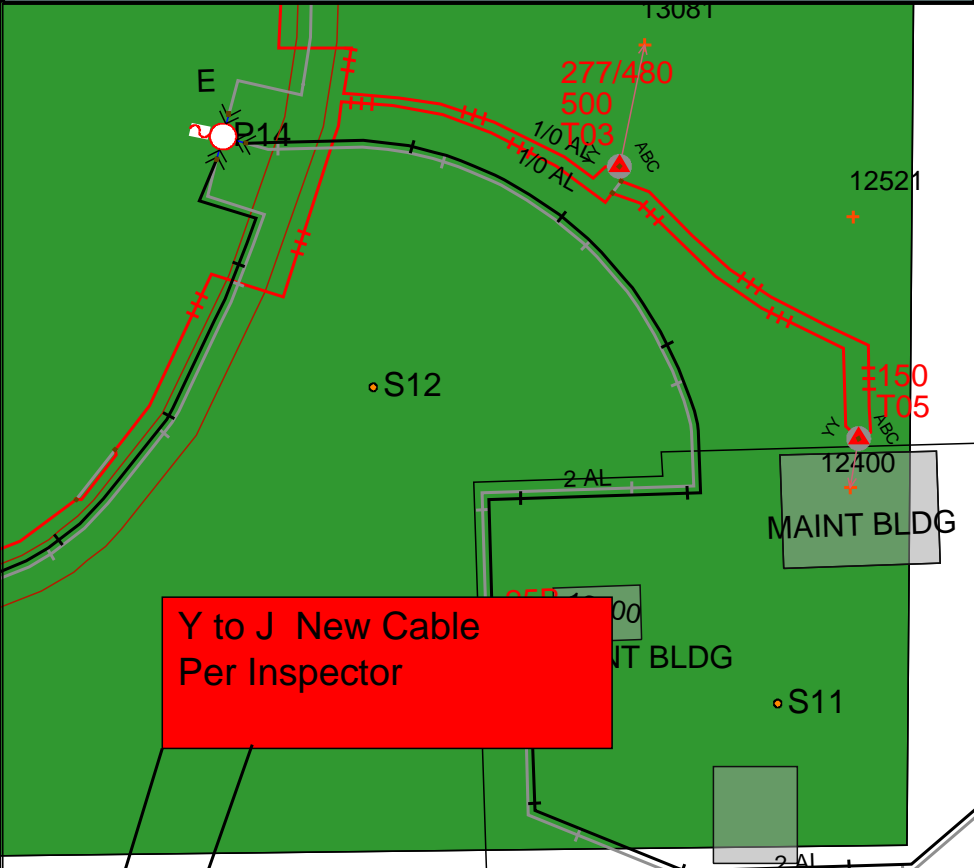

Y to J New Cable
Per Inspector

Y to J New Cable
Per Inspector

Faulted Span J to D3

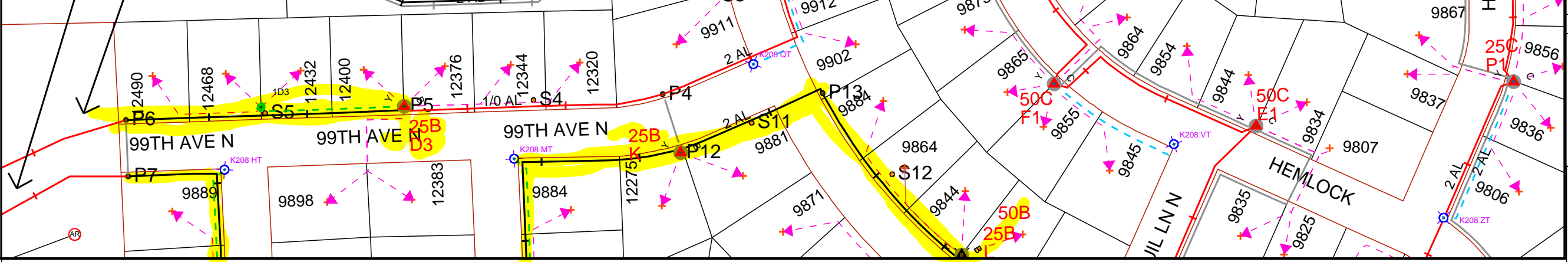

Work Order Information	
Service Request #	:
Design Number	: 00000870782
Designer/Planner ID	: 233210
Designer/Planner Name	: Lylum,Bradley
Designer/Planner Ph #	: (651) 229-5571
Manager Approval	:

Joint Utility	
E:	G:
T:	C:

Design Location	
Division	: Maple Grove
County	: Hennepin
City	: Maple Grove
Address	: 9922 Ives Ln N
T: 119N	R: 22W S: 11
Map #	: K52008 Permit :

Electric	
Feeder	: See Notes Voltage: See Notes
Phase	: See Notes Bkup Dev ID:

Gas	
System	: Pressure :
Size	: Material :
Dead End	:

Work Order # :
Date: 05/30/2019
Sketch: # Of # Sketch Data
Scale: 1" equals 144'

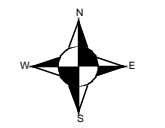

CONSTRUCTION USE ONLY	
<input type="checkbox"/>	NO CHANGES (BUILT AS DESIGNED)
<input type="checkbox"/>	CHANGES MADE AS INDICATED (ALL URD MUST HAVE ACTUAL MEASUREMENTS FROM THE FIELD SITE)

RFO
FOREMAN _____ DATE _____
TEAM LEADER _____

DISCLAIMER: THERE ARE NO REPRESENTATIONS OR WARRANTIES (EXPRESS OR IMPLIED) ABOUT THE ACCURACY OF THIS PRINT. THIS PRINT IS PROVIDED WITH NO CLAIM AS TO PRINT COMPLETENESS, TIMELINESS, ACCURACY OF CONTENT OR USEFULNESS. STATE LAW REQUIRES ANYONE DIGGING, GRADING OR EXCAVATING TO OBTAIN A PRIOR FIELD LOCATE OF ALL UTILITIES; THIS PRINT DOES NOT DISCHARGE THIS REQUIREMENT OR ANY OTHER REQUIREMENT. THE COMPANY AND ITS AFFILIATES ASSUME NO LEGAL RESPONSIBILITY OR LIABILITY FOR THE RECIPIENT'S USE (OR ANY OTHER PARTIES' USE) OF THE PRINT, INCLUDING THE RECIPIENTS INTENDED PURPOSE IN USING THE PRINT. NO COMPANY EMPLOYEE OR OTHER PARTY HAS BEEN AUTHORIZED TO PROVIDE THIS PRINT FOR PLANNING OR ESTIMATING PURPOSES; RELY ON THIS PRINT AT YOUR OWN RISK. BY ACCEPTING THIS PRINT, THE RECIPIENT & ANY OTHER PARTY RECEIVING A COPY OF THE PRINT ACKNOWLEDGES AND AGREES TO THIS DISCLAIMER. For All Field Locates Call 811

Plant ID # D214 Maple Grove

SP# 754360

Escalated Cable Replacement
9922 Ives Ln N, Maple Grove

Feeder. ECK321/B phase/ 7.97Kva

Directional Bore. Bore in 6000' of #2 AL 1 phase cable
From X to Y, D3 to Splice pit, Splice pit to E2, E2 to F2, F2 to G2,
G2 to H2, H2 to K, K to L, I to M, N to P

Terminations.22 terminations at X, Y, D3, E2, F2,
G2, H2, J, K, L, M, N & P
Replace Transformer and Basement at L
Replace Basement only at X, Y, J, K, M, & N

Restorations.

Brad Lylum
O (651)-229-5571

Work Order Information

Service Request #	:	
Design Number	:	00000870782
Designer/Planner ID	:	233210
Designer/Planner Name	:	Lylum,Bradley
Designer/Planner Ph #	:	(651) 229-5571
Manager Approval	:	

Joint Utility

E:	G:
T:	C:

Design Location

Division	:	Maple Grove
County	:	Hennepin
City	:	Maple Grove
Address	:	9922 Ives Ln N
T: 119N	R: 22W	S: 11
Map #	:	K52008
Permit	:	

Electric

Feeder:	See Notes	Voltage:	See Notes
Phase:	See Notes	Bkup Dev ID:	

Gas

System	:	Pressure	:
Size	:	Material	:
Dead End	:		

Work Order #

Date:	05/30/2019
Sketch: #	Of # Sketch Data
Scale:	1" equals 144'



CONSTRUCTION USE ONLY

- NO CHANGES (BUILT AS DESIGNED)
- CHANGES MADE AS INDICATED (ALL URD MUST HAVE ACTUAL MEASUREMENTS FROM THE FIELD SITE)

RFO _____
 FOREMAN _____ DATE _____
 TEAM LEADER _____

Faulted Span M to N

DISCLAIMER: THERE ARE NO REPRESENTATIONS OR WARRANTIES (EXPRESS OR IMPLIED) ABOUT THE ACCURACY OF THIS PRINT. THIS PRINT IS PROVIDED WITH NO CLAIM AS TO PRINT COMPLETENESS, TIMELINESS, ACCURACY OF CONTENT OR USEFULNESS. STATE LAW REQUIRES ANYONE DIGGING, GRADING OR EXCAVATING TO OBTAIN A PRIOR FIELD LOCATE OF ALL UTILITIES; THIS PRINT DOES NOT DISCHARGE THIS REQUIREMENT OR ANY OTHER REQUIREMENT. THE COMPANY AND ITS AFFILIATES ASSUME NO LEGAL RESPONSIBILITY OR LIABILITY FOR THE RECIPIENT'S USE (OR ANY OTHER PARTIES' USE) OF THE PRINT, INCLUDING THE RECIPIENT'S INTENDED PURPOSE IN USING THE PRINT. NO COMPANY EMPLOYEE OR OTHER PARTY HAS BEEN AUTHORIZED TO PROVIDE THIS PRINT FOR PLANNING OR ESTIMATING PURPOSES; RELY ON THIS PRINT AT YOUR OWN RISK. BY ACCEPTING THIS PRINT, THE RECIPIENT & ANY OTHER PARTY RECEIVING A COPY OF THE PRINT ACKNOWLEDGES AND AGREES TO THIS DISCLAIMER. For All Field Locates Call 811