

**8728 FORESTVIEW LN N
RELOCATE PADMOUNT
TRANSFORMERS "M4" & "L4"
FOR NEW SIDEWALK.
*OUTAGES REQUIRED***

ECK063- 7.9KV

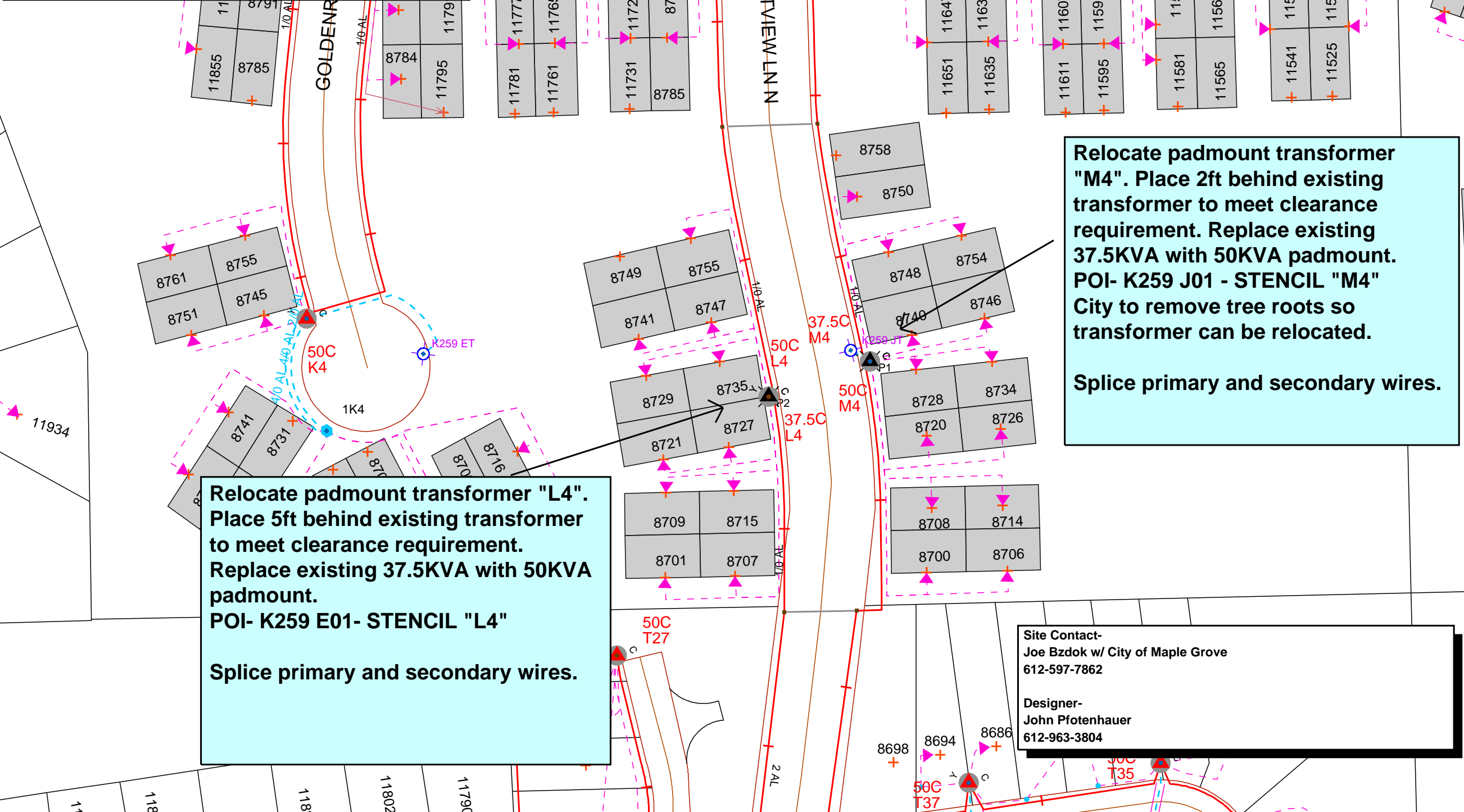
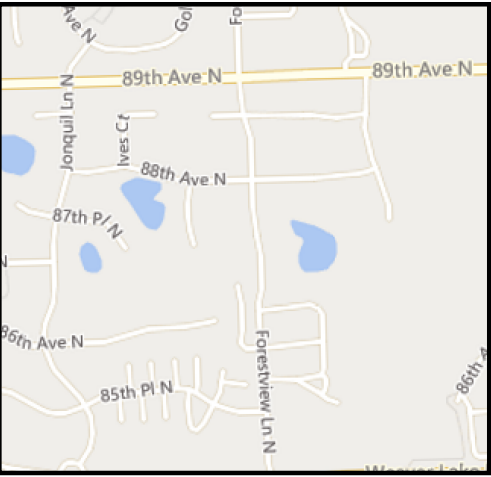

Relocate padmount transformer "M4". Place 2ft behind existing transformer to meet clearance requirement. Replace existing 37.5KVA with 50KVA padmount. POI- K259 J01 - STENCIL "M4" City to remove tree roots so transformer can be relocated.

Splice primary and secondary wires.

Relocate padmount transformer "L4". Place 5ft behind existing transformer to meet clearance requirement. Replace existing 37.5KVA with 50KVA padmount. POI- K259 E01- STENCIL "L4" Splice primary and secondary wires.

Site Contact-
Joe Bzdok w/ City of Maple Grove
612-597-7862

Designer-
John Pfothenauer
612-963-3804

Work Order Information	
Service Request #	:
Design Number	: 000001035011
Designer/Planner ID	: pftj01
Designer/Planner Name	: Pfothenauer, John
Designer/Planner Ph #	: (763) 493-1876
Manager Approval	:

Joint Utility	
E:	G:
T:	C:

Design Location	
Division	: Maple Grove
County	: HENNEPIN
City	: MAPLE GROVE
Address	: 8728 FORESTVIEW LN N
T: 119N	R: 22W S: 14
Map #	: K52059 Permit :

Electric	
Feeder: ECK062	Voltage: 7.9 KV
Phase: C	Bkup Dev ID:

Gas	
System	: Pressure :
Size	: Material :
Dead End	:

Work Order # : **106522067**

Date: 07/19/2021

Sketch: 1 Of 1 Sketch Data

Scale: 1" equals 100'



CONSTRUCTION USE ONLY	
<input type="checkbox"/>	NO CHANGES (BUILT AS DESIGNED)
<input type="checkbox"/>	CHANGES MADE AS INDICATED (ALL URD MUST HAVE ACTUAL MEASUREMENTS FROM THE FIELD SITE)

RFO _____

FOREMAN _____ DATE _____

TEAM LEADER _____

DISCLAIMER: THERE ARE NO REPRESENTATIONS OR WARRANTIES (EXPRESS OR IMPLIED) ABOUT THE ACCURACY OF THIS PRINT. THIS PRINT IS PROVIDED WITH NO CLAIM AS TO PRINT COMPLETENESS, TIMELINESS, ACCURACY OF CONTENT OR USEFULNESS. STATE LAW REQUIRES ANYONE DIGGING, GRADING OR EXCAVATING TO OBTAIN A PRIOR FIELD LOCATE OF ALL UTILITIES. THIS PRINT DOES NOT DISCHARGE THIS REQUIREMENT OR ANY OTHER REQUIREMENT. THE COMPANY AND ITS AFFILIATES ASSUME NO LEGAL RESPONSIBILITY OR LIABILITY FOR THE RECIPIENT'S USE (OR ANY OTHER PARTIES' USE) OF THE PRINT, INCLUDING THE RECIPIENT'S INTENDED PURPOSE IN USING THE PRINT. NO COMPANY EMPLOYEE OR OTHER PARTY HAS BEEN AUTHORIZED TO PROVIDE THIS PRINT FOR PLANNING OR ESTIMATING PURPOSES; RELY ON THIS PRINT AT YOUR OWN RISK. BY ACCEPTING THIS PRINT, THE RECIPIENT & ANY OTHER PARTY RECEIVING A COPY OF THE PRINT ACKNOWLEDGES AND AGREES TO THIS DISCLAIMER. For All Field Locates Call 811

THIS DOCUMENT IS XCEL ENERGY CONFIDENTIALS AND PROPRIETARY INFORMATION AND MAY NOT BE REPRODUCED IN WHOLE, OR IN PART, NOR MAY ANY OF THE INFORMATION CONTAINED HEREIN BE DISCLOSED WITHOUT THE CONSENT OF XCEL ENERGY. CONFIDENTIALS AND PROPRIETARY INFORMATION © 2019 XCEL ENERGY INC. | XCEL ENERGY IS REGISTERED TRADEMARK OF XCEL ENERGY INC