

4.14.21 ✓

Bass Lake Rd

Juneau In n

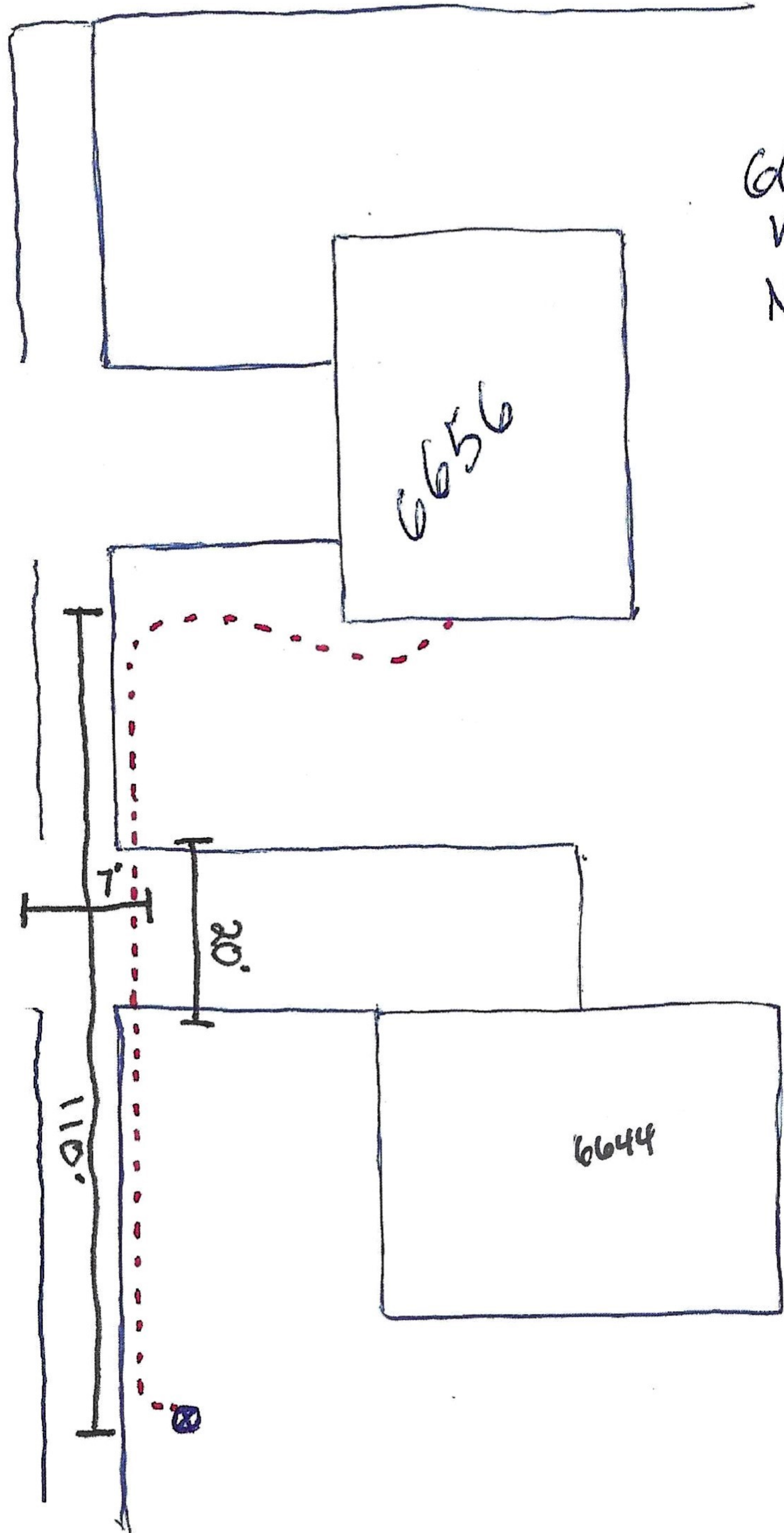

6656 Juneau In n
m.g.
Need to bore Neighbor's
Driveway





Hennepin County Property Map

Date: 4/25/2021



PARCEL ID: 3311922130009

OWNER NAME: Yan Ashe & Ilona Ashe

PARCEL ADDRESS: 6656 Juneau La N, Maple Grove MN 55311

PARCEL AREA: 0.27 acres, 11,745 sq ft

A-T-B: Torrens

SALE PRICE: \$90,000

SALE DATA: 12/2019

SALE CODE: Vacant Land

ASSESSED 2020, PAYABLE 2021
PROPERTY TYPE: Vacant Land-Residential
HOMESTEAD: Non-Homestead
MARKET VALUE: \$53,000
TAX TOTAL: \$787.48

ASSESSED 2021, PAYABLE 2022
PROPERTY TYPE: Residential
HOMESTEAD: Non-homestead
MARKET VALUE: \$300,200

Comments:

This data (i) is furnished 'ASIS' with no representation as to completeness or accuracy; (ii) is furnished with no warranty of any kind; and (iii) is not suitable for legal, engineering or surveying purposes. Hennepin County shall not be liable for any damage, injury or loss resulting from this data.

COPYRIGHT © HENNEPIN COUNTY 2021