

# PERMIT DRAWING

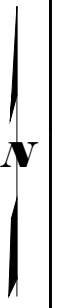

DIRECT BORE TO PLACE 146' OF FIBER

500' TO FOUNTAINS DR

CENTURYLINK FIBER

EXISTING HH

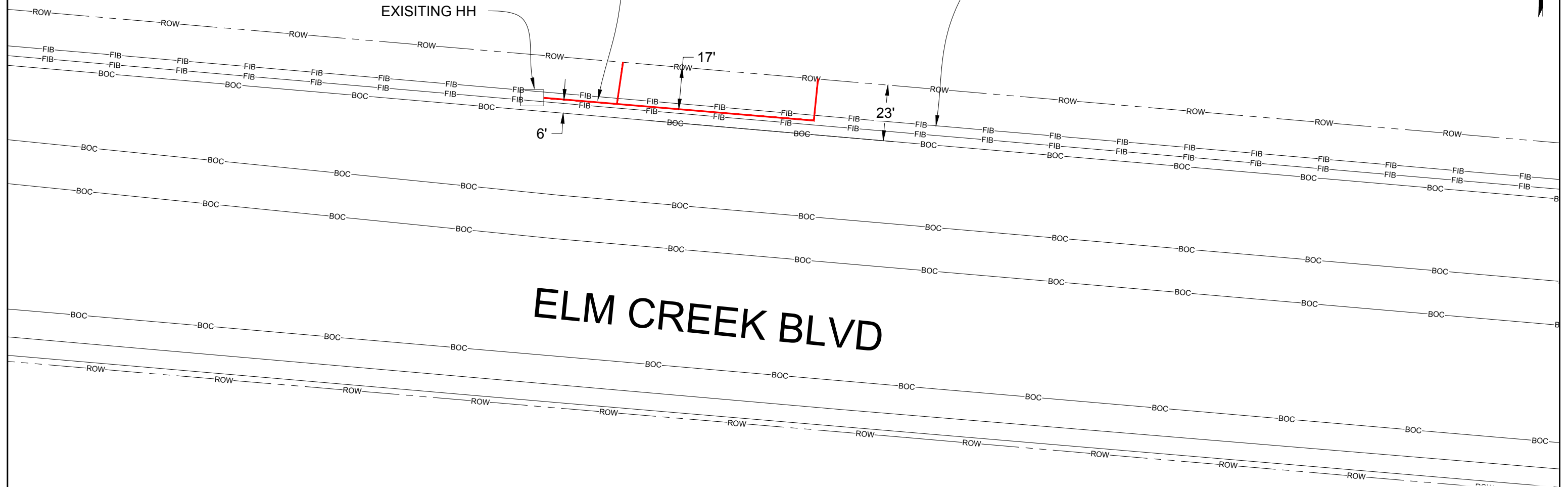

## ELM CREEK BLVD

### CITY OF MAPLE GROVE PERMIT NOTES:

1. THIS JOB USES DIRECTIONAL BORING TO PLACE 146' OF FIBER OPTIC CABLE
2. HAND DIGGING WILL BE USED.
3. ALL DISTURBED SURFACES WILL BE RESTORED TO AS GOOD AS OR BETTER CONDITION THAN FOUND CONDITION.
4. ALL EXISTING UNDERGROUND UTILITIES WILL BE LOCATED PRIOR TO CONSTRUCTION.
5. ANY CONFLICTING UNDERGROUND UTILITIES WILL BE POT HOLED.
6. 36" MINIMUM COVER WILL BE MAINTAINED ALONG ROADWAY
7. BORE SHALL MAINTAIN 2' CLEARANCE FROM HAND HOLES STREET LIGHTS & SIGNAL POLE FOUNDATION.

**NO WORK SHALL COMMENCE UNTIL A SIGNED PERMIT IS IN HAND AND ON SITE WITH CONTRACTOR**



PERMITS REQUIRED: CITY OF MAPLE GROVE  
 W/C: MPGVMNXA  
 CPA: BPARSONS  
 CPS: BRICHTER

CONTACT PERSON: SHAWN NIESS  
 PHONE: 651-312-5289  
 FAX:  
 EMAIL: SHAWN.NIESS@CENTURYLINK.COM

JOB: N.179993  
 Loc.: 11700 ELM CREEK BLVD N,  
 MAPLE GROVE, MN  
 ISSUE DATE:

### DRAWING SYMBOLS

