

**EVERY PARK**  
**MAPLE GROVE**

**PROJECT NOTES:**  
INSTALL #2AL PRIMARY IN JOINT TRENCH W/GAS, CATV AND COMMUNICATIONS. RUN JOINT TRENCH IN DRAIN AND UTILITY EASEMENT 25-35' FROM CENTERLINE, USE PLAT FOR REFERENCE. RUN 350AL TO PEDS AND 4/0 SVC STUBS TO SINGLE FAMILY HOMES LOT LINES.

FEEDER: OSS073      AVG SQ FT: 3,000'

MAP BOUNDARY:      LONGEST SVC RUN: <250'

**L52011 - NORTH SECTION**

**L52021 - SOUTH SECTION**

**UG MATERIALS:**  
50KVA XFRMR= 14  
PEDS= 17  
#2AL PRIMARY= 4,118'  
350AL= 1,088'  
4/0AL SVC= 3,861

**OH MATERIALS**  
45/2 POLE= 1  
3PH TGT BUILD= 2

**STREETLIGHTS**  
18' FG DB POLES W/TRADITIONAL FIXTURES= 10  
30' FG DB POLES W/COBRA FIXTURES= 2

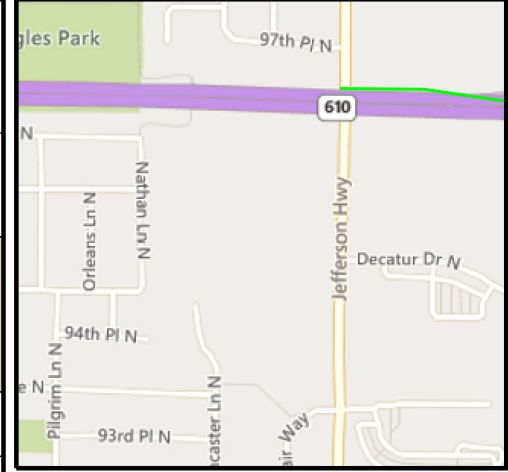
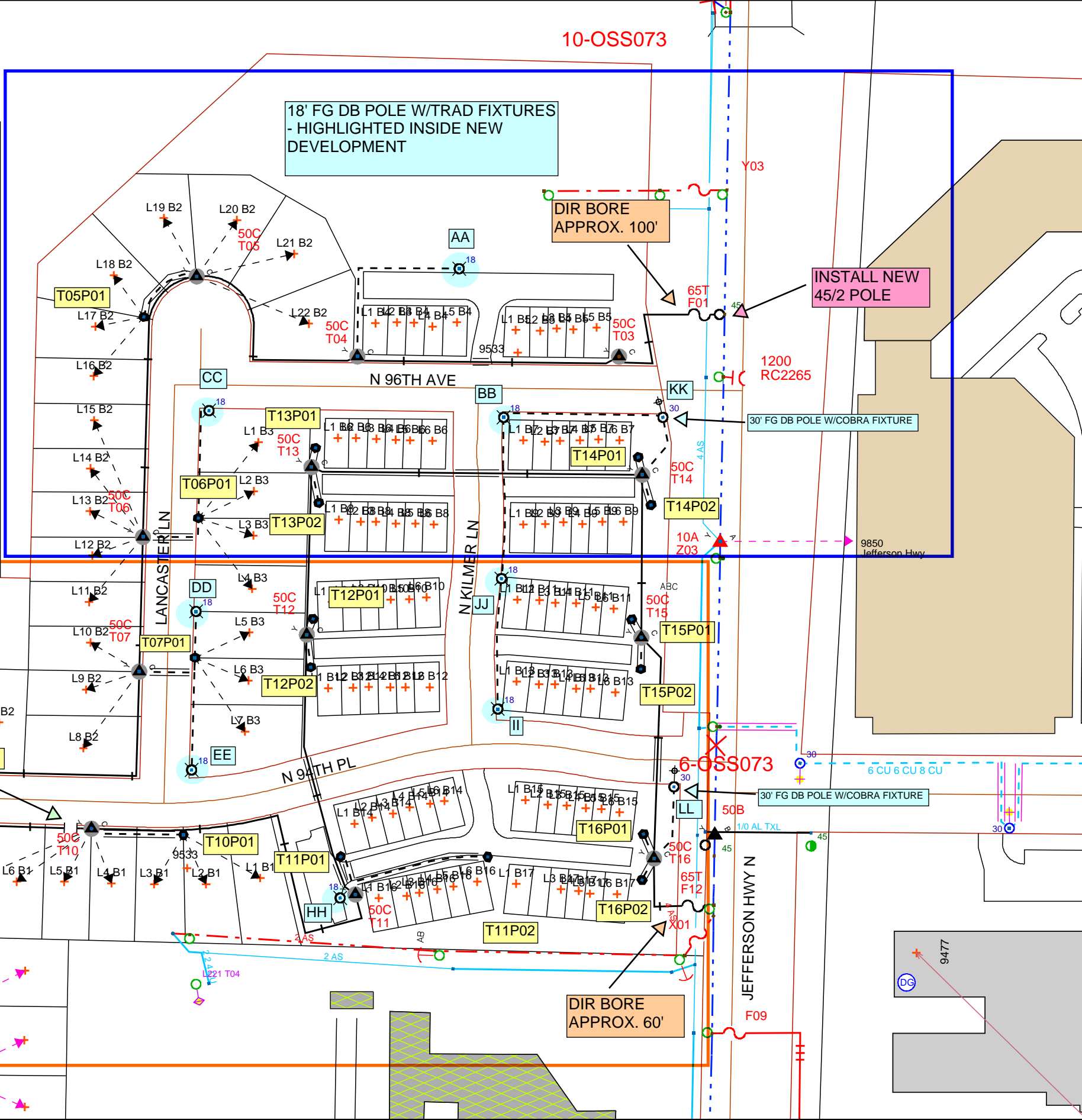

DESIGNER: FONG YANG  
EMAIL: FONG.YANG@XCELENERGY.COM  
CELL: 763.228.6699

Work Order Information  
SVC DESIGNER: SEAN MCNAMARA  
DEVELOPER: NATHAN FAIR  
PHONE: 763.438.2561

Joint Utility	
E:	G:
T:	C:

Design Location	
Division :	Maple Grove
County :	Hennepin
City :	Maple Grove
Address :	
T: 119N	R: 22W S: 12
Map # :	L52021
Permit :	

Electric	
Feeder:	Voltage:
Phase:	Bkup Dev ID:

Gas	
System :	Pressure :
Size :	Material :
Dead End :	

Work Order # :

Date: 03/23/2021

Sketch: # Of # Sketch Data

Scale: 1" equals 131'

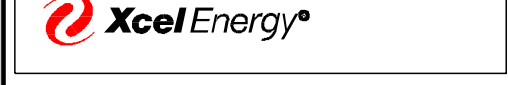

**CONSTRUCTION USE ONLY**

NO CHANGES (BUILT AS DESIGNED)  
 CHANGES MADE AS INDICATED  
(ALL URD MUST HAVE ACTUAL MEASUREMENTS FROM THE FIELD SITE)

RFO \_\_\_\_\_  
FOREMAN \_\_\_\_\_ DATE \_\_\_\_\_  
TEAM LEADER \_\_\_\_\_

DISCLAIMER: THERE ARE NO REPRESENTATIONS OR WARRANTIES (EXPRESS OR IMPLIED) ABOUT THE ACCURACY OF THIS PRINT. THIS PRINT IS PROVIDED WITH NO CLAIM AS TO PRINT COMPLETENESS, TIMELINESS, ACCURACY OF CONTENT OR USEFULNESS. STATE LAW REQUIRES ANYONE DIGGING, GRADING OR EXCAVATING TO OBTAIN A PRIOR FIELD LOCATE OF ALL UTILITIES. THIS PRINT DOES NOT DISCHARGE THIS REQUIREMENT OR ANY OTHER REQUIREMENT. THE COMPANY AND ITS AFFILIATES ASSUME NO LEGAL RESPONSIBILITY OR LIABILITY FOR THE RECIPIENT'S USE (OR ANY OTHER PARTIES' USE) OF THE PRINT, INCLUDING THE RECIPIENT'S INTENDED PURPOSE IN USING THE PRINT. NO COMPANY EMPLOYEE OR OTHER PARTY HAS BEEN AUTHORIZED TO PROVIDE THIS PRINT FOR PLANNING OR ESTIMATING PURPOSES; RELY ON THIS PRINT AT YOUR OWN RISK. BY ACCEPTING THIS PRINT, THE RECIPIENT & ANY OTHER PARTY RECEIVING A COPY OF THE PRINT ACKNOWLEDGES AND AGREES TO THIS DISCLAIMER. For All Field Locates Call 811

THIS DOCUMENT IS XCEL ENERGY CONFIDENTIALS AND PROPRIETARY INFORMATION AND MAY NOT BE REPRODUCED IN WHOLE, OR IN PART, NOR MAY ANY OF THE INFORMATION CONTAINED HEREIN BE DISCLOSED WITHOUT THE CONSENT OF XCEL ENERGY. CONFIDENTIALS AND PROPRIETARY INFORMATION © 2019 XCEL ENERGY INC. | XCEL ENERGY IS REGISTERED TRADEMARK OF XCEL ENERGY INC