

Escalated Cable Replacement
16320 Lake Ridge Dr, Maple Grove

Feeder. ECK082/B Phase/7.97Kva

Directional Bore. 585' of #2 AL 1 Phase cable
from D to E, E to F

Terminations. 4 terminations at D, E and F
Replace 25Kva xfmer with 50kva Xfmer at E and F
Replace Pads with Basements at E and F

Restorations.

PAGE 1 of 1

Plant ID # D214 Maple Grove

SP# 771147

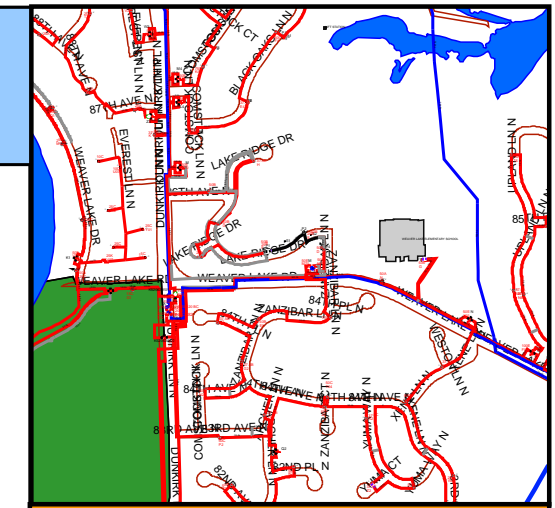

Brad Lylum
O (651)-229-5571

Work Order Information	
Service Request #	:
Design Number	: 00000983299
Designer/Planner ID	: 233210
Designer/Planner Name	: Lylum,Bradley
Designer/Planner Ph #	: (651) 229-5571
Manager Approval	:

Joint Utility	
E:	G:
T:	C:

Design Location	
Division	: Maple Grove
County	: Hennepin
City	: Maple Grove
Address	: 16320 Lake Ridge Dr
T: 119N	R: 22W S: 17
Map #	: K52053 Permit :

Electric	
Feeder	: See Notes Voltage: See Notes
Phase	: See Notes Bkup Dev ID:

Gas	
System	: Pressure :
Size	: Material :
Dead End	:

Work Order # :
Date: 11/13/2020
Sketch: # Of # Sketch Data
Scale: 1" equals 100'



CONSTRUCTION USE ONLY	
<input type="checkbox"/>	NO CHANGES (BUILT AS DESIGNED)
<input type="checkbox"/>	CHANGES MADE AS INDICATED (ALL URD MUST HAVE ACTUAL MEASUREMENTS FROM THE FIELD SITE)

RFO _____
FOREMAN _____ DATE _____
TEAM LEADER _____

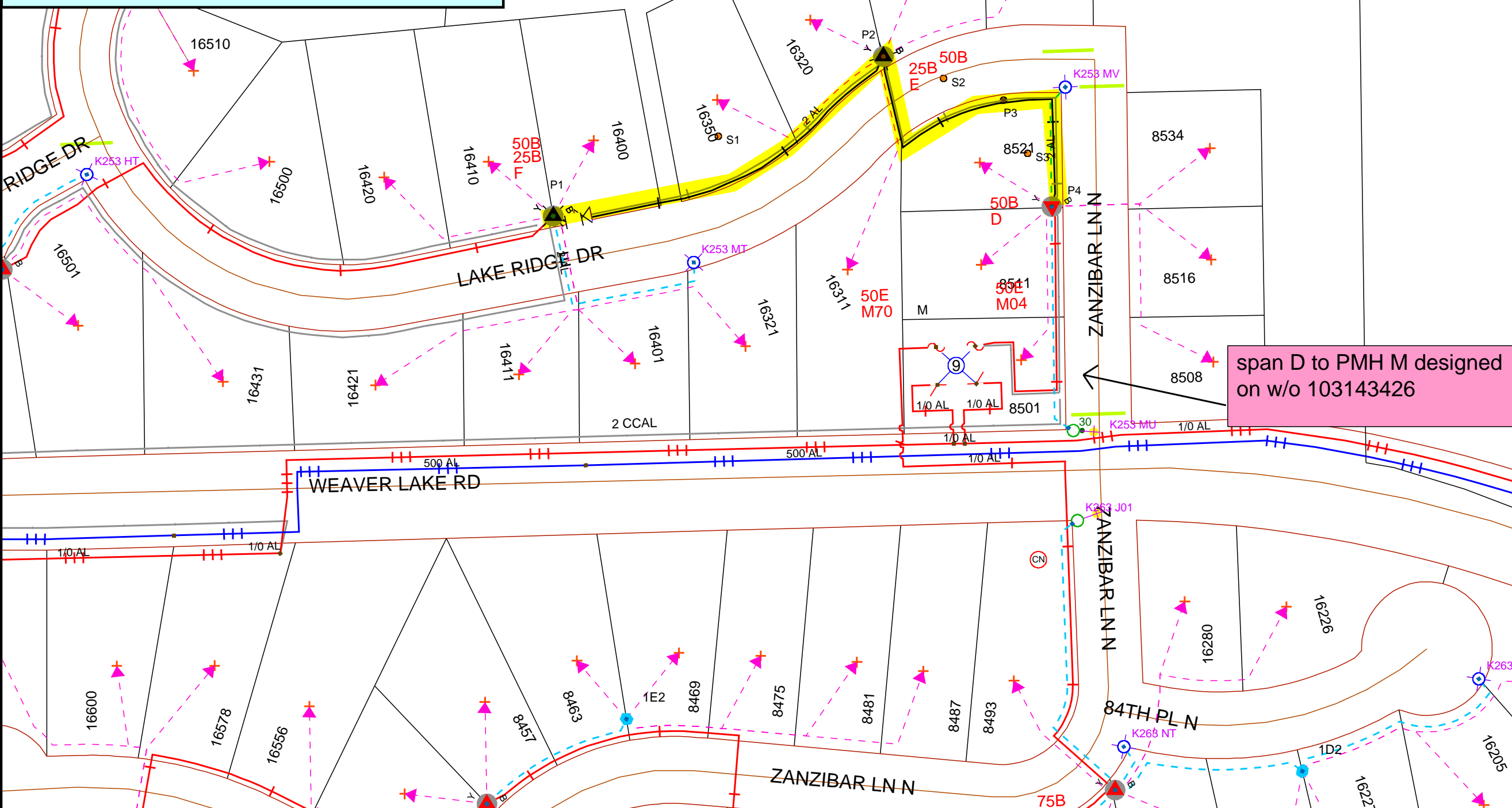

span D to PMH M designed on w/o 103143426

DISCLAIMER: THERE ARE NO REPRESENTATIONS OR WARRANTIES (EXPRESS OR IMPLIED) ABOUT THE ACCURACY OF THIS PRINT. THIS PRINT IS PROVIDED WITH NO CLAIM AS TO PRINT COMPLETENESS, TIMELINESS, ACCURACY OF CONTENT OR USEFULNESS. STATE LAW REQUIRES ANYONE DIGGING, GRADING OR EXCAVATING TO OBTAIN A PRIOR FIELD LOCATE OF ALL UTILITIES. THIS PRINT DOES NOT DISCHARGE THIS REQUIREMENT OR ANY OTHER REQUIREMENT. THE COMPANY AND ITS AFFILIATES ASSUME NO LEGAL RESPONSIBILITY OR LIABILITY FOR THE RECIPIENT'S USE (OR ANY OTHER PARTIES' USE) OF THE PRINT, INCLUDING THE RECIPIENT'S INTENDED PURPOSE IN USING THE PRINT. NO COMPANY EMPLOYEE OR OTHER PARTY HAS BEEN AUTHORIZED TO PROVIDE THIS PRINT FOR PLANNING OR ESTIMATING PURPOSES; RELY ON THIS PRINT AT YOUR OWN RISK. BY ACCEPTING THIS PRINT, THE RECIPIENT & ANY OTHER PARTY RECEIVING A COPY OF THE PRINT ACKNOWLEDGES AND AGREES TO THIS DISCLAIMER. For All Field Locates Call 811

THIS DOCUMENT IS XCEL ENERGY CONFIDENTIALS AND PROPRIETARY INFORMATION AND MAY NOT BE REPRODUCED IN WHOLE, OR IN PART, NOR MAY ANY OF THE INFORMATION CONTAINED HEREIN BE DISCLOSED WITHOUT THE CONSENT OF XCEL ENERGY. CONFIDENTIALS AND PROPRIETARY INFORMATION © 2019 XCEL ENERGY INC. | XCEL ENERGY IS REGISTERED TRADEMARK OF XCEL ENERGY INC.