

CenturyLink BSW Order/Maintenance Work Authorization

Company	Exchange Name MPGVMNXA	Service Order#
Work Activity Fiber-Buried	Capital N	Maintenance Y
Customer Name Joanne May	Phone# (763) 315-4447	
Address 10607 Wellington Ln N	One Call Ticket#	
City & Zip	Maple Grove Mn	
Location/Directions		
Description of Work or Special Instructions Plow 140 ft of fiber from ped to nid. Previous fiber drop is bad. 80 ft right of way bore required		

Held Order	Y	Permit:	Y	Bore:	Y	CBR#	3103867999
Tech Name and Tech #	Don Evans		Employee Contact#	6124303133			
Sketch (Include Cntr Line & Pedestal)	Material/Labor Units		Footage/Quantity	Comments			
	Description	Notes					
Cntr Line foot	SEB3-22	BSW-3 & plow plcmt					
	SEB3-22T	BSW-3 & hand dig plcmt					
Ped#	SEPCUTOVER	CUTOVER BSW	1				
Parish/County	BM83	BSW guard at house	1				
	XXSEB-GL	Remove temp drop		Footage when temp can't be re-used			
Township:	BM61(1.25)SEB	BSW Bore footage	90				
Section	SEBO PER FT LBR	Fiber & plow plcmt	50				
Range	SEBO PER FT LBR T	Fiber & hand dig plcmt					
	SEB6-22	BSW-6 & plow plcmt					
	BM2(5/8)(8)	Ground Rod					
	Trip Charge	Trip Charge	1				
	Permit	Permit	1	Any placement within the ROW requires a permit			
Nearest cross st.			Plat Page	Map#			

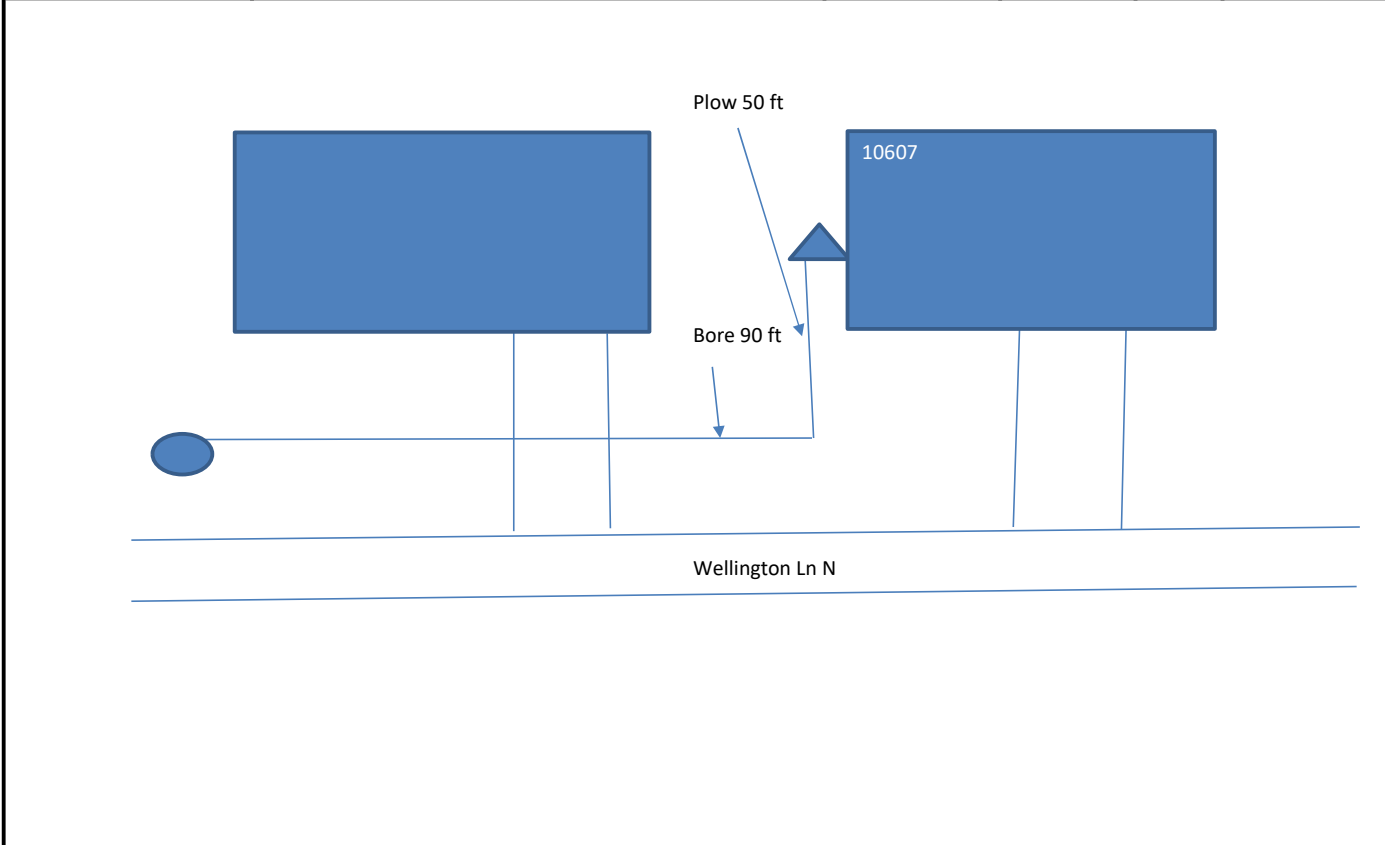

Originated By: Don Evans Date: 10/1/20 Completed By: _____ Date: _____
 Authorized By: (SRO) _____ Date: _____ Inspected By: _____ Date: _____
 Authorized By: (MRO) _____ Date: _____

Email sketch to:

1. Distance of the bury in Right-of-Way	3. Distance to the nearest intersection
2. Distance from the terminal to the centerline	4. Nearest State Hwy mile marker