

NOTE: BORE ALL PAVED STREETS AND DRIVEWAYS  
 Minimum depth requirements for crossings of state highways and county roads is 60". Minimum depth requirements for crossings of city streets and township roads is 48". Minimum depth for parallel installations on state highways and county roads is 36". Minimum depth for parallel installations on city streets and township roads is 30". All steel pipe welds to be coated with 2 part epoxy.

INSTALL LOCATING POINTS AT A MAXIMUM SPACING OF 1,000 FT.

INSTALL 4" PE CL-6 MAIN 32' ECL BROCKTON LN N  
 INSTALL 4" PE CL-6 MAIN 40' NCL 70 PL N  
 INSTALL 2" PE CL-6 MAIN 63' NCL TROY LN N

Install; Clean and Test; and Put in Service; Proposed new main per CenterPoint Energy Construction and Service Manual.

Purge new main until essentially 100% gas reading is obtained on Combustible Gas Indicator. See CenterPoint Energy Construction and Service Manual Section CS-B-1.230 for purging mains into service.

Install a marker ball at a new end of main, at a valve, at each ell of a horizontal offset, at road crossings and at any fitting or pressure control identified as needing to be located in the future. Refer to CenterPoint Energy Construction and Service Manual section CS-B-1.310 for installation procedures.

Procedure for tapping or making tie-ins to existing gas mains: Verify existing gas main size, type, and location prior to tapping or making tie-in. Monitor and verify, using a pressure gauge, existing gas main Pressure Class within the bell hole of tap location or tie-in location prior to tapping or making tie-in.

I hereby certify that this plan, specification, or report was prepared by me or under my direct supervision and that I am a duly Licensed Professional Engineer under the laws of the state of Minnesota.

Signature: *Kyle Brown*

Typed or Printed Name: **Kyle Brown**

Date: **10/13/20** License Number: **57268**

Transmission Line within project area. Follow watchdog procedures.

Transmission Line Watch Dog Process:

CNP excavation contractor will follow the Transmission Line Watch Dog Process.

If excavation will happen within 50' of a transmission line the CNP contractor needs to contact CNP dispatch to schedule a Watch Dog. (DISPATCH 612-321-5200)

Dispatch will create an "inspect contractor" work order for Foreign Construction and set up a time for the crew to be on site.

10/13/2020 12:04:06 PM DESIGNER EXPRESS DESIGN

When butt fusing to existing in-service polyethylene, visually inspect for the presence of hydrocarbon permeation immediately after removing fusion iron. If any bubbling is identified on the heated surface, do not join to new PE pipe. Allow to cool and cut this end off (12" length) and send to the Golden Valley Lab with street location and W.O. #. Complete tie-in/extension using an electrofusion coupling(s).

Document in field notes.

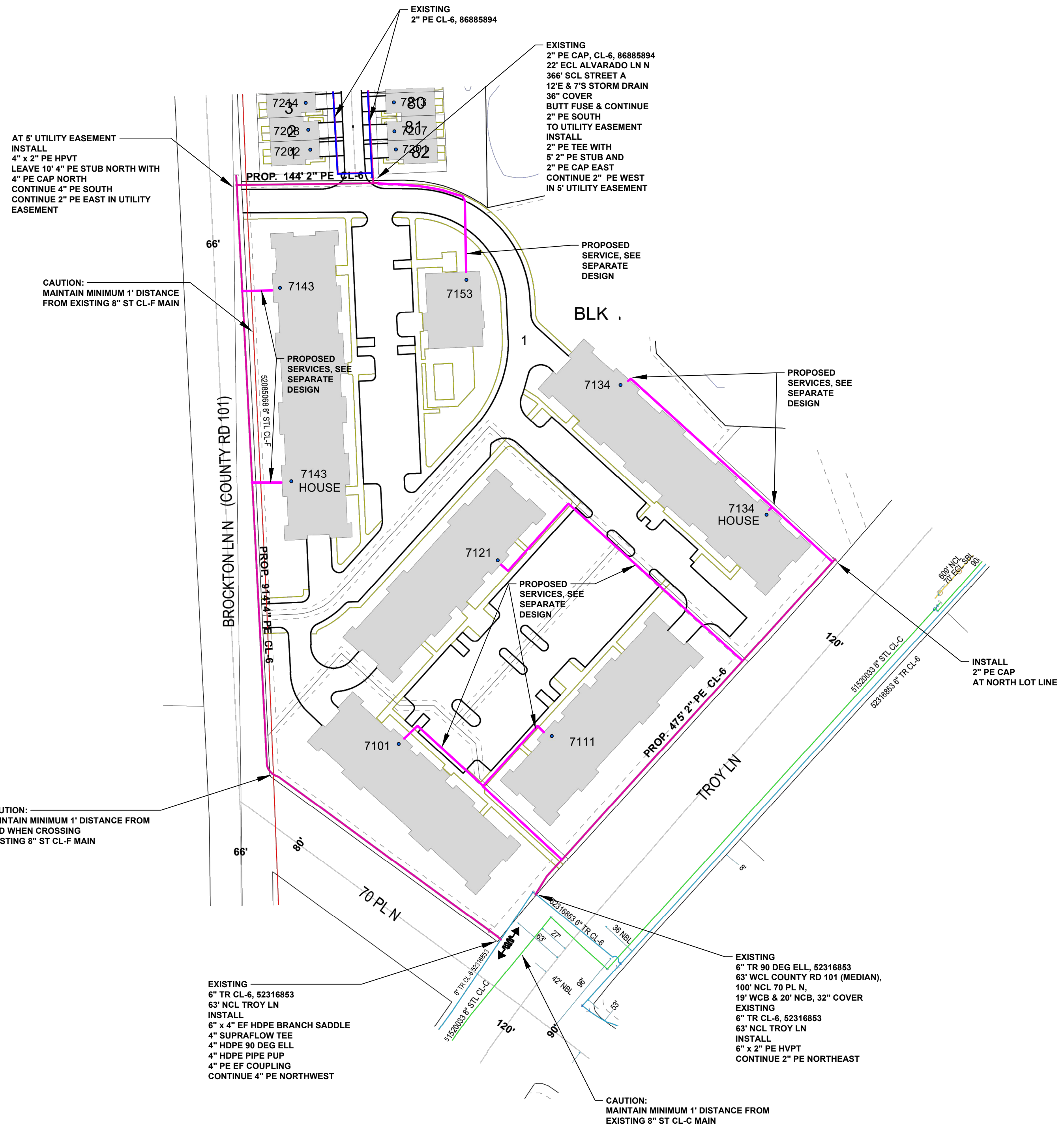

MINNESOTA REGION  
 PROPRIETARY AND CONFIDENTIAL  
 PROJECT #: **95696951**  
 M52900 MAPLE GROVE  
 ONE CALL:  
 Hennepin  
 \*SE25 T119/R23  
 \*SW30 T119/R22  
 \* = this Page

LEGEND:  
 ACTIVE MAIN  
 DESIGNED MAIN  
 PROPOSED ABANDONED/  
 OUT OF SERVICE MAIN  
 ABANDONED/  
 OUT OF SERVICE MAIN

PIPE REQUIRED:  
 630' 2" PE CL-6  
 924' 4" PE CL-6  
 1554' PIPE  
 PROPOSED ABANDONED PIPE:

COPIES:  
 PIPELINE INTEGRITY PACKET: N  
 STATION MANAGER: N  
 DD NUMBER: N  
 CORROSION: N  
 EMP: N  
 FOLLOW INTERNAL PIPE SAMPLING REQUIREMENTS? N  
 SURVEYOR REQUIRED? N  
 RETURN PACKET TO ENG? N  
 GFIP #: N/A  
 PERMITS:  
 MAPLE GROVE  
 HENNEPIN COUNTY

PERRY SCHMIDT  
 PROJECT DESCRIPTION: NBCCO  
 RUSH CREEK APTS  
 DESIGNER: Marcia Kolstad  
 PHONE #: 612-321-5482  
 DRAWN BY: Marcia Kolstad  
 DESIGN DATE: 10/9/2020

REVISION INFO:  
 Main  
 SS#  
 SCALE 1" = 80'  
 SHEET 1 OF 1