

Lanewood Ln

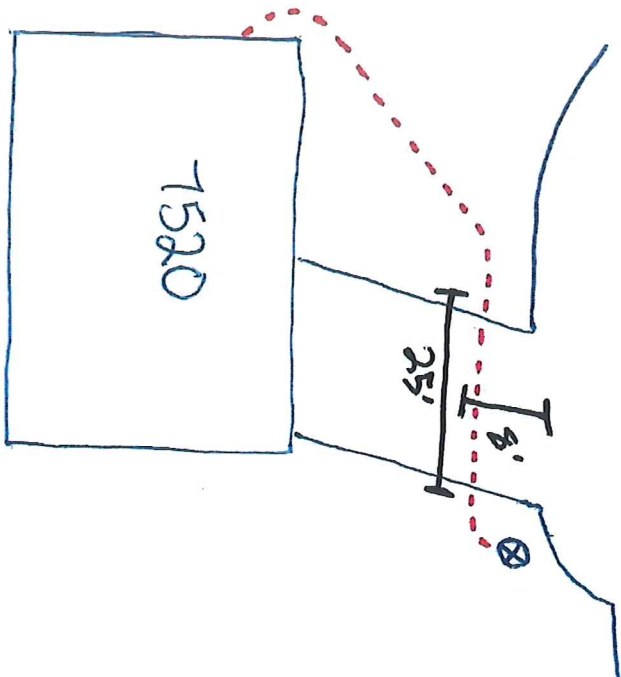

N ↑

~~1520~~ Lanewood Ln
M.G.

40' ROW Permit



Hennepin County Property Map

Date: 10/8/2020



PARCEL ID: 2811922210015

OWNER NAME: Brent P Marin

PARCEL ADDRESS: 7520 Lanewood La N,
Maple Grove MN 55311

PARCEL AREA: 0.3 acres, 13,150 sq ft

A-T-B: Torrens

SALE PRICE: \$255,000

SALE DATA: 09/2012

SALE CODE: Warranty Deed

ASSESSED 2019, PAYABLE 2020
PROPERTY TYPE: Residential
HOMESTEAD: Homestead
MARKET VALUE: \$307,500
TAX TOTAL: \$3,896.64

ASSESSED 2020, PAYABLE 2021
PROPERTY TYPE: Residential
HOMESTEAD: Homestead
MARKET VALUE: \$323,200

Comments:

This data (i) is furnished 'AS IS' with no representation as to completeness or accuracy; (ii) is furnished with no warranty of any kind; and (iii) is not suitable for legal, engineering or surveying purposes. Hennepin County shall not be liable for any damage, injury or loss resulting from this data.

COPYRIGHT © HENNEPIN
COUNTY 2020