

CenturyLink BSW Order/Maintenance Work Authorization

Company	Exchange Name	Service Order#	
Work Activity	Fiber-Buried	Capital	Y
Customer Name	Jeremy Johnson	Phone#	(763) 315-3741
Address	9787 103rd Pl N	One Call Ticket#	
City & Zip	Maple Grove Mn		
Location/Directions			
Description of Work or Special Instructions	Plow 150 ft of fiber from ped to nid. 87 ft right of way bore required		

Held Order	Y	N	Permit:	Y	N	Bore:	Y	N	CBR#	7634391423	
Tech Name and Tech #	Don Evans					Employee Contact#	6124303133				
Sketch <small>(Include Cntr Line & Pedestal)</small>	Material/Labor Units					Footage/Quantity	Comments				
	Description		Notes								
Cntr Line foot	SEB3-22				BSW-3 & plow plcmt						
	SEB3-22T				BSW-3 & hand dig plcmt						
Ped#	SEPCUTOVER				CUTOVER BSW	1					
Parish/County	BM83				BSW guard at house	1					
	XXSEB-GL				Remove temp drop	1	Footage when temp can't be re-used				
Township:	BM61(1.25)SEB				BSW Bore footage	87					
Section	SEBO PER FT LBR				Fiber & plow plcmt	38					
Range	SEBO PER FT LBR T				Fiber & hand dig plcmt						
	SEB6-22				BSW-6 & plow plcmt						
	BM2(5/8)(8)				Ground Rod						
	Trip Charge				Trip Charge	1					
	Permit				Permit	1	Any placement within the ROW requires a permit				
Nearest cross st.						Plat Page		Map#			

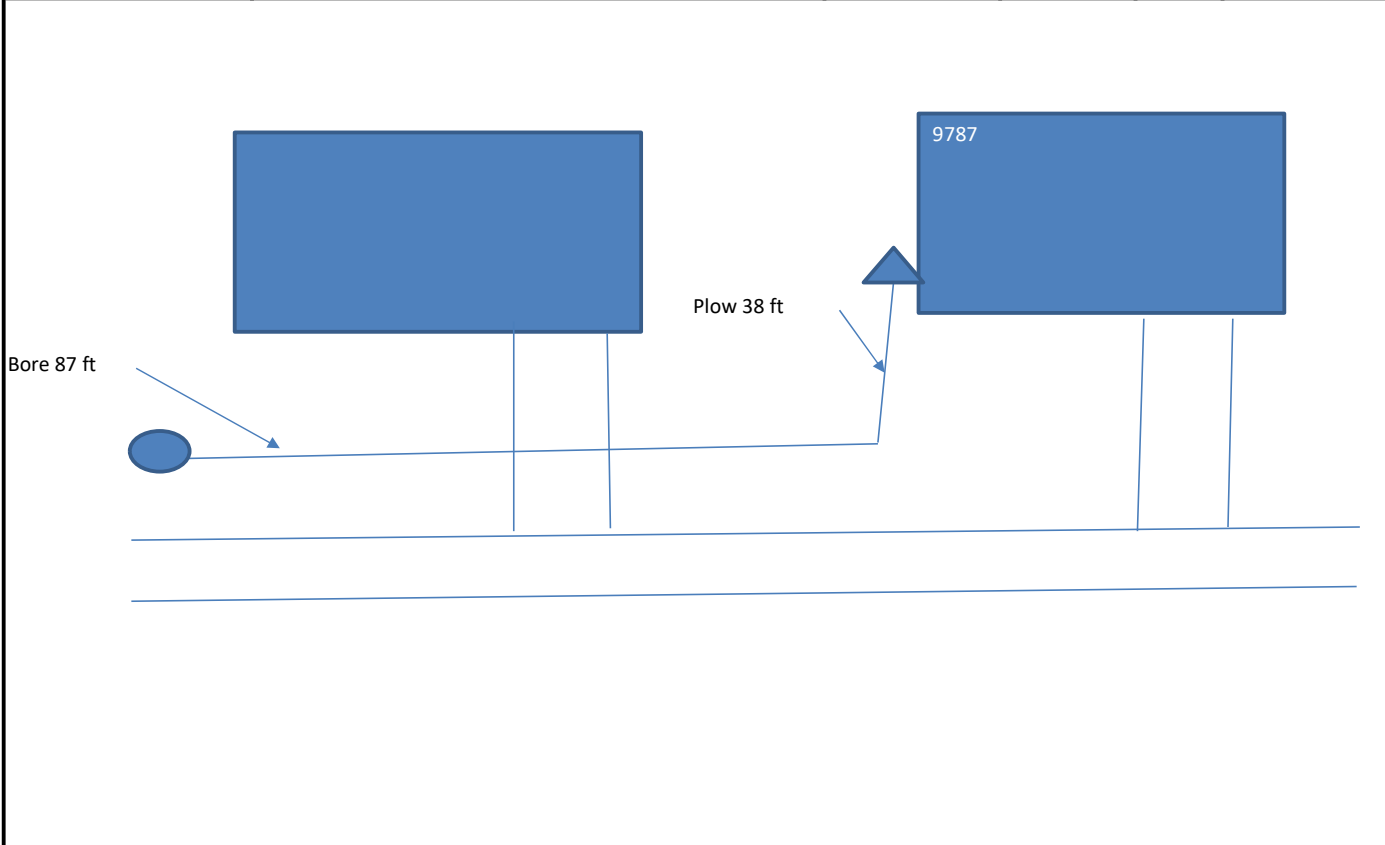

Originated By: Don Evans Date: 9/14/20 Completed By: _____ Date: _____
 Authorized By: (SRO) _____ Date: _____ Inspected By: _____ Date: _____
 Authorized By: (MRO) _____ Date: _____

Email sketch to:

1. Distance of the bury in Right-of-Way	3. Distance to the nearest intersection
2. Distance from the terminal to the centerline	4. Nearest State Hwy mile marker