

Revised 2-10-2020	State	MN	Contractor	MN Metro	CMS#	20164118 - HELD
CenturyLink BSW Order/Maintenance Work Authorization						
Company	Exchange Name				Service Order#	1575377837
Work Activity	Fiber-Buried	Capital	N	Maintenance	Y	
Customer Name	CENTURYLINK SIMPLEPAY			Phone#		
Address	7791 GARLAND LN N			One Call Ticket#		
City & Zip	MAPLE GROVE, MN 55311-2516					
Location/Directions	gps					
Description of Work or Special Instructions	see sketch for details					

Held Order	Y	Permit:	Y	Bore:	Y	CBR#	612-237-4432
Tech Name and Tech #	aa10109			Employee Contact#	7632288645		
Sketch (Include Cntr Line & Pedestal)	Material/Labor Units			Footage/Quantity	Comments		
	Description	Notes					
Cntr Line foot	SEB3-22	BSW-3 & plow plcmt					
	SEB3-22T	BSW-3 & hand dig plcmt					
Ped#	109556	SEPCUTOVER	CUTOVER BSW	1			
Parish/County		BM83	BSW guard at house				
		XXSEB-GL	Remove temp drop		Footage when temp can't be re-used		
Township:		BM61(1.25)SEB	BSW Bore footage	80			
Section		SEBO PER FT LBR	Fiber & plow plcmt	182			
Range		SEBO PER FT LBR T	Fiber & hand dig plcmt				
		SEB6-22	BSW-6 & plow plcmt				
		BM2(5/8)(8)	Ground Rod				
		Trip Charge	Trip Charge	1			
		Permit	Permit	1	Any placement within the ROW requires a permit		
Nearest cross st.	see sketch for cross street			Plat Page	Map#		

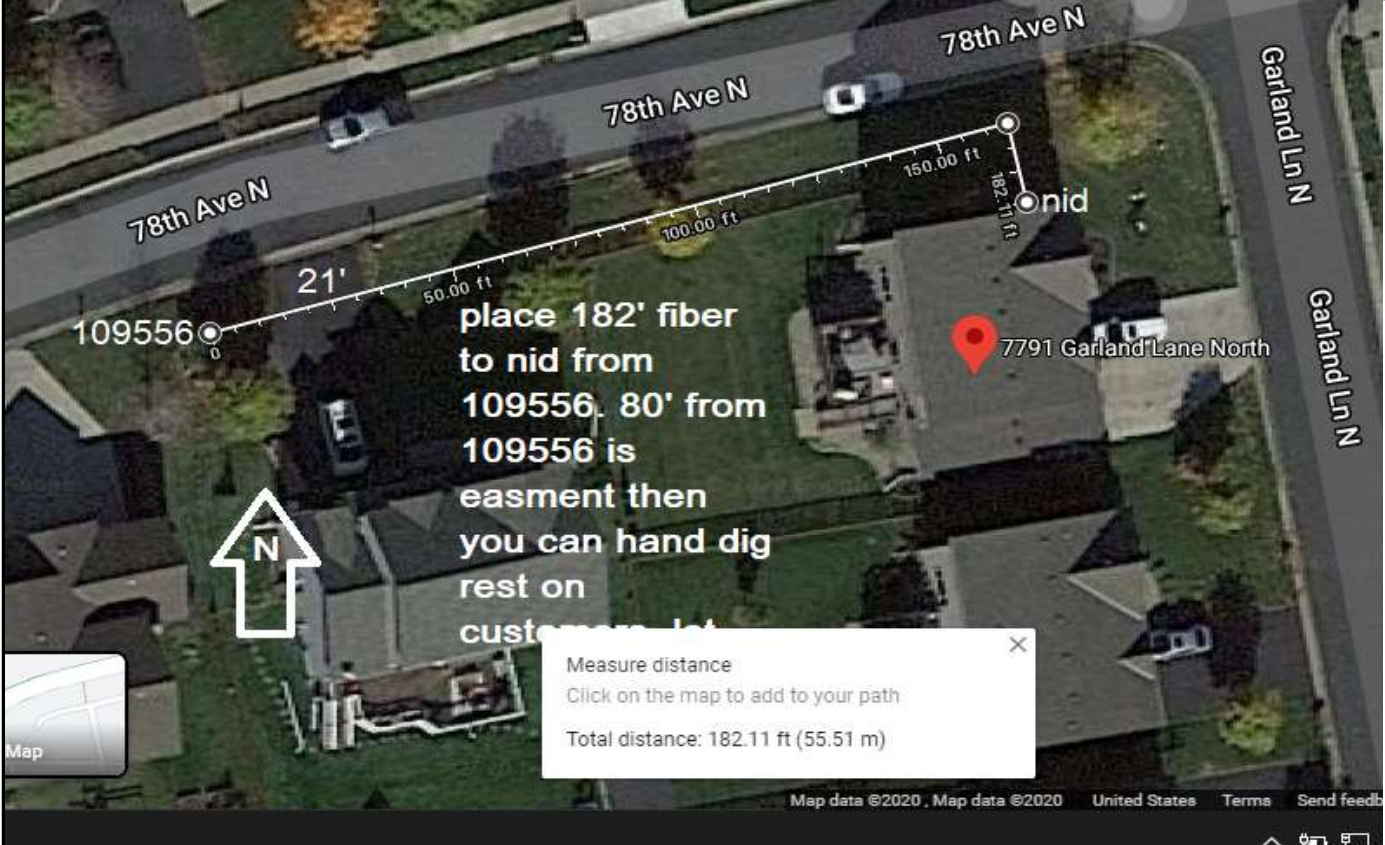

Originated By:	aa10109	Date:	9/15/20	Completed By:		Date:	
Authorized By: (SRO)		Date:		Inspected By:		Date:	
Authorized By: (MRO)		Date:					

Email sketch to:

1. Distance of the bury in Right-of-Way		3. Distance to the nearest intersection	
2. Distance from the terminal to the centerline		4. Nearest State Hwy mile marker	