

Hennepin County Property Map



Date: 8/25/2020



1 inch = 50 feet

PARCEL ID: 1911922130048

OWNER NAME: Brian B Hart & Eith R Hart

PARCEL ADDRESS: 17997 82nd Way N, Maple Grove MN 55311

PARCEL AREA: 0.29 acres, 12,475 sq ft

A-T-B: Abstract

SALE PRICE: \$385,000

SALE DATA: 04/2019

SALE CODE: Warranty Deed

ASSESSED 2019, PAYABLE 2020

PROPERTY TYPE: Residential

HOMESTEAD: Homestead

MARKET VALUE: \$363,700

TAX TOTAL: \$4,680.36

ASSESSED 2020, PAYABLE 2021

PROPERTY TYPE: Residential

HOMESTEAD: Homestead

MARKET VALUE: \$386,000

Comments:

This data (i) is furnished 'AS IS' with no

representation as to completeness or

accuracy; (ii) is furnished with no

warranty of any kind; and (iii) is not suitable

for legal, engineering or surveying purposes.

Hennepin County shall not be liable for any

damage, injury or loss resulting from this data.

COPYRIGHT © HENNEPIN

COUNTY 2020

17997 82ND way n
W.g.

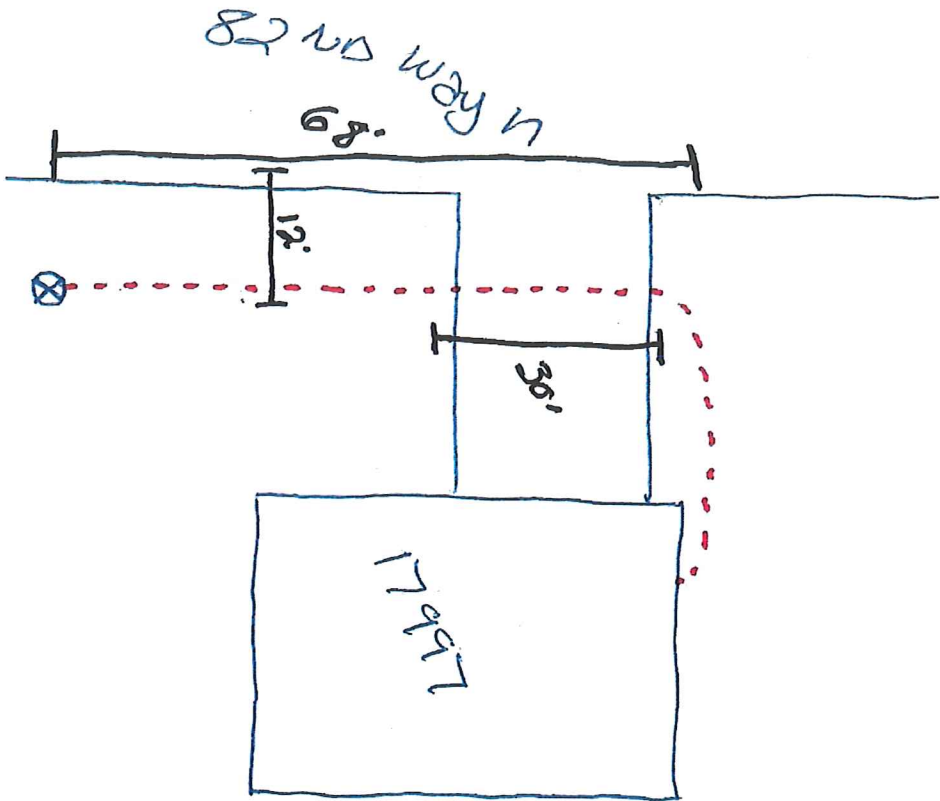

25f

68' in ROW - Permit req