

**CenturyLink BSW Order/Maintenance Work Authorization**

Company	Exchange Name PLMOMNFE	Service Order# T15905471
Work Activity Drop-Buried Copper	Capital N	Maintenance Y
Customer Name JOSHUA DOEBBERT	Phone# 763-559-2268	One Call Ticket#
Address 11397 RED FOX DR N	City & Zip MAPLE GROVE 55369	
Location/Directions		
Description of Work or Special Instructions BURY DROP ON GROUND		

Held Order	N	Permit: Y	Bore: Y	CBR# 320-760-7103
Tech Name and Tech # MIKE STOLTZ # 837	Employee Contact# 612-791-4689			

Sketch (Include Cntr Line & Pedestal)	Material/Labor Units		Footage/Quantity	Comments
	Description	Notes		
Cntr Line foot	SEB3-22	BSW-3 & plow plcmt	230	
	SEB3-22T	BSW-3 & hand dig plcmt	10	
Ped#	SEPCUTOVER	CUTOVER BSW	1	
Parish/County	BM83	BSW guard at house	1	
	XXSEB-GL	Remove temp drop	0	Footage when temp can't be re-used
Township:	BM61(1.25)SEB	BSW Bore footage	20	
Section	SEBO PER FT LBR	Fiber & plow plcmt	0	
Range	SEBO PER FT LBR T	Fiber & hand dig plcmt	0	
	SEB6-22	BSW-6 & plow plcmt	0	
	BM2(5/8)(8)	Ground Rod	0	
	Trip Charge	Trip Charge	0	
	Permit	Permit	1	Any placement within the ROW requires a permit
Nearest cross st.	RED FOX DR N & RED FOX DR N		Plat Page	Map#

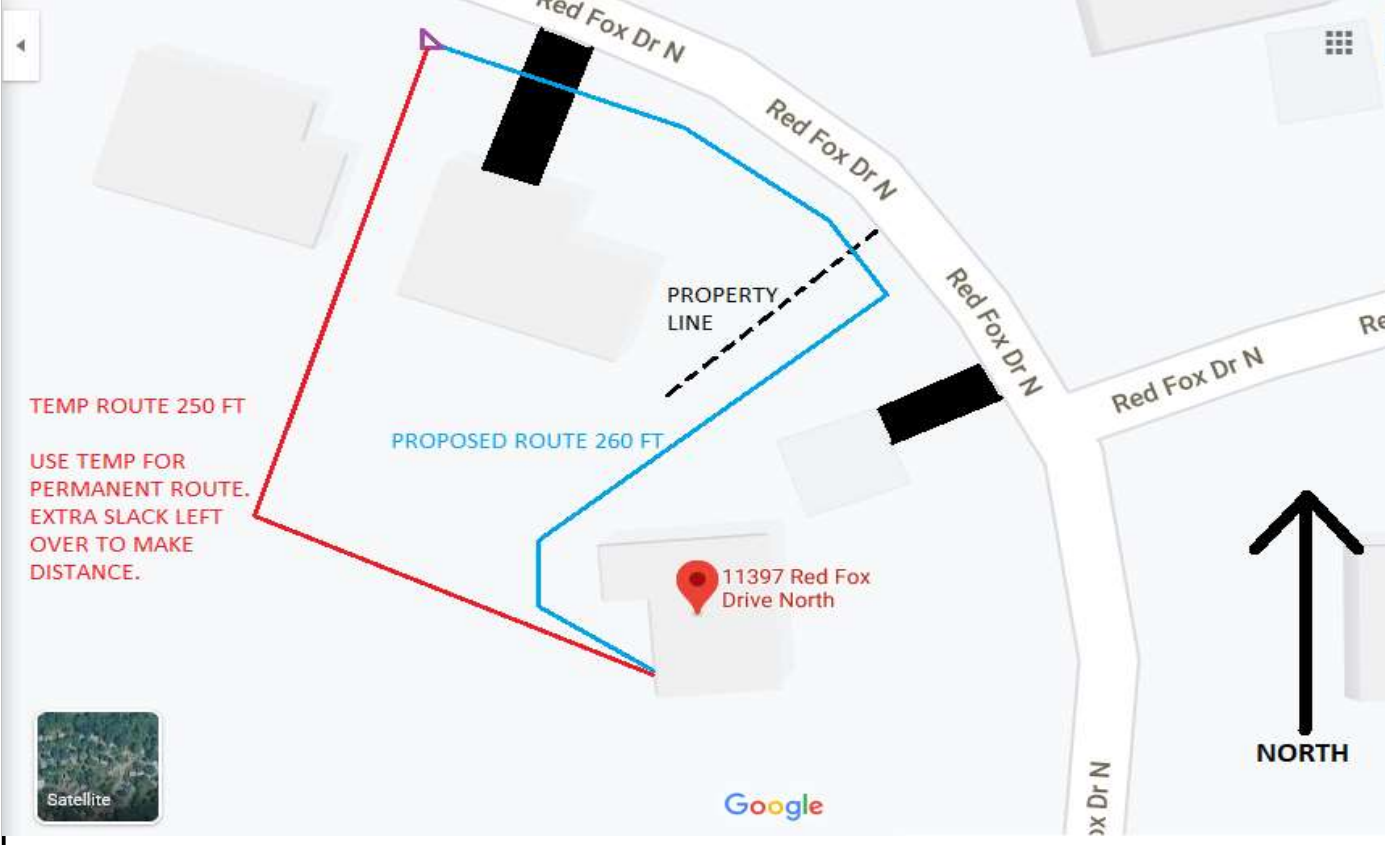

Originated By:	Mike Stoltz	Date:	5/19/20	Completed By:		Date:	
Authorized By: (SRO)	Jason DeRosa	Date:		Inspected By:		Date:	
Authorized By: (MRO)	Mike Winberg	Date:					

Email sketch to:

1. Distance of the bury in Right-of-Way	3. Distance to the nearest intersection
2. Distance from the terminal to the centerline	4. Nearest State Hwy mile marker