

Fast Path Cale Replacement
 15102 74th Ave N, Maple Grove
 Feeder. ECK062/A/7.97 kVA
 Related to W/O 104790978

F1-T03
 Bore in 450' of #2 AL 1P cable
 from xfmers F1 to T03.
 Term at each end (F1 and T03)
 Restore to current conditions.

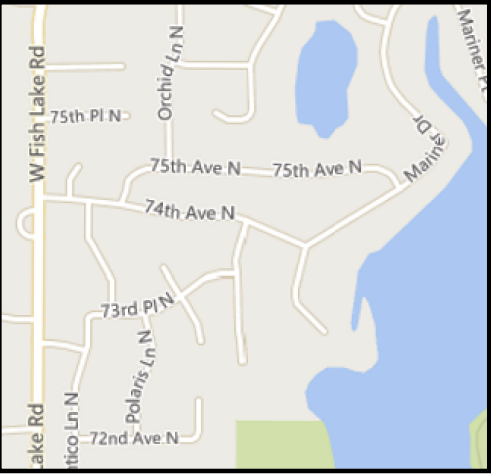

Alex Carlson
 O (651)-229-2512
 C (218)-591-5080

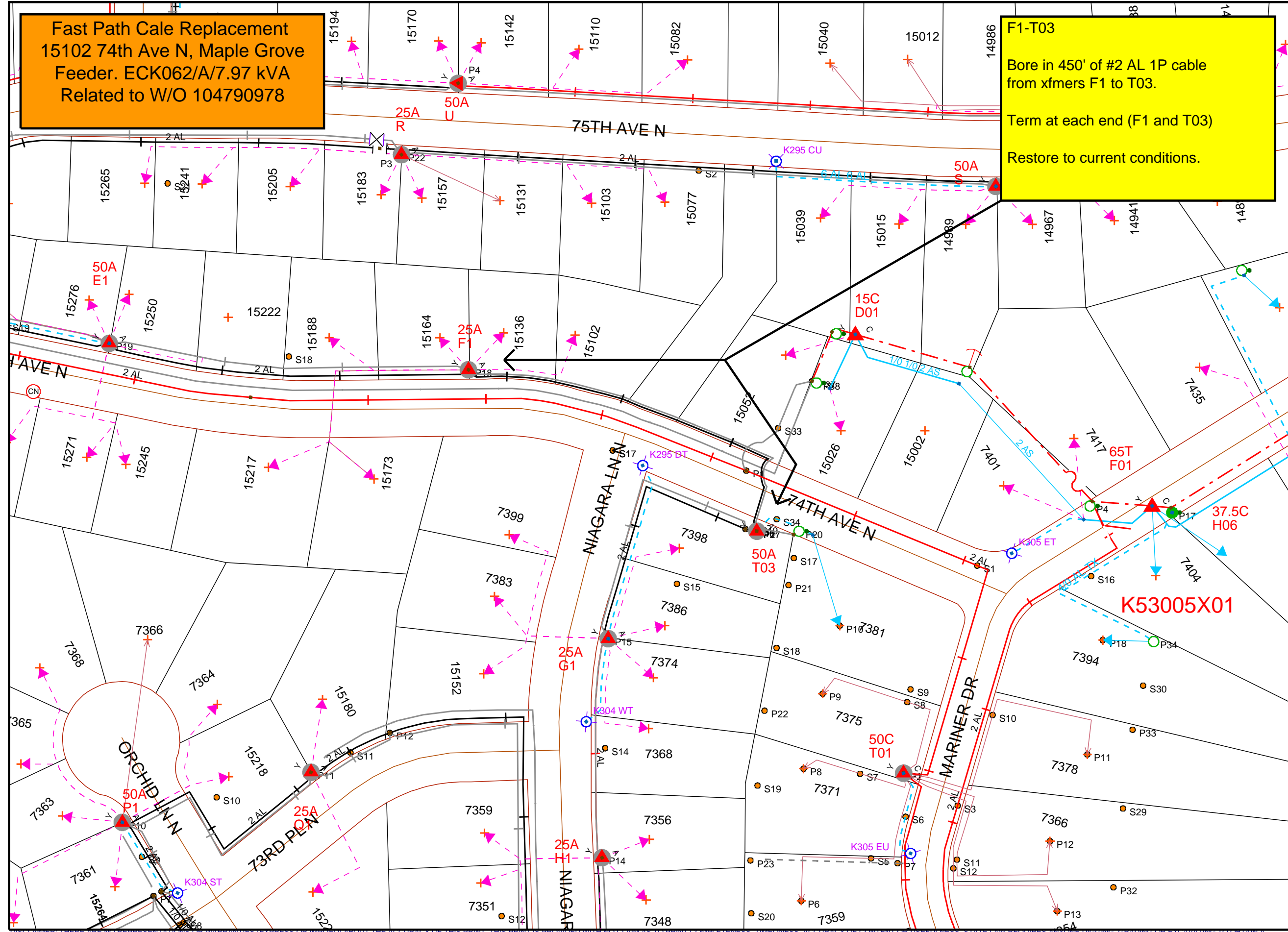

Work Order Information	
Service Request #	:
Design Number	: 00000954425
Designer/Planner ID	: 217029
Designer/Planner Name	: Carlson, Alex
Designer/Planner Ph #	: (651) 229-2512
Manager Approval	:

Joint Utility	
E:	G:
T:	C:

Design Location	
Division	: White Bear Lake
County	: Hennepin
City	: Maple Grove
Address	: 15102 74th Ave N
T: 119N	R: 22W S: 28
Map #	: K52095
Permit	:

Electric	
Feeder	: See Notes
Voltage	: See Notes
Phase	: See Notes
Bkup Dev ID	:

Gas	
System	: Pressure :
Size	: Material :
Dead End	:

Work Order # :
 Date: 07/08/2020
 Sketch: # Of # Sketch Data
 Scale: 1" equals 100'

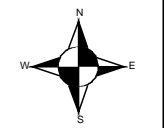

CONSTRUCTION USE ONLY

NO CHANGES (BUILT AS DESIGNED)
 CHANGES MADE AS INDICATED
 (ALL URD MUST HAVE ACTUAL MEASUREMENTS FROM THE FIELD SITE)

RFO _____
 FOREMAN _____ DATE _____
 TEAM LEADER _____

DISCLAIMER: THERE ARE NO REPRESENTATIONS OR WARRANTIES (EXPRESS OR IMPLIED) ABOUT THE ACCURACY OF THIS PRINT. THIS PRINT IS PROVIDED WITH NO CLAIM AS TO PRINT COMPLETENESS, TIMELINESS, ACCURACY OF CONTENT OR USEFULNESS. STATE LAW REQUIRES ANYONE DIGGING, GRADING OR EXCAVATING TO OBTAIN A PRIOR FIELD LOCATE OF ALL UTILITIES. THIS PRINT DOES NOT DISCHARGE THIS REQUIREMENT OR ANY OTHER REQUIREMENT. THE COMPANY AND ITS AFFILIATES ASSUME NO LEGAL RESPONSIBILITY OR LIABILITY FOR THE RECIPIENT'S USE (OR ANY OTHER PARTIES' USE) OF THE PRINT, INCLUDING THE RECIPIENT'S INTENDED PURPOSE IN USING THE PRINT. NO COMPANY EMPLOYEE OR OTHER PARTY HAS BEEN AUTHORIZED TO PROVIDE THIS PRINT FOR PLANNING OR ESTIMATING PURPOSES; RELY ON THIS PRINT AT YOUR OWN RISK. BY ACCEPTING THIS PRINT, THE RECIPIENT OR ANY OTHER PARTY RECEIVING A COPY OF THE PRINT ACKNOWLEDGES AND AGREES TO THIS DISCLAIMER. For All Field Locates Call 811

THIS DOCUMENT IS XCEL ENERGY CONFIDENTIALS AND PROPRIETARY INFORMATION AND MAY NOT BE REPRODUCED IN WHOLE, OR IN PART, NOR MAY ANY OF THE INFORMATION CONTAINED HEREIN BE DISCLOSED WITHOUT THE CONSENT OF XCEL ENERGY. CONFIDENTIALS AND PROPRIETARY INFORMATION © 2019 XCEL ENERGY INC. | XCEL ENERGY IS REGISTERED TRADEMARK OF XCEL ENERGY INC