

ONE CALL:
Hennepin
*SE32 T119/R22
*SW33 T119/R22
* = this Page

LEGEND:
— ACTIVE MAIN
— DESIGNED MAIN
— PROPOSED ABANDONED/
— OUT OF SERVICE MAIN
— ABANDONED/
— OUT OF SERVICE MAIN

PIPE REQUIRED:
946' 6" PE CL-6
946' PIPE

PROPOSED ABANDONED PIPE:
903' 6" TR CL-6
903' PIPE

COPIES:
PIPELINE INTEGRITY PACKET: N
STATION MANAGER: N
DD NUMBER: N/A
CORROSION: N/A
EMP: N

FOLLOW INTERNAL PIPE SAMPLING REQUIREMENTS? N
SURVEYOR REQUIRED? N
RETURN PACKET TO ENG? N
GFIP #: N/A
PERMITS:
- CITY OF MAPLE GROVE

PROJECT DESCRIPTION: SREL
Vicksburg Ln N

DESIGNER: Amir Fazlovic
PHONE #: 612-321-5086
DRAWN BY: Amir Fazlovic
DESIGN DATE: 6/18/2020

REVISION INFO:

Main
SS#

SCALE 1" = 50'
SHEET 1 OF 1

CONSTRUCTION NOTES

Obtain Construction Plans from Designer prior to starting job.
Coordinate with Contractor / Engineering Firm for exact locations of proposed structures and facilities prior to installation of gas facilities.
Install new main as shown or as directed in field at time of installation.
Long side mains and services to be installed below proposed sub-cuts (See Construction Plans).
All test points should be installed in the boulevard or other acceptable locations and avoid placement in driving lanes.
Verify Coating test results if required prior to abandoning main.

ABANDONMENT PROCEDURES

See Construction Procedures for installation of mains and services prior to abandonments.
Cut and Abandon existing main as shown. Purge abandoned mains until essentially 0% gas reading is obtained on Combustible Gas Indicator. See CenterPoint Energy Construction and Service Manual Section CS-B-1.110 and Section CS-B-1.230 for purging mains out of service using air movers.
Contact Engineering with questions.

CONSTRUCTION PROCEDURES

Install, Clean and Test, and Put in Service; Proposed new main per CenterPoint Energy Construction and Services Manual.
Procedure for tapping or making tie-ins to existing gas mains: Verify existing gas main size, type, and location prior to tapping or making tie-in. Monitor and verify, using a pressure gauge, existing gas main Pressure Class within the bell hole of tap location or tie-in location prior to tapping or making tie-in.
Purge new main until essentially 100% reading is obtained on Combustible Gas Indicator. See CenterPoint Energy Construction and Service Manual Section CS-B-1.230 for purging mains into service.
Complete all Service / Meter Work as directed. (See Service Survey)
See Abandonment Procedures for abandonment and purging procedures.
Install a marker ball at a new end of main, at a valve, at each ell of a horizontal offset, at road crossings and at any fitting or pressure control identified as needing to be located in the future. Refer to CenterPoint Energy Construction and Service Manual section CS-B-1.310 for installation procedures.

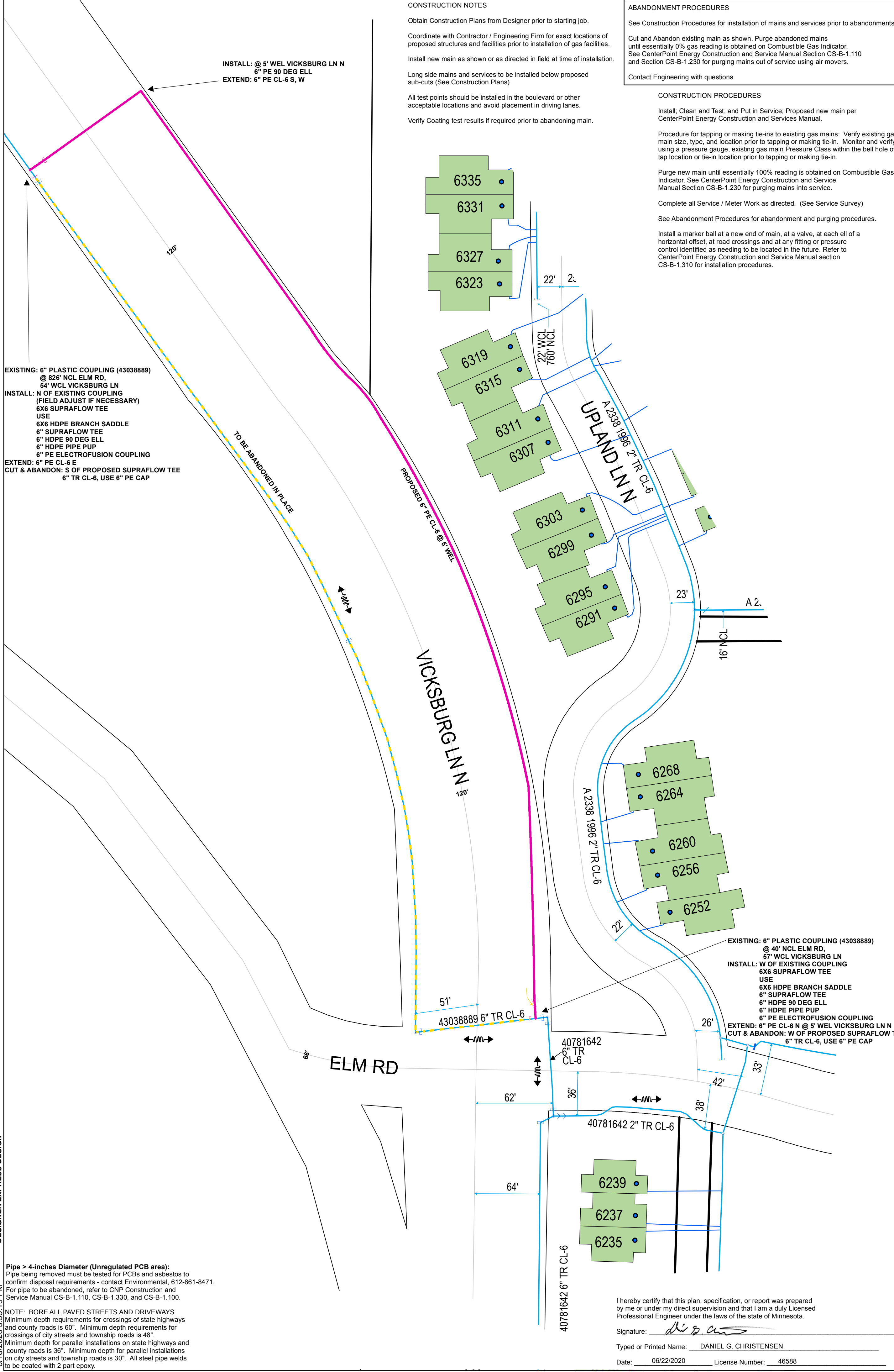

EXISTING: 6" PLASTIC COUPLING (43038889)
@ 826' NCL ELM RD,
54' WCL VICKSBURG LN
INSTALL: N OF EXISTING COUPLING
(FIELD ADJUST IF NECESSARY)
6X6 SUPRAFLOW TEE
USE
6X6 HDPE BRANCH SADDLE
6" SUPRAFLOW TEE
6" HDPE 90 DEG ELL
6" HDPE PIPE PUP
6" PE ELECTROFUSION COUPLING
EXTEND: 6" PE CL-6 E
CUT & ABANDON: S OF PROPOSED SUPRAFLOW TEE
6" TR CL-6, USE 6" PE CAP

EXISTING: 6" PLASTIC COUPLING (43038889)
@ 40' NCL ELM RD,
57' WCL VICKSBURG LN
INSTALL: W OF EXISTING COUPLING
6X6 SUPRAFLOW TEE
USE
6X6 HDPE BRANCH SADDLE
6" SUPRAFLOW TEE
6" HDPE 90 DEG ELL
6" HDPE PIPE PUP
6" PE ELECTROFUSION COUPLING
EXTEND: 6" PE CL-6 N @ 5' WCL VICKSBURG LN N
CUT & ABANDON: W OF PROPOSED SUPRAFLOW TEE
6" TR CL-6, USE 6" PE CAP

I hereby certify that this plan, specification, or report was prepared by me or under my direct supervision and that I am a duly Licensed Professional Engineer under the laws of the state of Minnesota.
Signature: *[Signature]*
Typed or Printed Name: DANIEL G. CHRISTENSEN
Date: 06/22/2020 License Number: 46588

DESIGNER EXPRESS DESIGN
6/18/2020 3:55:19 PM

Pipe > 4-inches Diameter (Unregulated PCB area):
Pipe being removed must be tested for PCBs and asbestos to confirm disposal requirements - contact Environmental, 612-861-8471.
For pipe to be abandoned, refer to CNP Construction and Service Manual CS-B-1.110, CS-B-1.330, and CS-B-1.100.
NOTE: BORE ALL PAVED STREETS AND DRIVEWAYS
Minimum depth requirements for crossings of state highways and county roads is 60". Minimum depth requirements for crossings of city streets and township roads is 48".
Minimum depth for parallel installations on state highways and county roads is 36". Minimum depth for parallel installations on city streets and township roads is 30". All steel pipe welds to be coated with 2 part epoxy.