

Escalated Cable Replacement
7486 Quantico Ln, Maple Grove

Feeder. ECK062/B/7.97Kva

Directional Bore. Bore in 2700' of #2 AL 1Ph cable from
D5 to E5, E5 to F5, F5 to G5, D1 to L1, L1 to K1

Terminations. 10 terminations @ D5, E5, F5, G5, D1, L1, K1
replace xfmers and basement @ D5, E5, F5, G5, K1
Replace basement on @ D1

Restorations.

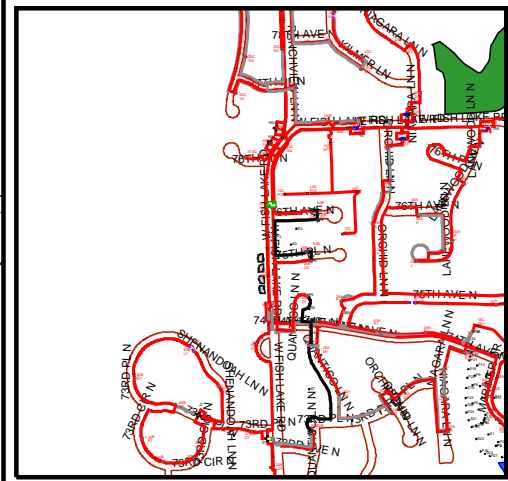
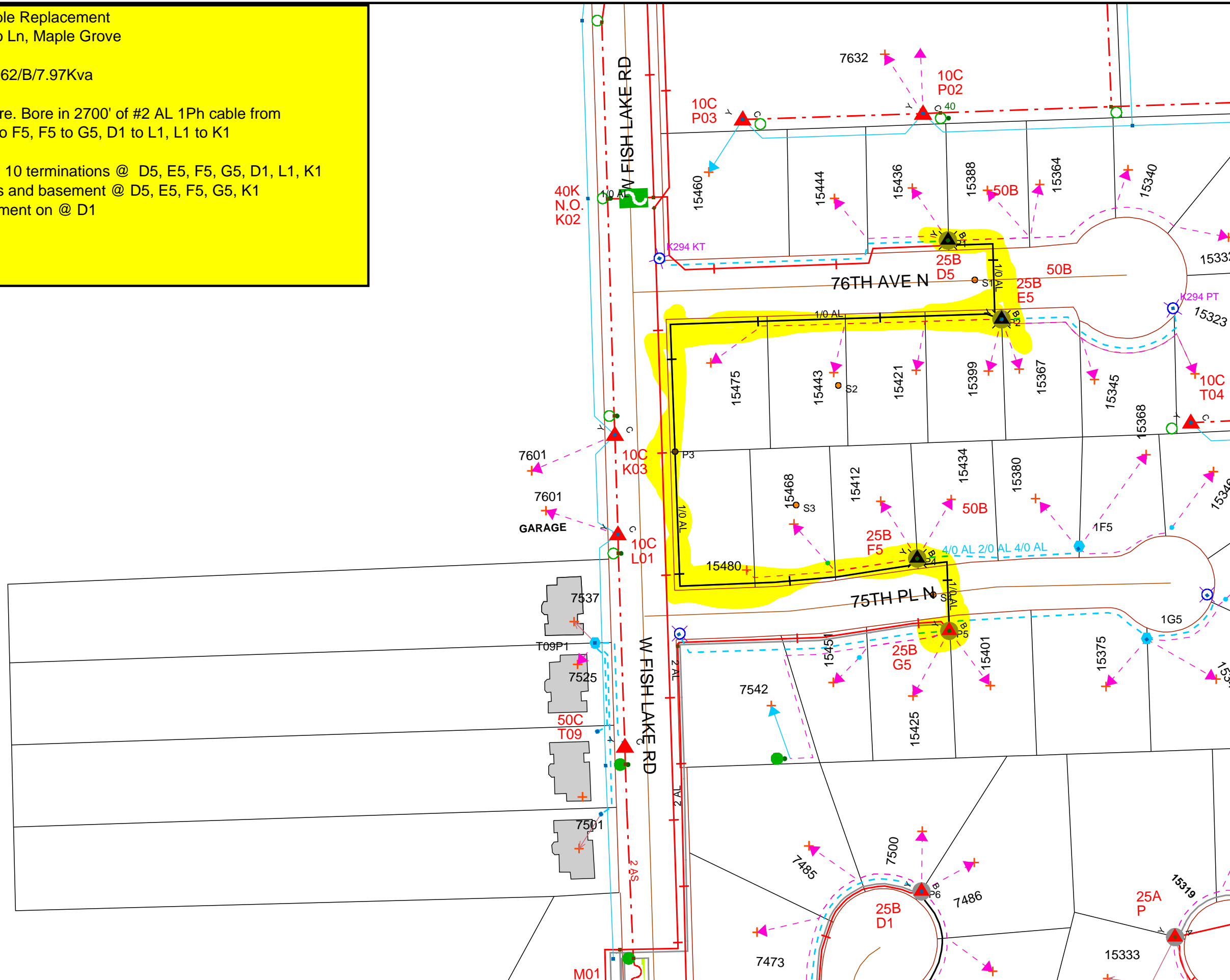

Brad Lynam
O (651)-229-5517

Work Order Information	
Service Request #	:
Design Number	: 000000771655
Designer/Planner ID	: 233210
Designer/Planner Name	: Brad Lynam
Designer/Planner Ph #	: (651) 229-5571
Manager Approval	:

Joint Utility	
E:	G:
T:	C:

Design Location	
Division	: Maple Grove
County	: Hennepin
City	: Maple Grove
Address	: 7486 Quantico Ln
T:	119N R: 22W S: 28
Map #	: K52094 Permit :

Electric	
Feeder	: See Notes Voltage: See Notes
Phase	: See Notes Bkup Dev ID:

Gas	
System	: Pressure :
Size	: Material :
Dead End	:

Work Order # :

Date: 04/26/2018

Sketch: # Of# Sketch Data

Scale: 1" equals 100'

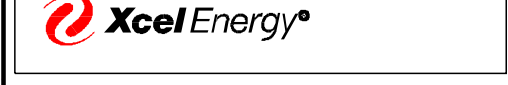
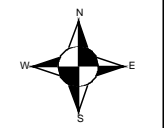

CONSTRUCTION USE ONLY

- NO CHANGES (BUILT AS DESIGNED)
- CHANGES MADE AS INDICATED (ALL URD MUST HAVE ACTUAL MEASUREMENTS FROM THE FIELD SITE)

RFO _____

FOREMAN _____ DATE _____

TEAM LEADER _____

DISCLAIMER: THERE ARE NO REPRESENTATIONS OR WARRANTIES (EXPRESS OR IMPLIED) ABOUT THE ACCURACY OF THIS PRINT. THIS PRINT IS PROVIDED WITH NO CLAIM AS TO PRINT COMPLETENESS, TIMELINESS, ACCURACY OF CONTENT OR USEFULNESS. STATE LAW REQUIRES ANYONE DIGGING, GRADING OR EXCAVATING TO OBTAIN A PRIOR FIELD LOCATE OF ALL UTILITIES; THIS PRINT DOES NOT DISCHARGE THIS REQUIREMENT OR ANY OTHER REQUIREMENT. THE COMPANY AND ITS AFFILIATES ASSUME NO LEGAL RESPONSIBILITY OR LIABILITY FOR THE RECIPIENT'S USE (OR ANY OTHER PARTIES' USE) OF THE PRINT, INCLUDING THE RECIPIENT'S INTENDED PURPOSE IN USING THE PRINT. NO COMPANY EMPLOYEE OR OTHER PARTY HAS BEEN AUTHORIZED TO PROVIDE THIS PRINT FOR PLANNING OR ESTIMATING PURPOSES; RELY ON THIS PRINT AT YOUR OWN RISK. BY ACCEPTING THIS PRINT, THE RECIPIENT & ANY OTHER PARTY RECEIVING A COPY OF THE PRINT ACKNOWLEDGES AND AGREES TO THIS DISCLAIMER. For All Field Locates Call 811

Escalated Cable Replacement
7486 Quantico Ln, Maple Grove

Feeder. ECK062/B/7.97Kva

Directional Bore. Bore in 2700' of #2 AL 1Ph cable from D5 to E5, E5 to F5, F5 to G5, D1 to L1, L1 to K1

Terminations. 10 terminations @ D5, E5, F5, G5, D1, L1, K1
replace xfmers and basement @ D5, E5, F5, G5, K1
Replace basement on @ D1

Restorations.

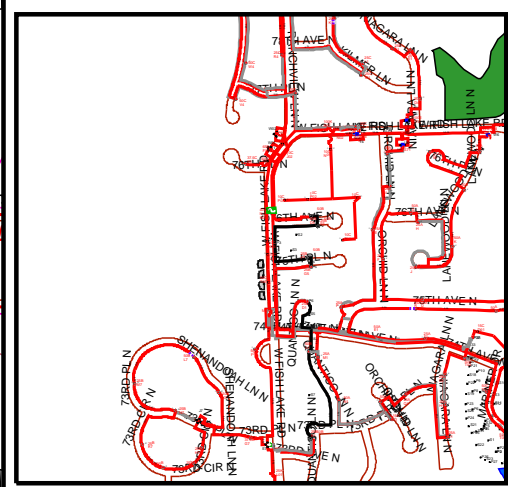
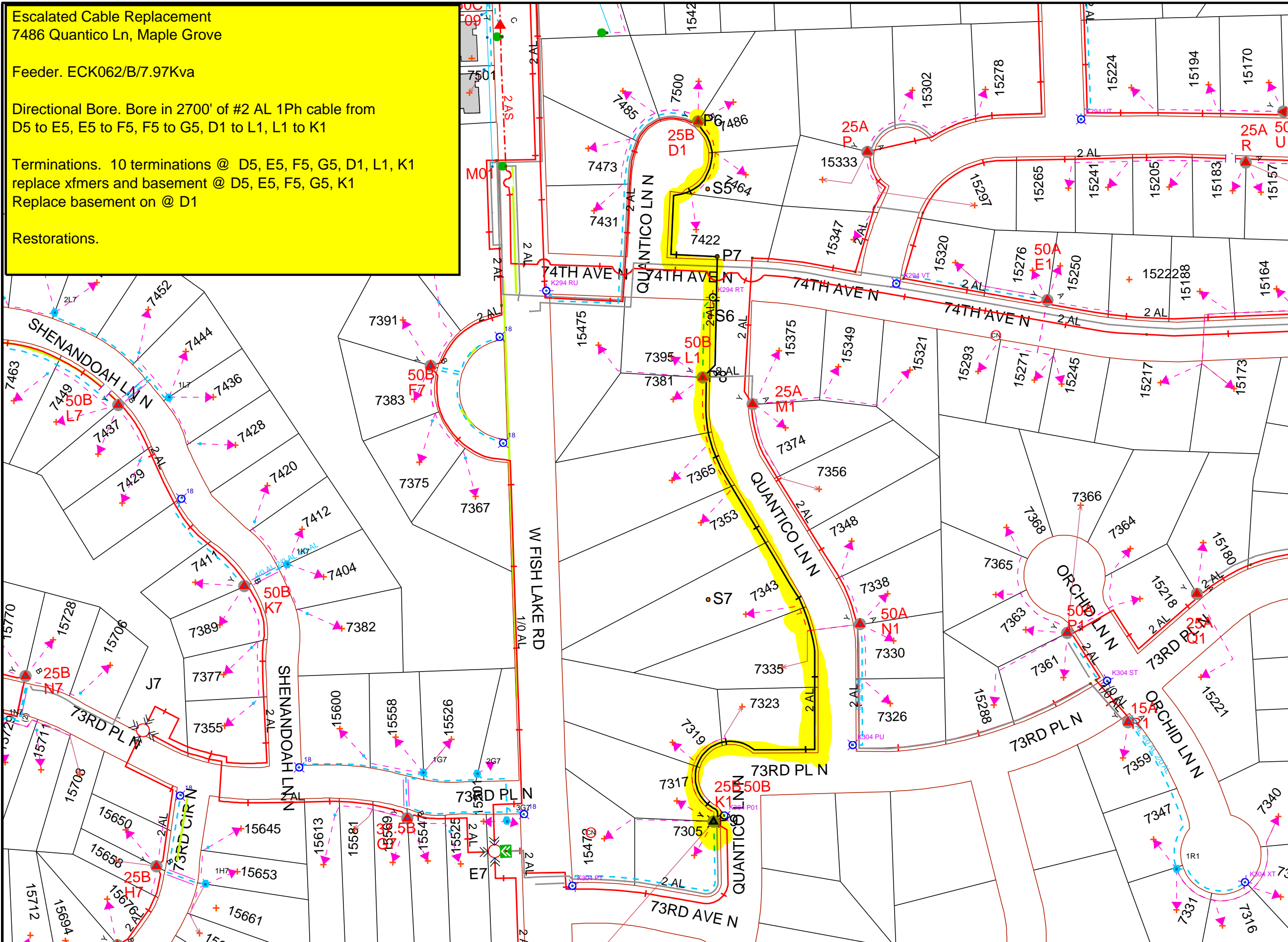

Brad Lynam
O (651)-229-5517

Work Order Information	
Service Request #	:
Design Number	: 000000771655
Designer/Planner ID	: 233210
Designer/Planner Name	: Brad Lynam
Designer/Planner Ph #	: (651) 229-5571
Manager Approval	:

Joint Utility	
E:	G:
T:	C:

Design Location	
Division	: Maple Grove
County	: Hennepin
City	: Maple Grove
Address	: 7486 Quantico Ln
T: 119N	R: 22W S: 28
Map #	: K52094
Permit	:

Electric	
Feeder	: See Notes
Voltage	: See Notes
Phase	: See Notes
Bkup Dev ID	:

Gas	
System	: Pressure :
Size	: Material :
Dead End	:

Work Order # :
Date: 04/26/2018
Sketch: # Of # Sketch Data
Scale: 1" equals 144'



CONSTRUCTION USE ONLY

NO CHANGES (BUILT AS DESIGNED)
 CHANGES MADE AS INDICATED (ALL URD MUST HAVE ACTUAL MEASUREMENTS FROM THE FIELD SITE)

RFO
FOREMAN _____ DATE _____
TEAM LEADER _____

DISCLAIMER: THERE ARE NO REPRESENTATIONS OR WARRANTIES (EXPRESS OR IMPLIED) ABOUT THE ACCURACY OF THIS PRINT. THIS PRINT IS PROVIDED WITH NO CLAIM AS TO PRINT COMPLETENESS, TIMELINESS, ACCURACY OF CONTENT OR USEFULNESS. STATE LAW REQUIRES ANYONE DIGGING, GRADING OR EXCAVATING TO OBTAIN A PRIOR FIELD LOCATE OF ALL UTILITIES; THIS PRINT DOES NOT DISCHARGE THIS REQUIREMENT OR ANY OTHER REQUIREMENT. THE COMPANY AND ITS AFFILIATES ASSUME NO LEGAL RESPONSIBILITY OR LIABILITY FOR THE RECIPIENT'S USE (OR ANY OTHER PARTIES' USE) OF THE PRINT, INCLUDING THE RECIPIENT'S INTENDED PURPOSE IN USING THE PRINT. NO COMPANY EMPLOYEE OR OTHER PARTY HAS BEEN AUTHORIZED TO PROVIDE THIS PRINT FOR PLANNING OR ESTIMATING PURPOSES; RELY ON THIS PRINT AT YOUR OWN RISK. BY ACCEPTING THIS PRINT, THE RECIPIENT & ANY OTHER PARTY RECEIVING A COPY OF THE PRINT ACKNOWLEDGES AND AGREES TO THIS DISCLAIMER. For All Field Locates Call 811