

DEMOLITION LEGEND

- REMOVE AND DISPOSE OF EXISTING BITUMINOUS PAVEMENT SECTION
- REMOVE AND DISPOSE OF EXISTING CONCRETE PAVEMENT SECTION

DEMOLITION NOTES

- Locate and verify all existing utility locations.
- It is the responsibility of the Contractor to perform or coordinate all necessary utility demotions and relocations. These may include, but are not limited to, water, sanitary sewer, cable tv, telephone, gas, electric, site lighting, irrigation, etc.
- Prior to beginning work, contact Gopher State Onecall (651-454-0002) to locate utilities throughout the area under construction. The Contractor shall retain the services of a private utility locator to locate the private utilities.
- Sawcut along edges of pavements, sidewalks, and curbs to remain.
- All construction shall be performed in accordance with state and local standard specifications for construction. Restoration within the Right-of-Way shall adhere to all applicable City of Maple Grove standards.

FILTER AREA	6.5 FT ²
OVERFLOW AREA	0.6 FT ²
MAXIMUM OVERFLOW RATE (@ 7" HEAD)	3.00 CF5
MAXIMUM OVERFLOW RATE (@ 13" HEAD)	4.00 CF5
BASKET WEIGHT (EMPTY)	1 LB
BASKET WEIGHT (FULL-APPROX.)	70 LBS

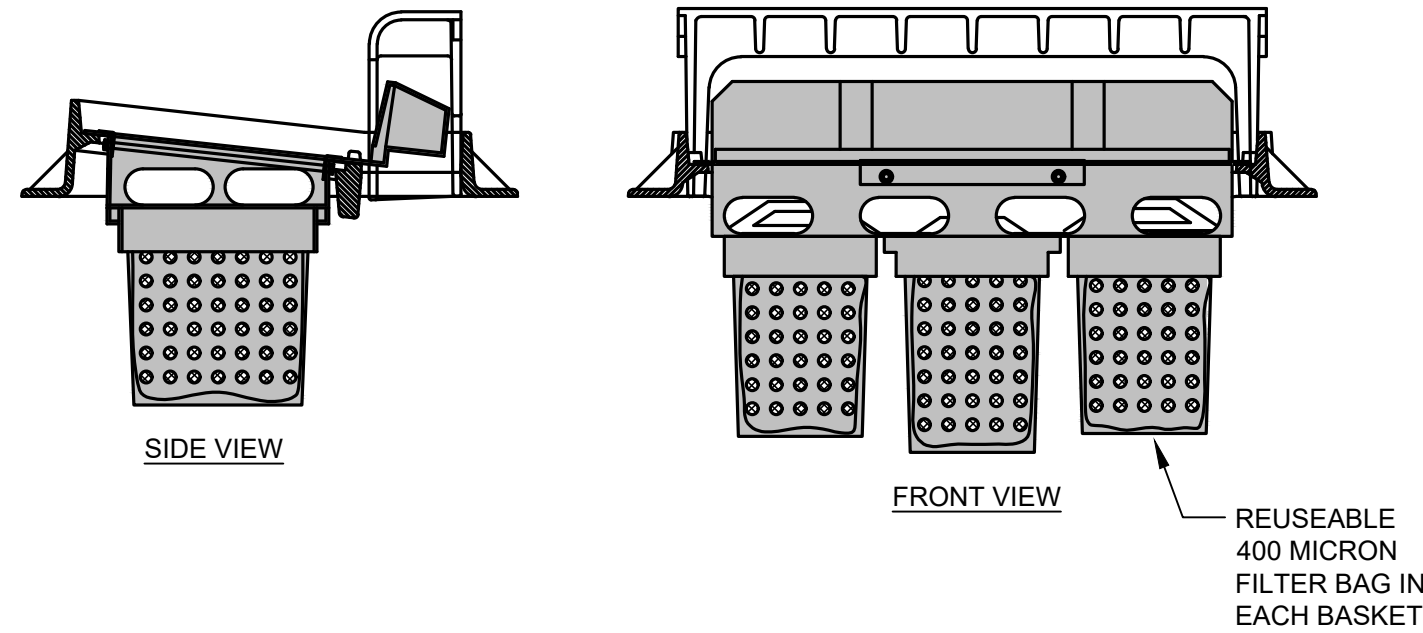

INFRSAFE INLET PROTECTION DEVICE (OR EQUAL)

1 C105 NOT TO SCALE

DEMOLITION KEY NOTES

- REMOVE AND DISPOSE OF EXISTING CONCRETE CURB.
- REMOVE AND DISPOSE OF EXISTING CONCRETE PAVEMENT.
- REMOVE AND DISPOSE OF EXISTING BITUMINOUS PAVEMENT.
- REMOVE AND SALVAGE EXISTING SIGN FOR REINSTALLATION AND DISPOSE OF POST.
- REMOVE EXISTING PAVEMENT STRIPING (GRIND OR SODA BLAST).
- REMOVE AND DISPOSE OF EXISTING STORM SEWER STRUCTURE AND ADJACENT PAVEMENT AS NEEDED.
- REMOVE AND DISPOSE OF EXISTING STORM SEWER PIPE.

UTILITY NOTES

- It is the responsibility of the contractor to perform or coordinate all necessary utility connections and relocations from existing utility locations to the proposed building, as well as to all onsite amenities. These connections include but are not limited to water, sanitary sewer, cable TV, telephone, gas, electric, site lighting, etc.
- All service connections shall be performed in accordance with state and local standard specifications for construction. Utility connections (sanitary sewer, watermain, and storm sewer) may require a permit from the City.
- The contractor shall verify the elevations at proposed connections to existing utilities prior to any demolition or excavation.
- The contractor shall notify all appropriate engineering departments and utility companies 72 hours prior to construction. All necessary precautions shall be made to avoid damage to existing utilities.
- Storm sewer requires testing in accordance with Minnesota plumbing code 4714.1109 where located within 10 feet of waterlines or the building.
- HDPE storm sewer piping shall meet ASTM F2306 and fittings shall meet ASTM D3212 joint pressure test. Installation shall meet ASTM C2321.
- See Project Specifications for bedding requirements.
- A structure adjustment shall include removing and salvaging the existing casting assembly, removing existing concrete rings to the precast section. Install new rings and salvaged casting to proposed grades, cleaning casting flange by mechanical means to insure a sound surface and install an external chimney seal from casting to precast section. Chimney seals shall be Infi-Shield Uni-Band or an approved equal.

SYMBOL LEGEND

- NEW 6" CONCRETE PAVEMENT OVER NEW 6" AGGREGATE BASE SEE DETAIL 7A/C200
- NEW 8" CONCRETE PAVEMENT OVER NEW 6" AGGREGATE BASE SEE DETAIL 7B/C200
- NEW 5" BITUMINOUS PAVEMENT OVER NEW 10" AGGREGATE BASE SEE DETAIL 5/C200
- CURB PAINT
- STORM SEWER PIPE
- CURB INLET
- SPOT ABBREVIATIONS:
PROPOSED ELEVATION
EXISTING ELEVATION
GRADE SLOPE
B - BITUMINOUS
GL - GUTTER LINE
TC - TOP OF CURB
(*) - EXISTING TO BE VERIFIED

STRIPING NOTES

- RESTRIPE ALL PAVEMENT MARKINGS DISTURBED DURING CONSTRUCTION INCLUDING NEW & EXISTING BITUMINOUS, CONCRETE, CURB, BOLLARDS, ETC.
- MATCH EXISTING COLORS UNLESS OTHERWISE SPECIFIED BY THE OWNER OR ENGINEER.
- NEW STRIPING SHALL RECEIVE TWO COATS OF PAINT, RESTRIPE AREAS SHALL RECEIVE ONE COAT.

GENERAL NOTES

- ALL REPAIR LOCATIONS SHOWN ARE APPROXIMATE IN SIZE AND LOCATION. ACTUAL REPAIRS SHALL BE FIELD LOCATED AND MAY BE MARKED BY ENGINEER PRIOR TO CONSTRUCTION.
- SAWCUT ALONG THE EDGES OF ALL BITUMINOUS AND CONCRETE TO REMAIN.
- RESTORE ALL AREAS OF DISTURBED LANDSCAPING TO ORIGINAL CONDITIONS OR BETTER. REPAIR GRASS AREAS WITH NEW TOPSOIL AND SEED.
- CONTRACTOR SHALL OBTAIN RIGHT OF WAY PERMIT FROM THE CITY OF MAPLE GROVE AND COMPLETE REQUIRED REGISTRATION PROCESS WITH THE CITY.

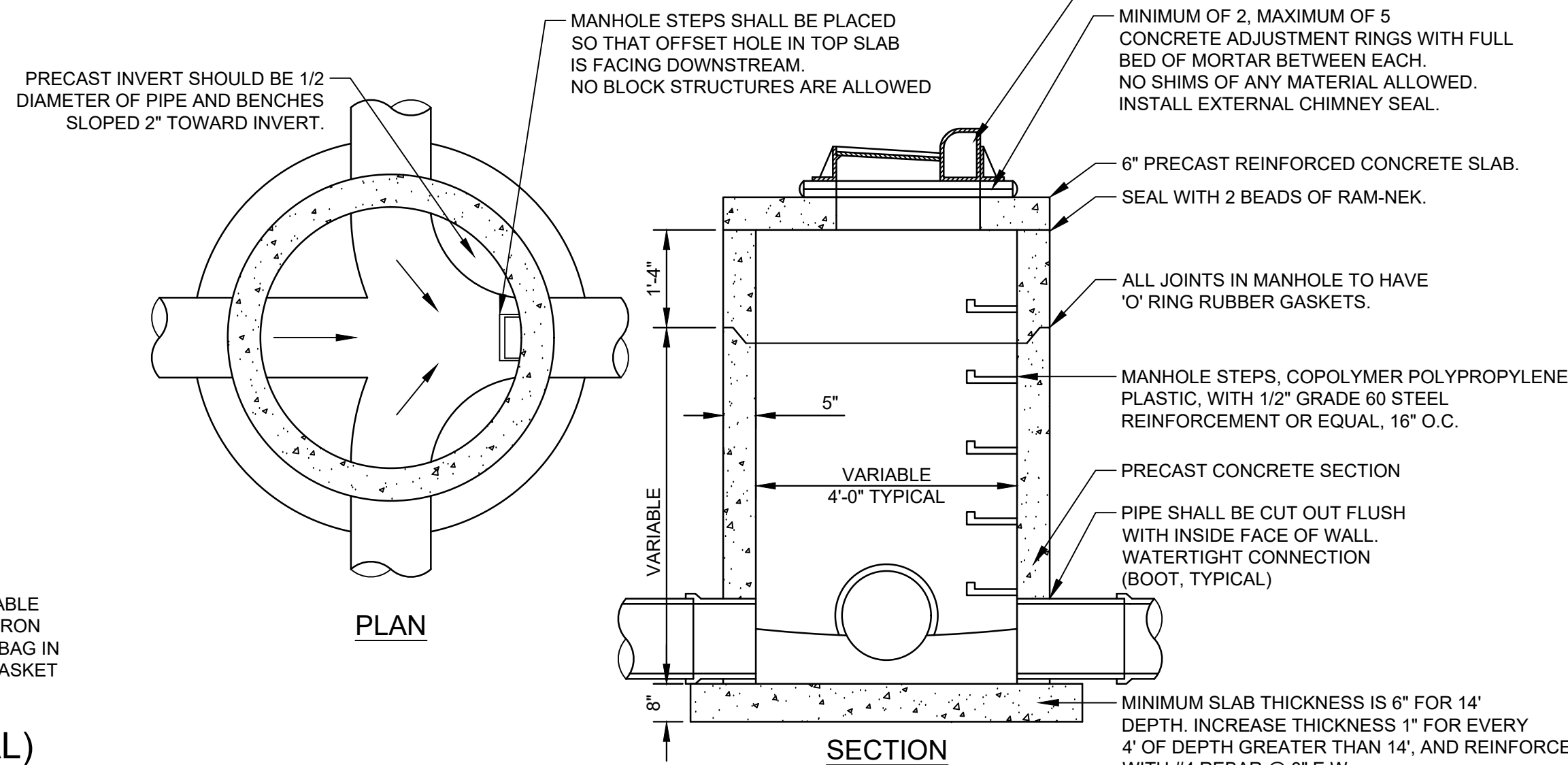

STORM SEWER MANHOLE/CATCH BASIN DETAIL

2 C105 NOT TO SCALE

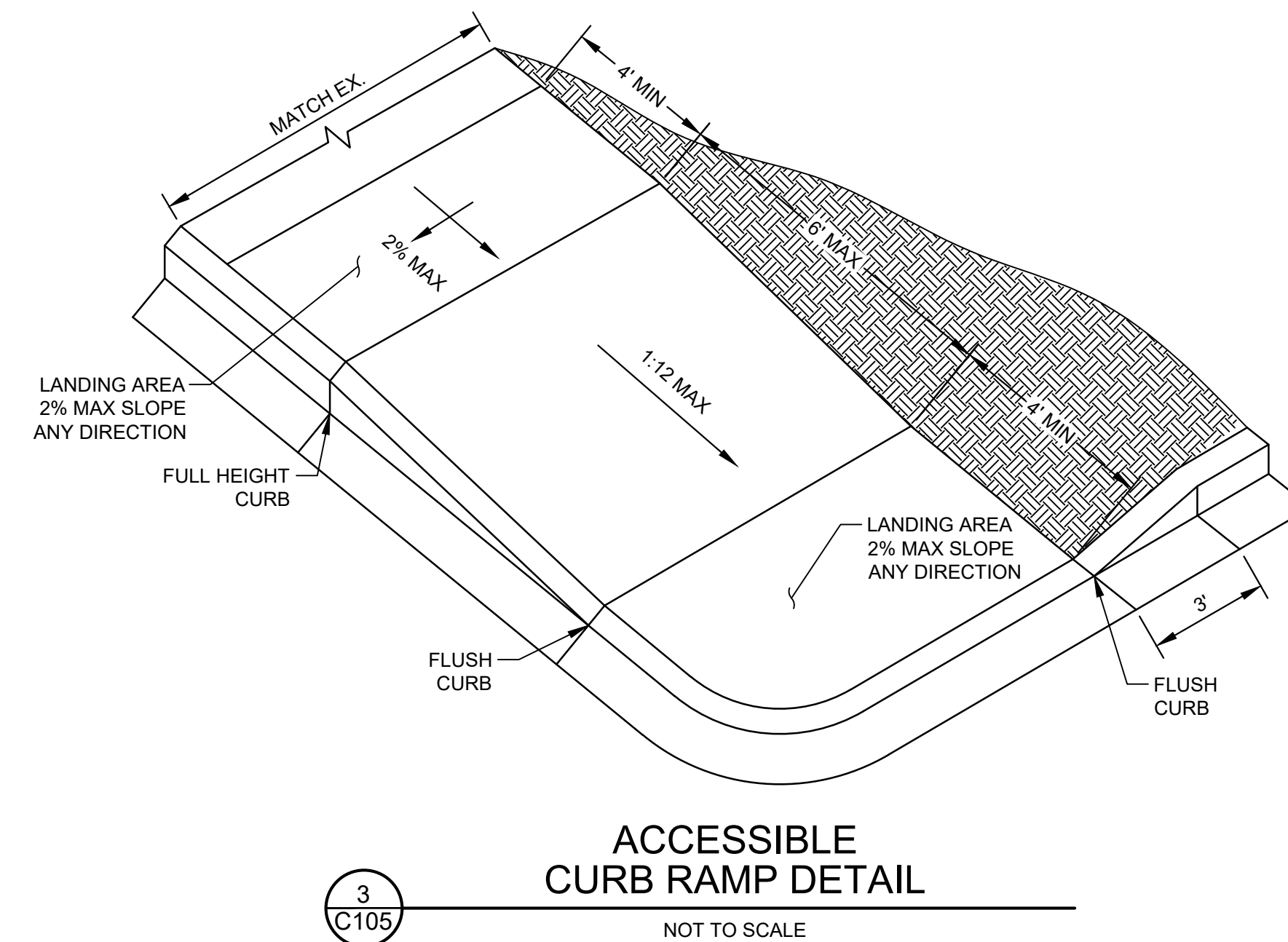

ACCESSIBLE CURB RAMP DETAIL

3 C105 NOT TO SCALE

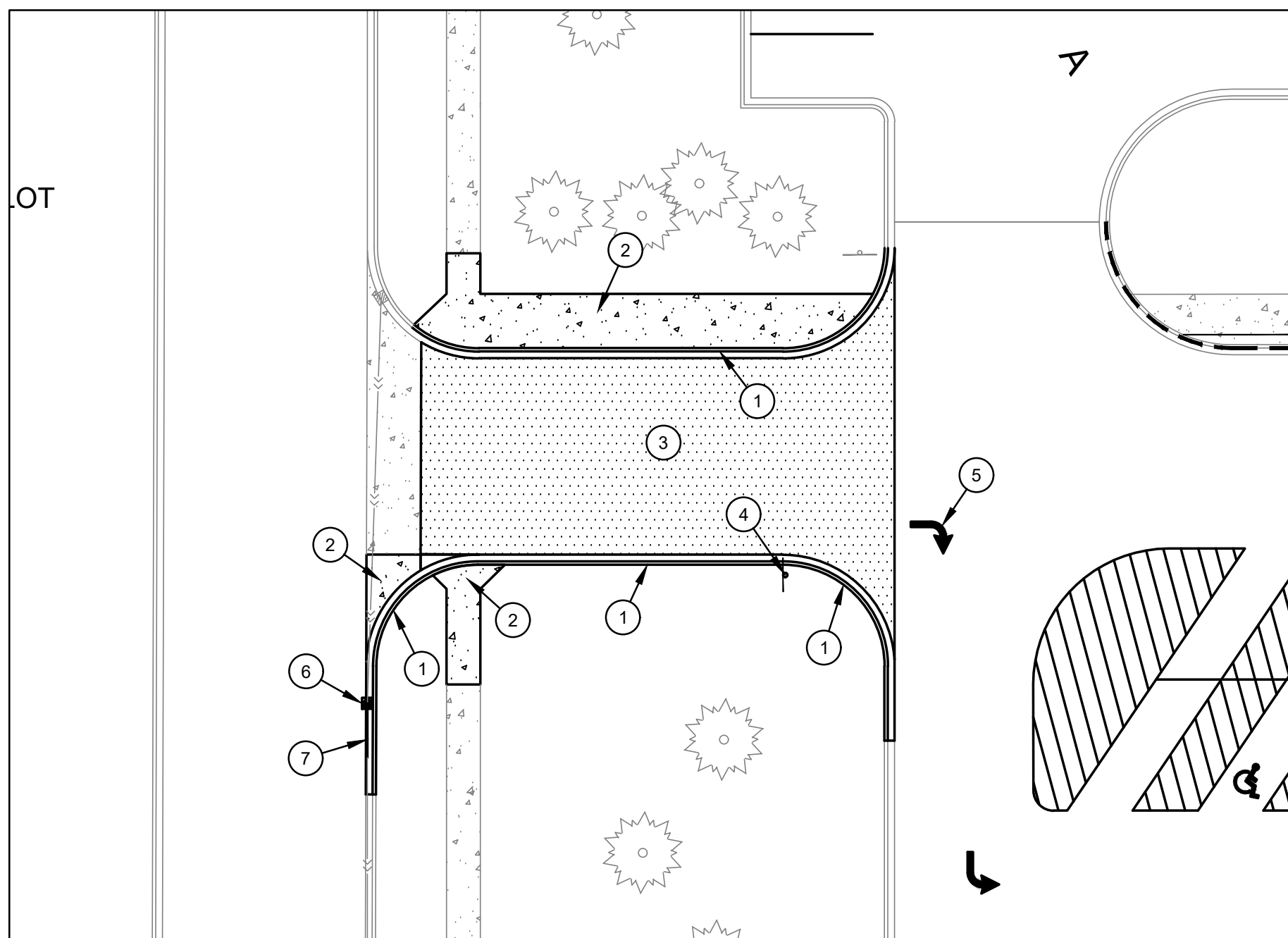

EXISTING CONDITIONS AND DEMOLITION PLAN

A C105 SCALE 1:20

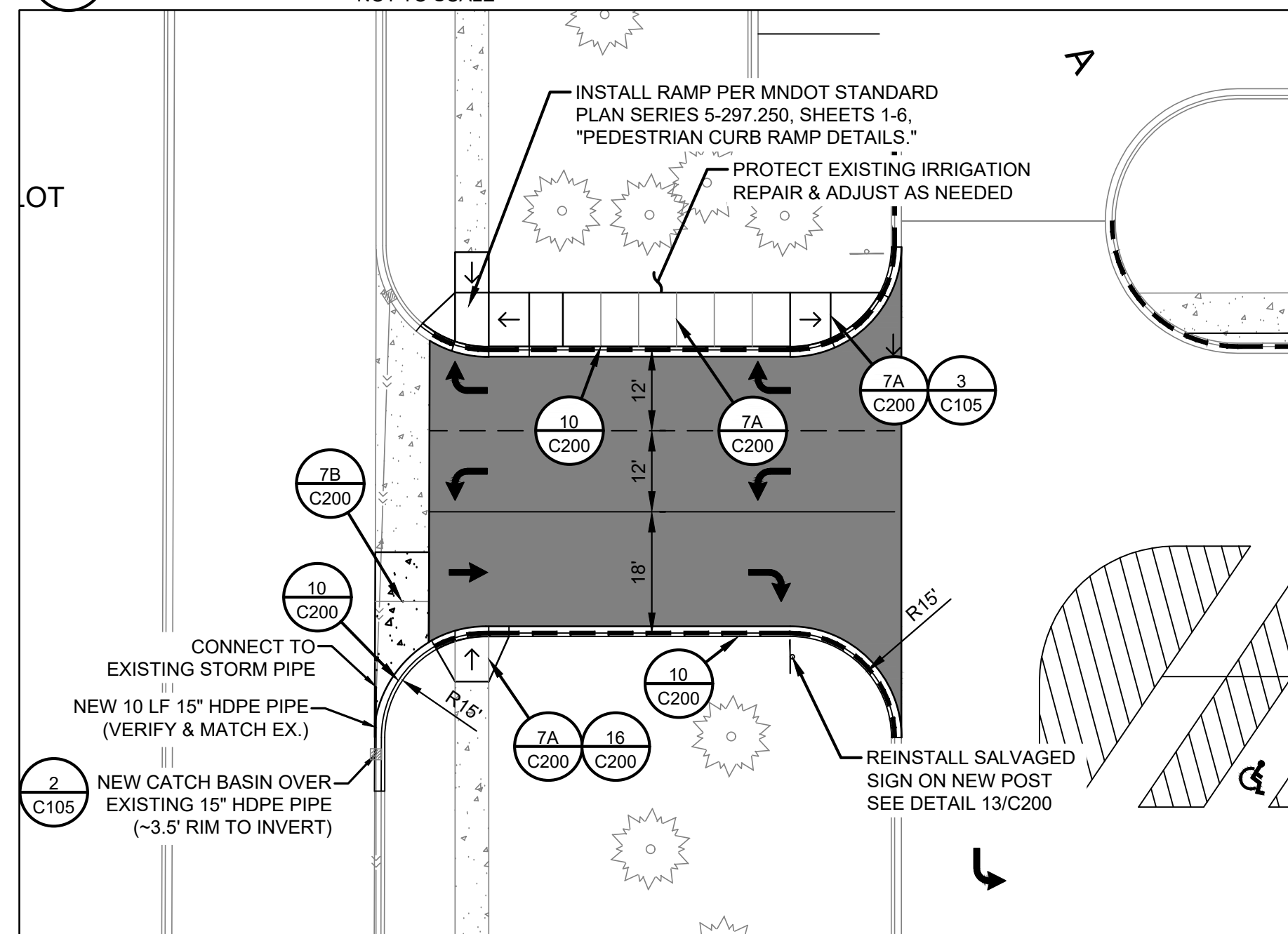

CIVIL SITE PLAN

B C105 SCALE 1:20

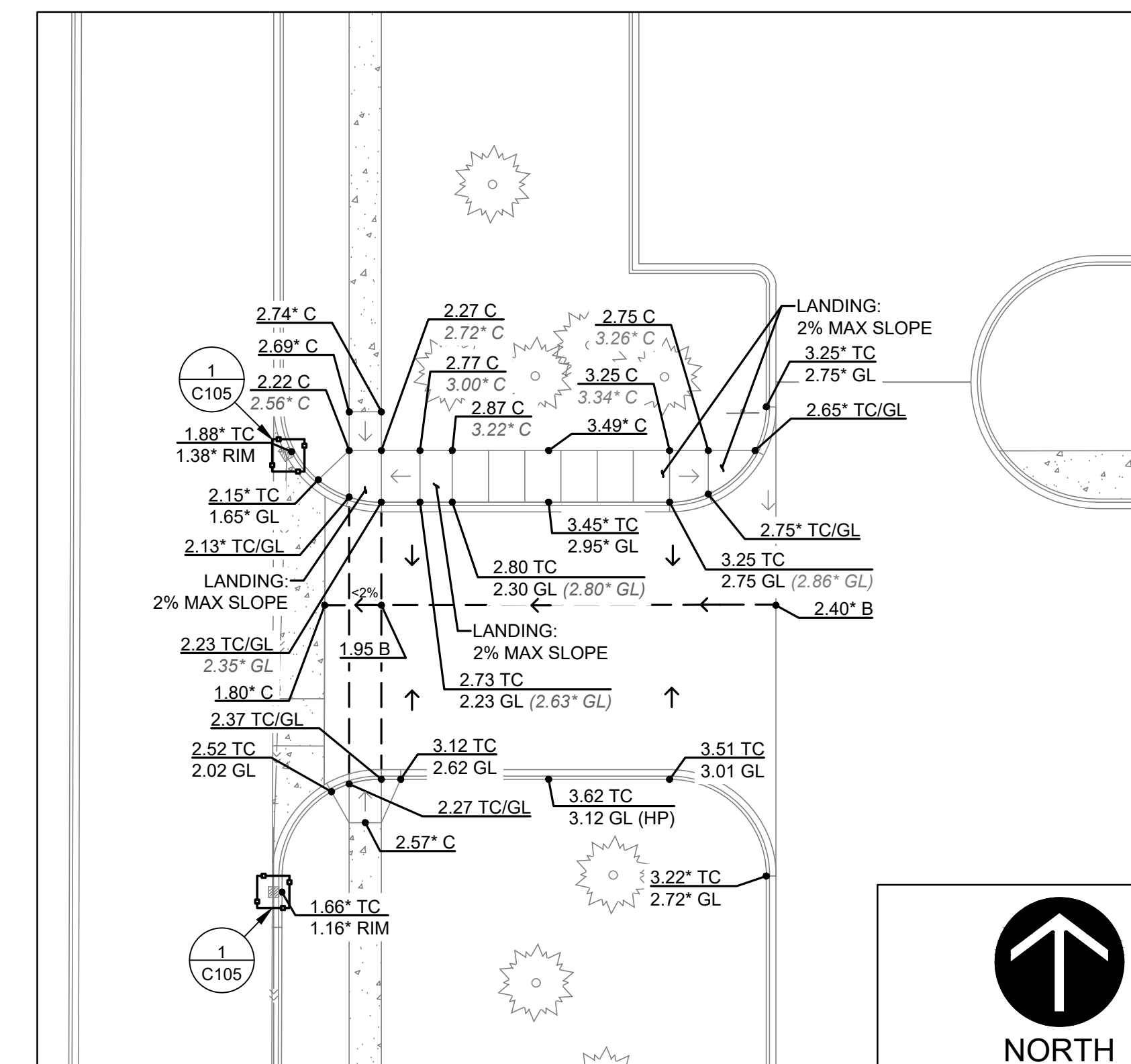

GRADING PLAN

C C105 SCALE 1:20

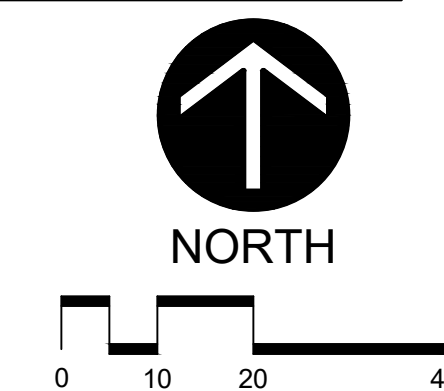

Larson Engineering, Inc.
 3524 Labore Road
 White Bear Lake, MN 55110
 651.481.9120 (f) 651.481.9201
 www.larsonengr.com

ISD 279 - OSSEO AREA SCHOOLS
 11200 93rd AVENUE NORTH
 MAPLE GROVE, MN 55369

2020 PAVEMENT REHABILITATION
 ELM CREEK ELEMENTARY
 9830 REVERE LANE NORTH
 MAPLE GROVE, MN 55369

I hereby certify that this plan, specifications or report was prepared by me or under my direct supervision and that I am a duly licensed Professional Engineer under the laws of the state of Minnesota.

Eric G. Meyer
 Eric G. Meyer, P.E.
 Date: 02.28.20 Lic. No.: 44592

Rev.	Date	Description

Project #: 12196191.000
 Drawn By: BDM/NJN
 Checked By: EGM
 Issue Date: 02.28.20

Sheet Title:
ELM CREEK ELEMENTARY DRIVEWAY REHABILITATION PLAN

Sheet:
C105