



Local  
CMS#

CMS#

16247827

### CenturyLink Constant Job Order/Maintenance Work Authorization

Company T866 Exchange 579 Osseo Service Order# \_\_\_\_\_  
 Work Activity Drop-Buried Copper Capital x Maintenance \_\_\_\_\_  
 Customer Name SCOTT DARLING Phone# 763-488-1636  
 Address 10052 104TH AVE N One Call Ticket# \_\_\_\_\_  
 Location/Directions Maple Grove, MN

Description of Work or Special Instructions This is fiber. Customer is waiting on service. Add new 4 port MST. Plow 60' from ped (124591) to new 4 port MST across the street. Then plow 140' from MST to house with a 25' bore

DOR/TOG Yes \_\_\_ No x Permit: Yes \_\_\_ No x Bore: Yes x No \_\_\_ CBR# 952-240-7818  
 Employee Name Kris Townsend Employee Contact# 612-715-9060

Sketch (Include Line & Pedestal)	Material/Labor Units		Est Qty.	Actual Qty.	Placed by (Foreman/Crew Name)
	Description	Notes			
Line _____					
Ped# _____					
Parish/County Hennipen					
Township: _____					
Section _____					
Range _____					
GPS Reading _____					

Nearest cross st. \_\_\_\_\_ Plat Page \_\_\_\_\_ Map# \_\_\_\_\_  
 Damaged facility # \_\_\_\_\_ Tax Code \_\_\_\_\_  
**SKETCH**

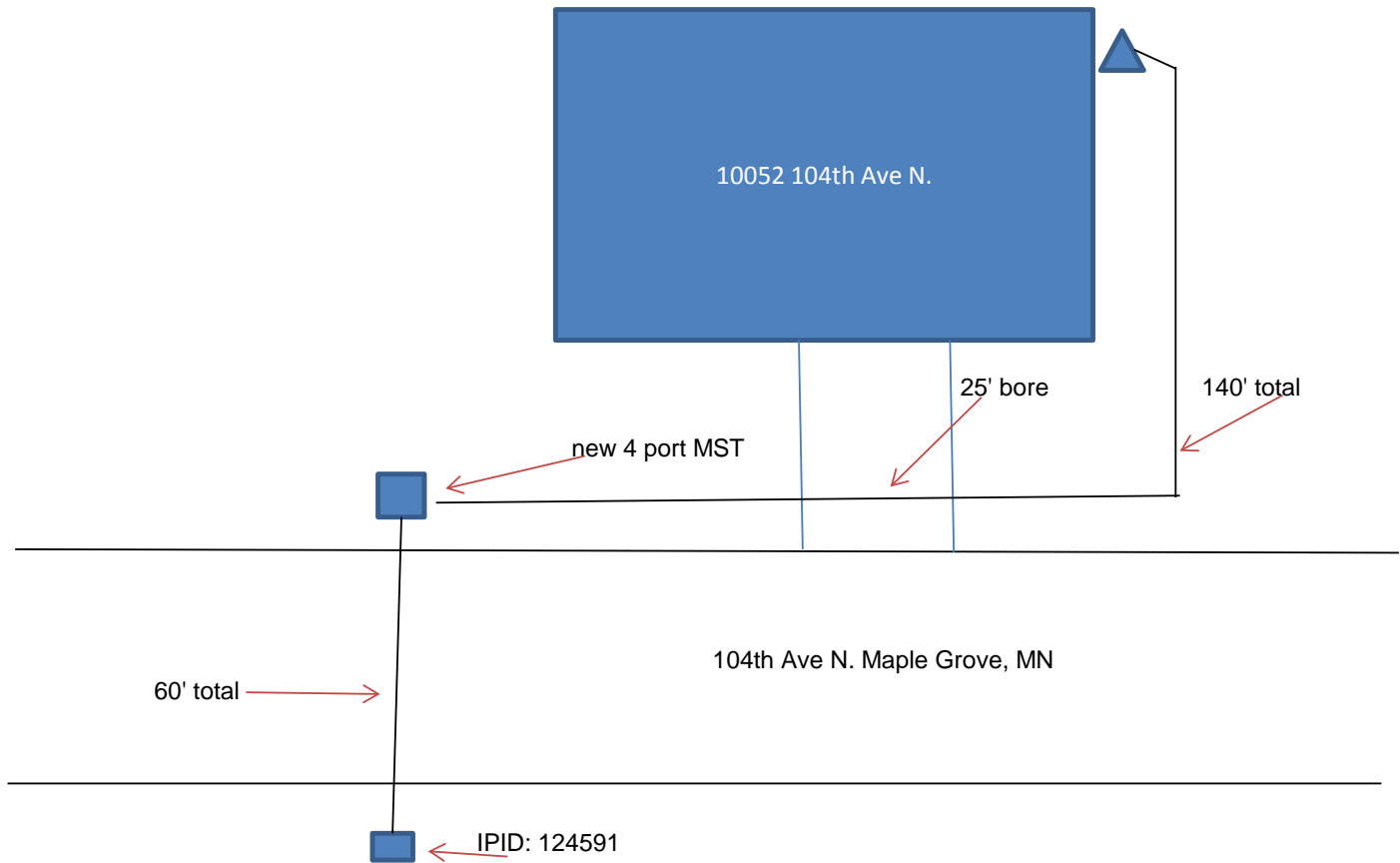

Originated By: Townsend Date: 11/1/16 Completed By: \_\_\_\_\_ Date: \_\_\_\_\_  
 Authorized By: (APS) \_\_\_\_\_ Date: \_\_\_\_\_ Inspected By: \_\_\_\_\_ Date: \_\_\_\_\_  
 Authorized By: (AOM) \_\_\_\_\_ Date: \_\_\_\_\_  
 Inspection notes: \_\_\_\_\_