

Escalated Cable Replacement
 15407 95th Avenue N, Maple Grove
 Feeder. ECK061/B/7.9Kva

Directional Bore. Bore in 300' of #2AL 1P Cable
 from TR L8 to TR K8

Terminations. 2 termination at L8 and K8

Restorations.

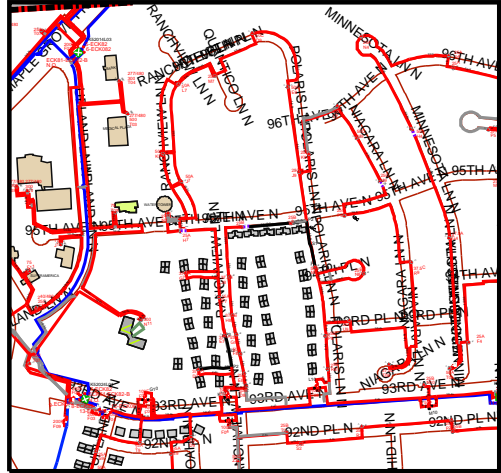

Haile Werke
 O (651)-265-7028
 C (651)-246-6331

Work Order Information	
Service Request #	:
Design Number	: 00000907733
Designer/Planner ID	: 235036
Designer/Planner Name	: Werke, Haile
Designer/Planner Ph #	: (651) 265-7028
Manager Approval	:

Joint Utility	
E:	G:
T:	C:

Design Location	
Division	: Minneapolis
County	: Hennepin
City	: Maple Grove
Address	: 15407 95th Avenue N
T:	119N R: 22W S: 9
Map #	: K52024 Permit :

Electric	
Feeder:	See Notes Voltage: See Notes
Phase:	See Notes Bkup Dev ID:

Gas	
System	: Pressure :
Size	: Material :
Dead End	:

Work Order # :
 Date: 05/18/2020
 Sketch: # Of # Sketch Data
 Scale: 1" equals 83'

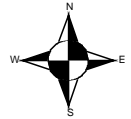

CONSTRUCTION USE ONLY	
<input type="checkbox"/>	NO CHANGES (BUILT AS DESIGNED)
<input type="checkbox"/>	CHANGES MADE AS INDICATED (ALL URD MUST HAVE ACTUAL MEASUREMENTS FROM THE FIELD SITE)

RFO
 FOREMAN _____ DATE _____
 TEAM LEADER _____

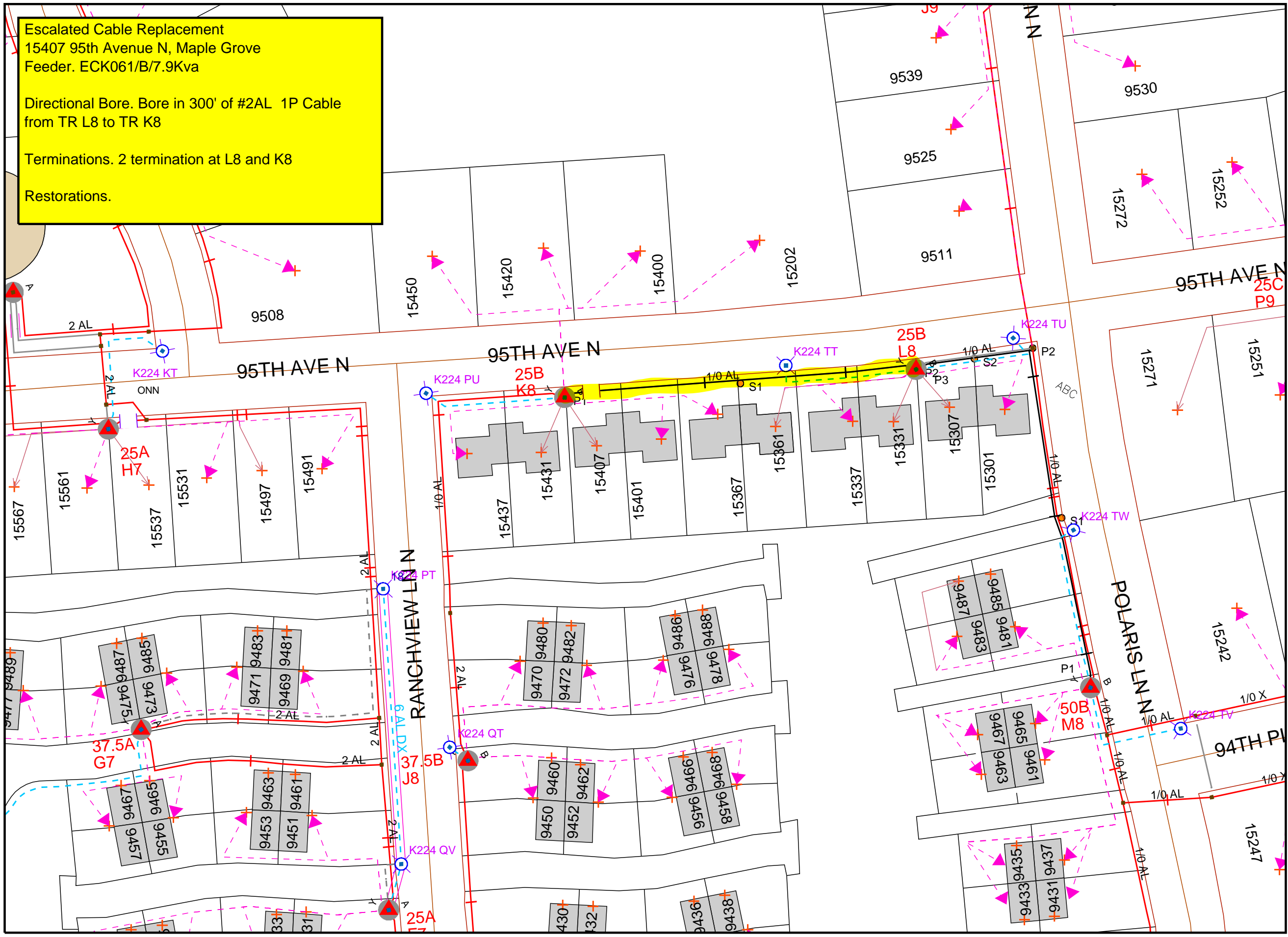

DISCLAIMER: THERE ARE NO REPRESENTATIONS OR WARRANTIES (EXPRESS OR IMPLIED) ABOUT THE ACCURACY OF THIS PRINT. THIS PRINT IS PROVIDED WITH NO CLAIM AS TO PRINT COMPLETENESS, TIMELINESS, ACCURACY OF CONTENT OR USEFULNESS. STATE LAW REQUIRES ANYONE DIGGING, GRADING OR EXCAVATING TO OBTAIN A PRIOR FIELD LOCATE OF ALL UTILITIES. THIS PRINT DOES NOT DISCHARGE THIS REQUIREMENT OR ANY OTHER REQUIREMENT. THE COMPANY AND ITS AFFILIATES ASSUME NO LEGAL RESPONSIBILITY OR LIABILITY FOR THE RECIPIENT'S USE (OR ANY OTHER PARTIES' USE) OF THE PRINT, INCLUDING THE RECIPIENT'S INTENDED PURPOSE IN USING THE PRINT. NO COMPANY EMPLOYEE OR OTHER PARTY HAS BEEN AUTHORIZED TO PROVIDE THIS PRINT FOR PLANNING OR ESTIMATING PURPOSES; RELY ON THIS PRINT AT YOUR OWN RISK. BY ACCEPTING THIS PRINT, THE RECIPIENT & ANY OTHER PARTY RECEIVING A COPY OF THE PRINT ACKNOWLEDGES AND AGREES TO THIS DISCLAIMER. For All Field Locates Call 811