

Address: 7560 LANEWOOD LN N, Maple Grove
 Feeder: ECK062
 Voltage: 7.9 kVA
 Last Failed Span: TR K - TR J

Task 1: Bore 460' One Phase #2 AL 7.9 kVA cable from TR K - TR J
 Task 2: Terminate TR K, J
 Task 3: Restore

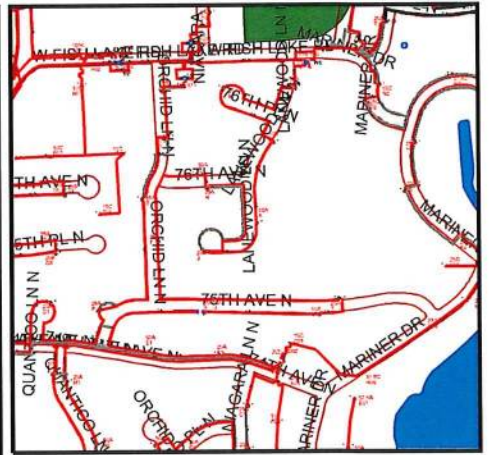
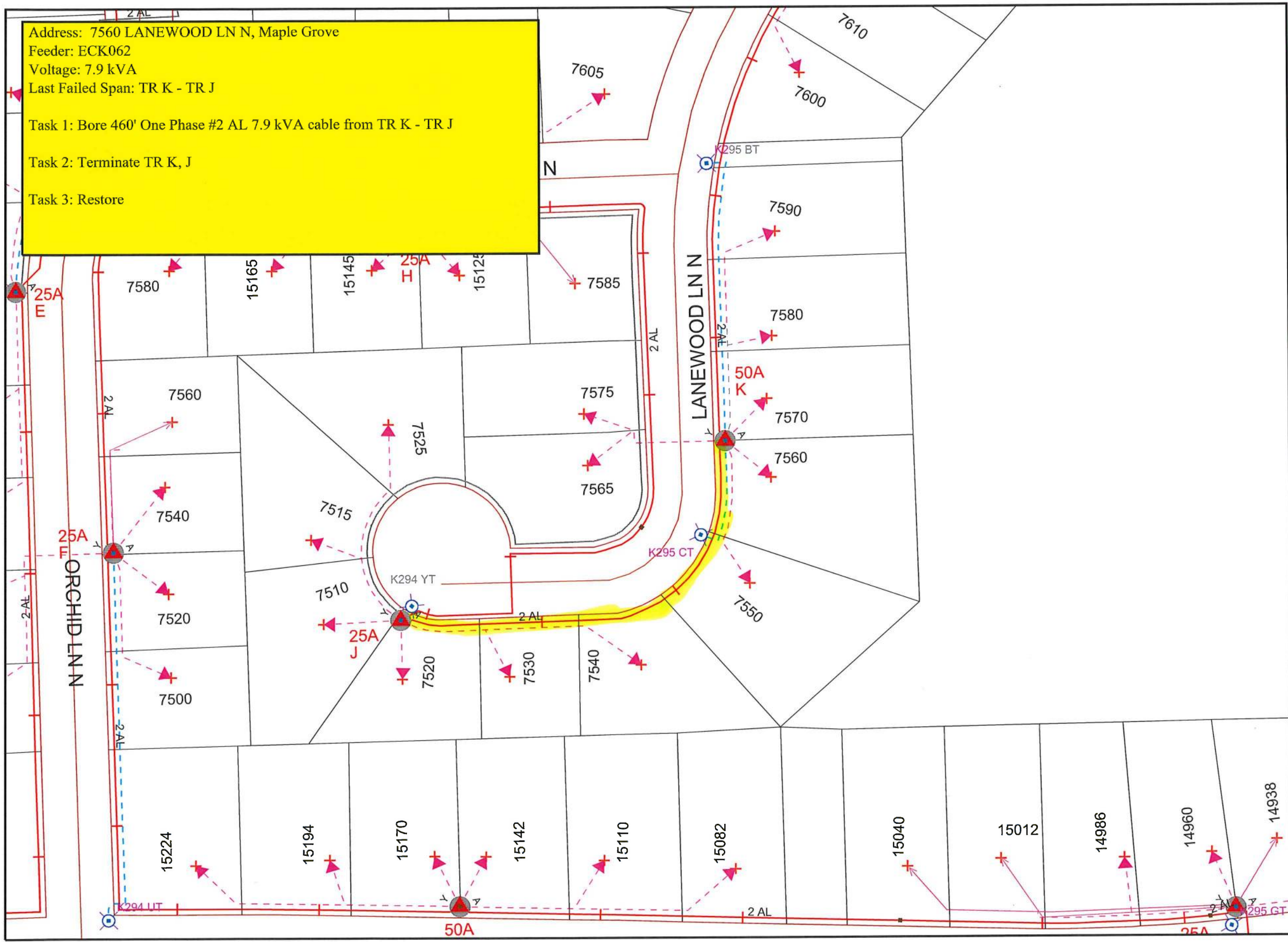

Work Order Information

Service Request # :
 Design Number : 000055214
 Designer/Planner ID : 216166
 Designer/Planner Name : Joel.Feik@xcelenergy.com
 Designer/Planner Ph # : (651) 415 -3836
 Manager Approval :

Joint Utility

E: G:
 T: C:

Design Location

Division : MG
 County : Hennepin
 City : Maple Grove
 Address :
 T: 119N R: 22W S: 28
 Map # : K52095 Permit :

Electric

Feeder: ECK062 Voltage: 7900
 Phase: Bkup Dev ID:

Gas

System : Pressure :
 Size : Material :
 Dead End :

Work Order # : 12455277
 Date: 10/20/2016
 Sketch: # Of # Sketch Data
 Scale: 1" equals 83'



CONSTRUCTION USE ONLY

- NO CHANGES (BUILT AS DESIGNED)
- CHANGES MADE AS INDICATED (ALL URD MUST HAVE ACTUAL MEASUREMENTS FROM THE FIELD SITE)

RFO _____
 FOREMAN _____ DATE _____
 TEAM LEADER _____

DISCLAIMER: THERE ARE NO REPRESENTATIONS OR WARRANTIES (EXPRESS OR IMPLIED) ABOUT THE ACCURACY OF THIS PRINT. THIS PRINT IS PROVIDED WITH NO CLAIM AS TO PRINT COMPLETENESS, TIMELINESS, ACCURACY OF CONTENT OR USEFULNESS. STATE LAW REQUIRES ANYONE DIGGING, GRADING OR EXCAVATING TO OBTAIN A PRIOR FIELD LOCATE OF ALL UTILITIES. THIS PRINT DOES NOT DISCHARGE THIS REQUIREMENT OR ANY OTHER REQUIREMENT. THE COMPANY AND ITS AFFILIATES ASSUME NO LEGAL RESPONSIBILITY OR LIABILITY FOR THE RECIPIENT'S USE (OR ANY OTHER PARTIES' USE) OF THE PRINT, INCLUDING THE RECIPIENT'S INTENDED PURPOSE IN USING THE PRINT. NO COMPANY EMPLOYEE OR OTHER PARTY HAS BEEN AUTHORIZED TO PROVIDE THIS PRINT FOR PLANNING OR ESTIMATING PURPOSES; RELY ON THIS PRINT AT YOUR OWN RISK. BY ACCEPTING THIS PRINT, THE RECIPIENT & ANY OTHER PARTY RECEIVING A COPY OF THE PRINT ACKNOWLEDGES AND AGREES TO THIS DISCLAIMER. For All Field Locates Call 811