

PCI ROADS
11803 HIGHWAY 94
OH-UG 1PH FOR DUMP TRUCKS
ECK322 -19.9KV (2/4)

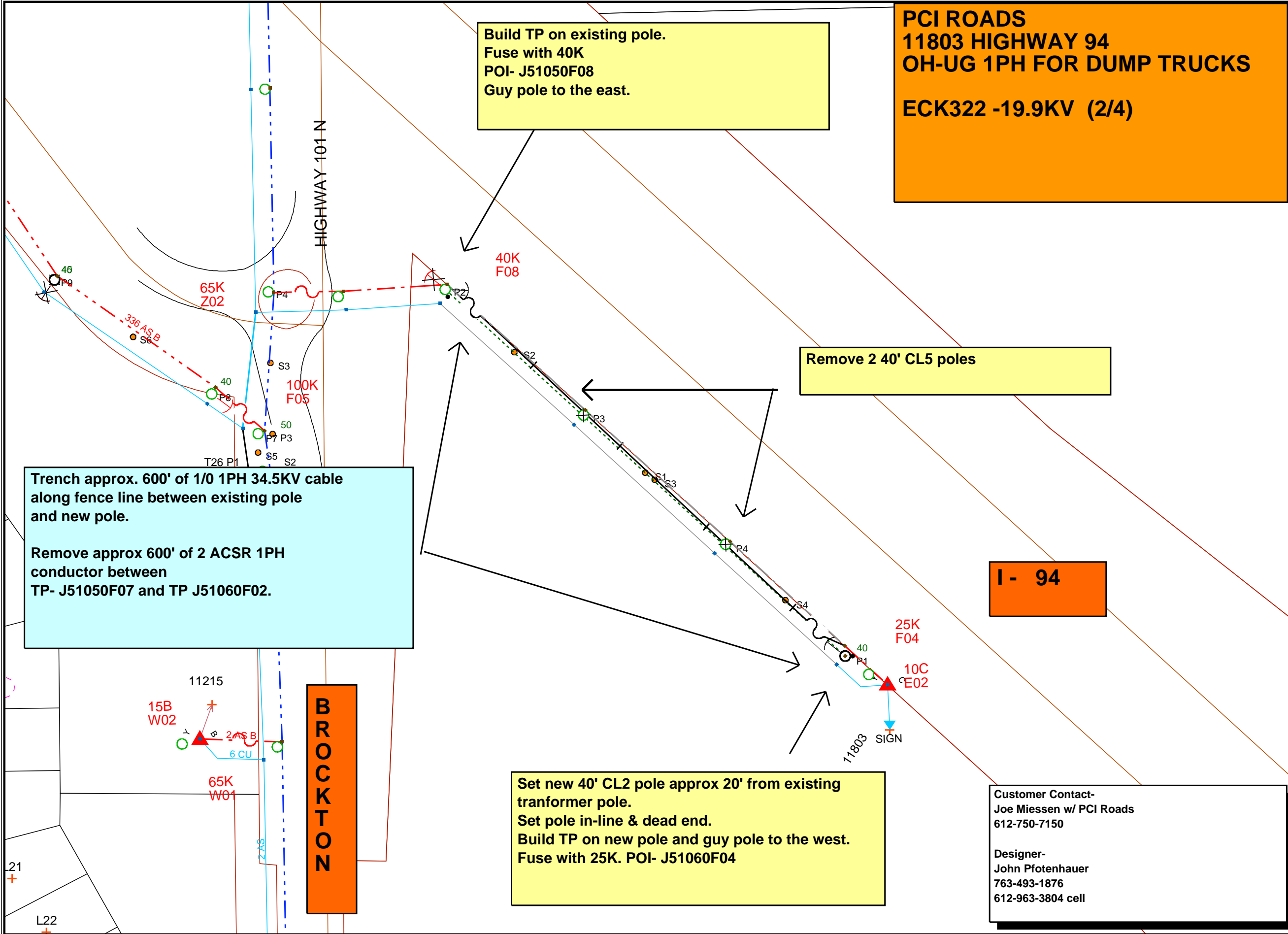
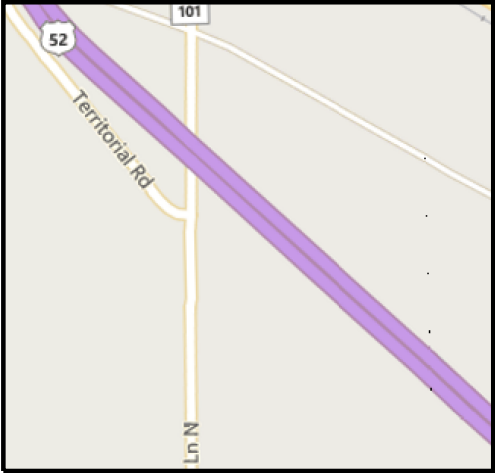

Trench approx. 600' of 1/0 1PH 34.5KV cable along fence line between existing pole and new pole.

Remove approx 600' of 2 ACSR 1PH conductor between TP- J51050F07 and TP J51060F02.

Build TP on existing pole.
Fuse with 40K
POI- J51050F08
Guy pole to the east.

Remove 2 40' CL5 poles

I - 94

Set new 40' CL2 pole approx 20' from existing tranformer pole.
Set pole in-line & dead end.
Build TP on new pole and guy pole to the west.
Fuse with 25K. POI- J51060F04

Customer Contact-
Joe Miessen w/ PCI Roads
612-750-7150

Designer-
John Pfothenauer
763-493-1876
612-963-3804 cell

Work Order Information

Service Request # :
 Design Number : 000000940518
 Designer/Planner ID : pftj01
 Designer/Planner Name : Pfothenauer, John
 Designer/Planner Ph # : (763) 493-1876
 Manager Approval :

Joint Utility

E: G:
 T: C:

Design Location

Division : Maple Grove
 County : HENNEPIN
 City : DAYTON
 Address : 18951 TERRITORIAL RD
 T: 120N R: 22W S: 31
 Map # : J51060 Permit :

Electric

Feeder: ECK322 Voltage: 19.9KV
 Phase: A Bkup Dev ID:

Gas

System : Pressure :
 Size : Material :
 Dead End :

Work Order # : **104656727**

Date: 05/04/2020
 Sketch: 1 Of 1 Sketch Data
 Scale: 1" equals 100'

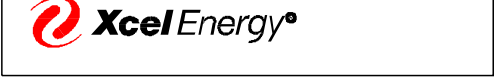

CONSTRUCTION USE ONLY

NO CHANGES (BUILT AS DESIGNED)
 CHANGES MADE AS INDICATED (ALL URD MUST HAVE ACTUAL MEASUREMENTS FROM THE FIELD SITE)

RFO _____
 FOREMAN _____ DATE _____
 TEAM LEADER _____

DISCLAIMER: THERE ARE NO REPRESENTATIONS OR WARRANTIES (EXPRESS OR IMPLIED) ABOUT THE ACCURACY OF THIS PRINT. THIS PRINT IS PROVIDED WITH NO CLAIM AS TO PRINT COMPLETENESS, TIMELINESS, ACCURACY OF CONTENT OR USEFULNESS. STATE LAW REQUIRES ANYONE DIGGING, GRADING OR EXCAVATING TO OBTAIN A PRIOR FIELD LOCATE OF ALL UTILITIES; THIS PRINT DOES NOT DISCHARGE THIS REQUIREMENT OR ANY OTHER REQUIREMENT. THE COMPANY AND ITS AFFILIATES ASSUME NO LEGAL RESPONSIBILITY OR LIABILITY FOR THE RECIPIENT'S USE (OR ANY OTHER PARTIES' USE) OF THE PRINT, INCLUDING THE RECIPIENT'S INTENDED PURPOSE IN USING THE PRINT. NO COMPANY EMPLOYEE OR OTHER PARTY HAS BEEN AUTHORIZED TO PROVIDE THIS PRINT FOR PLANNING OR ESTIMATING PURPOSES; RELY ON THIS PRINT AT YOUR OWN RISK. BY ACCEPTING THIS PRINT, THE RECIPIENT & ANY OTHER PARTY RECEIVING A COPY OF THE PRINT ACKNOWLEDGES AND AGREES TO THIS DISCLAIMER. For All Field Locates Call 811