

CITY PERMIT NOTES:

1. This new CDFS Retail Project will provide Switched Ethernet service to Nortech Systems at 7550 Meridian Circle N, Maple Grove, MN.
2. Splicing at HH3-HH3.
3. Bore and place 2513 feet of new 1.25" ID ARM and UO24NS fiber cable from existing 1188-HH7 to new 30x48 HH-7710R.
4. All disturbed surfaces will be restored to as good as or better condition than found condition.
5. All underground utilities shall be located prior to construction.
6. Any conflicting underground utilities will be potholed.
7. Bore shall maintain 2' clearance from hand holes, street lights, and signal pole foundations.
8. All bores under City trees shall be a minimum depth of 48".

DRAFTING SYMBOLS

	EXISTING HANDHOLE
	EXISTING PEDESTAL
	EXISTING UTILITY CABINET
	EXISTING ADDRESS

DRAFTING LINETYPES

EDGE OF CURB	
SIDEWALK/PATH	
PROPERTY LINE	
RIGHT-OF-WAY	
CENTERLINE	

**7550 MERIDIAN CIRCLE NORTH
 NORTECH SYSTEMS
 HENNEPIN COUNTY
 CITY PERMIT - MAPLE GROVE, MN**

SCALE: 1"=50'



ENGINEER: CENTURYLINK
 CPA/CONTRACTOR: CENTURYLINK/TELCOM
 DRAWN BY: TELCOM CONSTRUCTION

PROJECT: N.634670_619189 WIRE CENTER: MPGVMNXA
 1.) LOCATE ALL UTILITIES BEFORE DIGGING
 2.) ANY CONFLICTING UNDERGROUND UTILITIES WILL BE POT HOLED.
 SHEET: 01 OF 08 REV:01 DATE:11/18/2019

No Telcom Work on this page

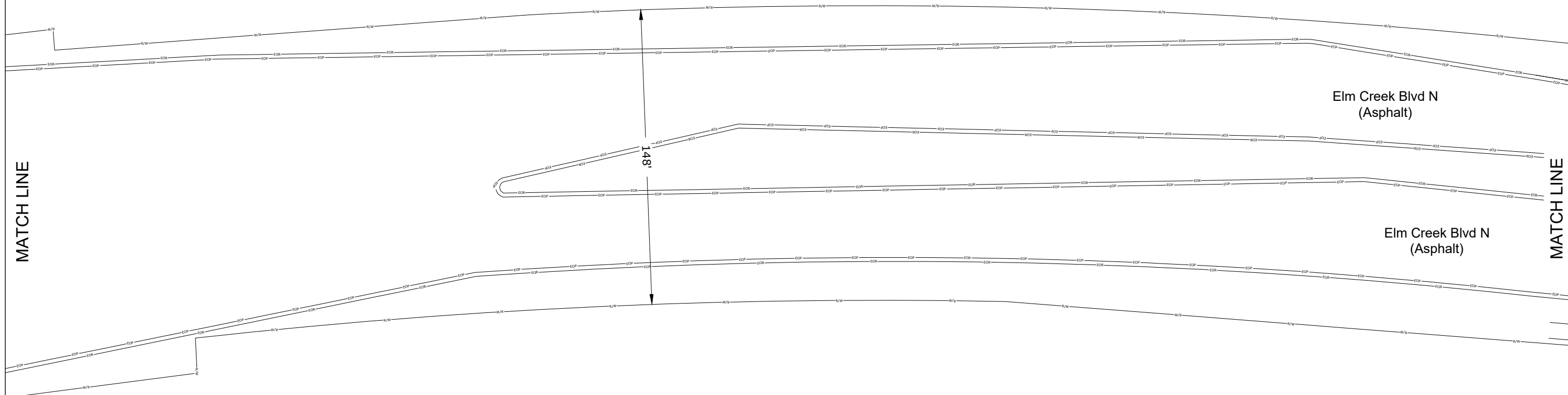

DRAFTING SYMBOLS

	EXISTING HANDHOLE
	EXISTING PEDESTAL
	EXISTING UTILITY CABINET
	EXISTING ADDRESS

DRAFTING LINETYPES

EDGE OF CURB	
SIDEWALK/PATH	
PROPERTY LINE	
RIGHT-OF-WAY	
CENTERLINE	

7550 MERIDIAN CIRCLE NORTH
 NORTECH SYSTEMS
 HENNEPIN COUNTY
 CITY PERMIT - MAPLE GROVE, MN

SCALE: 1"=50'



ENGINEER: CENTURYLINK
 CPA/CONTRACTOR: CENTURYLINK/TELCOM
 DRAWN BY: TELCOM CONSTRUCTION

PROJECT: N.634670_619189 WIRE CENTER: MPGVMNXA
 1.) LOCATE ALL UTILITIES BEFORE DIGGING
 2.) ANY CONFLICTING UNDERGROUND UTILITIES WILL BE POT HOLED.

SHEET: 02 OF 08 REV:01 DATE:11/18/2019

No Telcom Work on this page

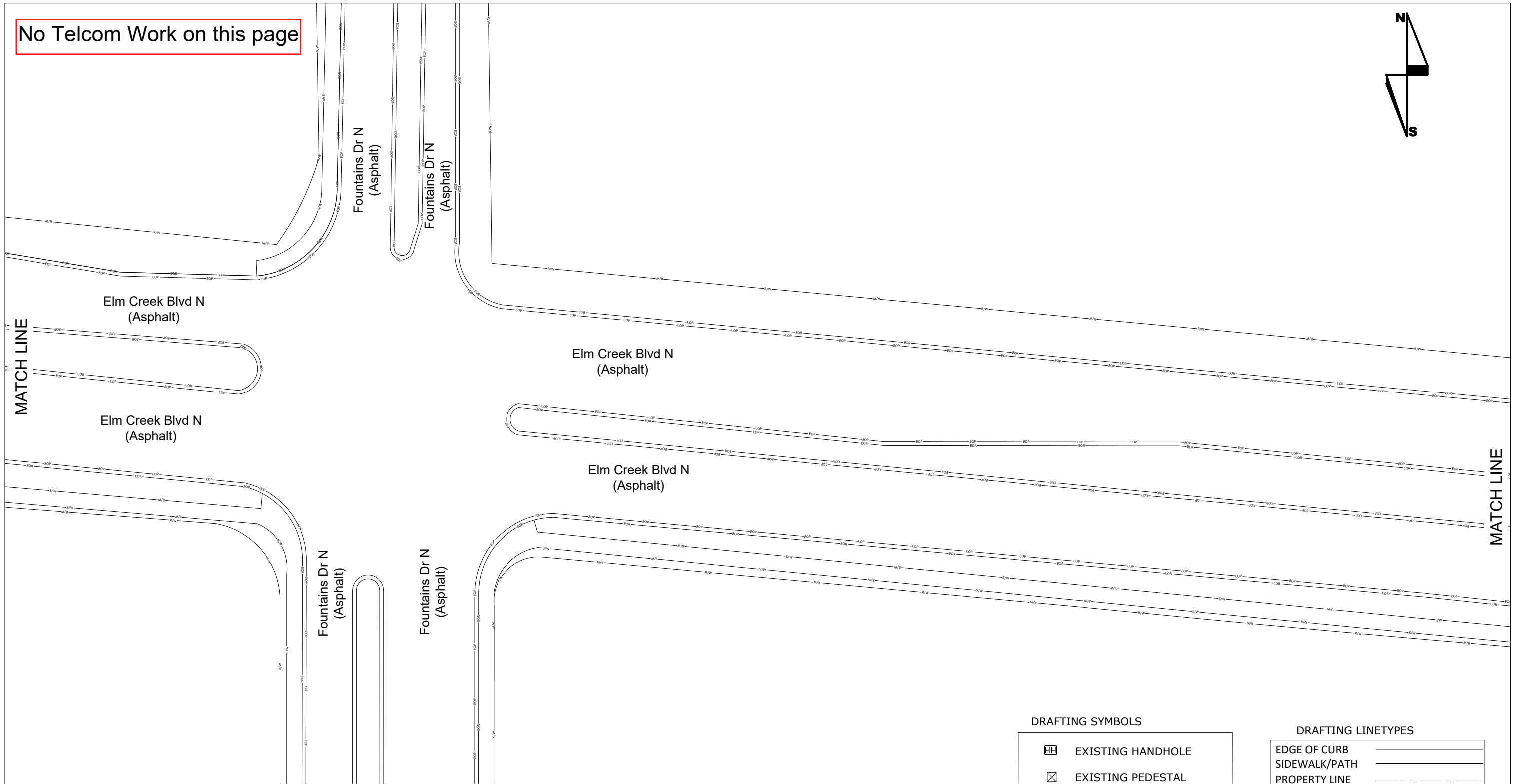
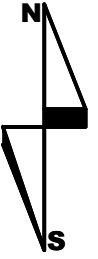

DRAFTING SYMBOLS

	EXISTING HANDHOLE
	EXISTING PEDESTAL
	EXISTING UTILITY CABINET
	EXISTING ADDRESS

DRAFTING LINETYPES

EDGE OF CURB	
SIDEWALK/PATH	
PROPERTY LINE	
RIGHT-OF-WAY	
CENTERLINE	

7550 MERIDIAN CIRCLE NORTH
 NORTECH SYSTEMS
 HENNEPIN COUNTY
 CITY PERMIT - MAPLE GROVE, MN

SCALE: 1"=50'







ENGINEER: CENTURYLINK
 CPA/CONTRACTOR: CENTURYLINK/TELCOM
 DRAWN BY: TELCOM CONSTRUCTION

PROJECT: N.634670_619189 WIRE CENTER: MPGVMNXA
 1.) LOCATE ALL UTILITIES BEFORE DIGGING
 2.) ANY CONFLICTING UNDERGROUND UTILITIES WILL BE POT HOLED.

SHEET: 03 OF 08 REV:01 DATE:11/18/2019

DRAFTING SYMBOLS

	EXISTING HANDHOLE
	EXISTING PEDESTAL
	EXISTING UTILITY CABINET
	EXISTING ADDRESS

DRAFTING LINETYPES

EDGE OF CURB	
SIDEWALK/PATH	
PROPERTY LINE	
RIGHT-OF-WAY	
CENTERLINE	

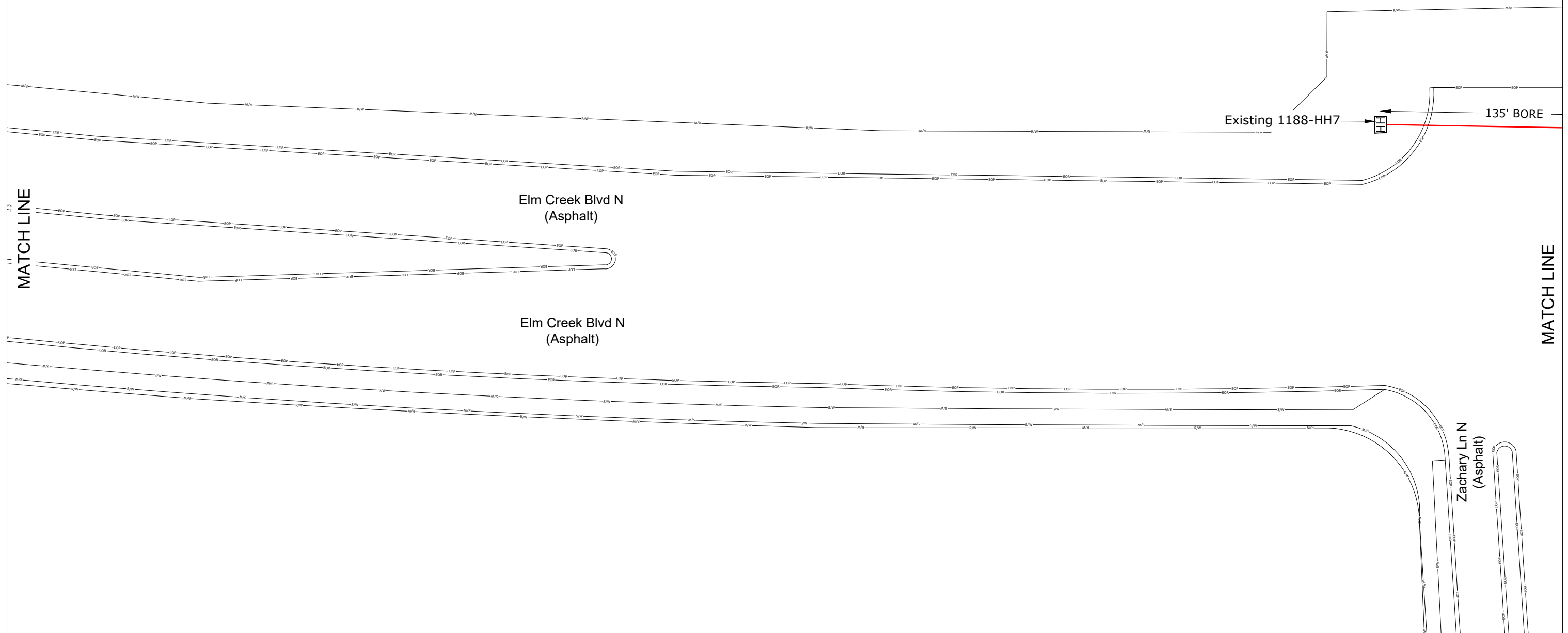
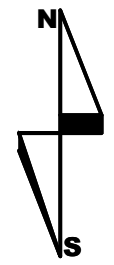

7550 MERIDIAN CIRCLE NORTH
 NORTECH SYSTEMS
 HENNEPIN COUNTY
 CITY PERMIT - MAPLE GROVE, MN

SCALE: 1"=50'



ENGINEER: CENTURYLINK
 CPA/CONTRACTOR: CENTURYLINK/TELCOM
 DRAWN BY: TELCOM CONSTRUCTION

PROJECT: N.634670_619189 WIRE CENTER: MPGVMNXA
 1.) LOCATE ALL UTILITIES BEFORE DIGGING
 2.) ANY CONFLICTING UNDERGROUND UTILITIES WILL BE POT HOLED.
 SHEET: 04 OF 08 REV:01 DATE:11/18/2019

DRAFTING SYMBOLS

	EXISTING HANDHOLE
	EXISTING PEDESTAL
	EXISTING UTILITY CABINET
	EXISTING ADDRESS

DRAFTING LINETYPES

EDGE OF CURB	
SIDEWALK/PATH	
PROPERTY LINE	
RIGHT-OF-WAY	
CENTERLINE	

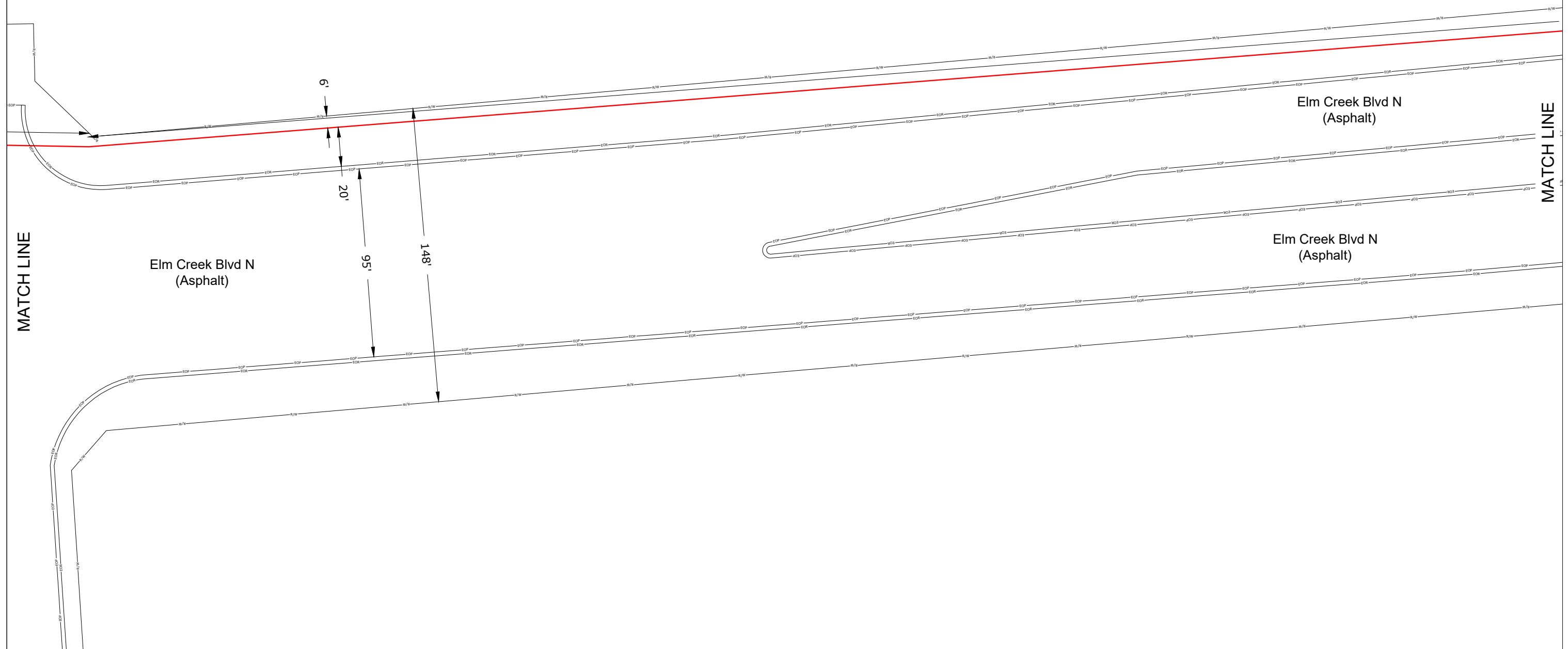
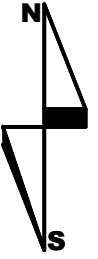

7550 MERIDIAN CIRCLE NORTH
 NORTECH SYSTEMS
 HENNEPIN COUNTY
 CITY PERMIT - MAPLE GROVE, MN





SCALE: 1"=50'



ENGINEER: CENTURYLINK
 CPA/CONTRACTOR: CENTURYLINK/TELCOM
 DRAWN BY: TELCOM CONSTRUCTION

PROJECT: N.634670_619189 WIRE CENTER: MPGVMNXA
 1.) LOCATE ALL UTILITIES BEFORE DIGGING
 2.) ANY CONFLICTING UNDERGROUND UTILITIES WILL BE POT HOLED.
 SHEET: 05 OF 08 REV:01 DATE:11/18/2019

DRAFTING SYMBOLS

	EXISTING HANDHOLE
	EXISTING PEDESTAL
	EXISTING UTILITY CABINET
	EXISTING ADDRESS

DRAFTING LINETYPES

EDGE OF CURB	
SIDEWALK/PATH	
PROPERTY LINE	
RIGHT-OF-WAY	
CENTERLINE	

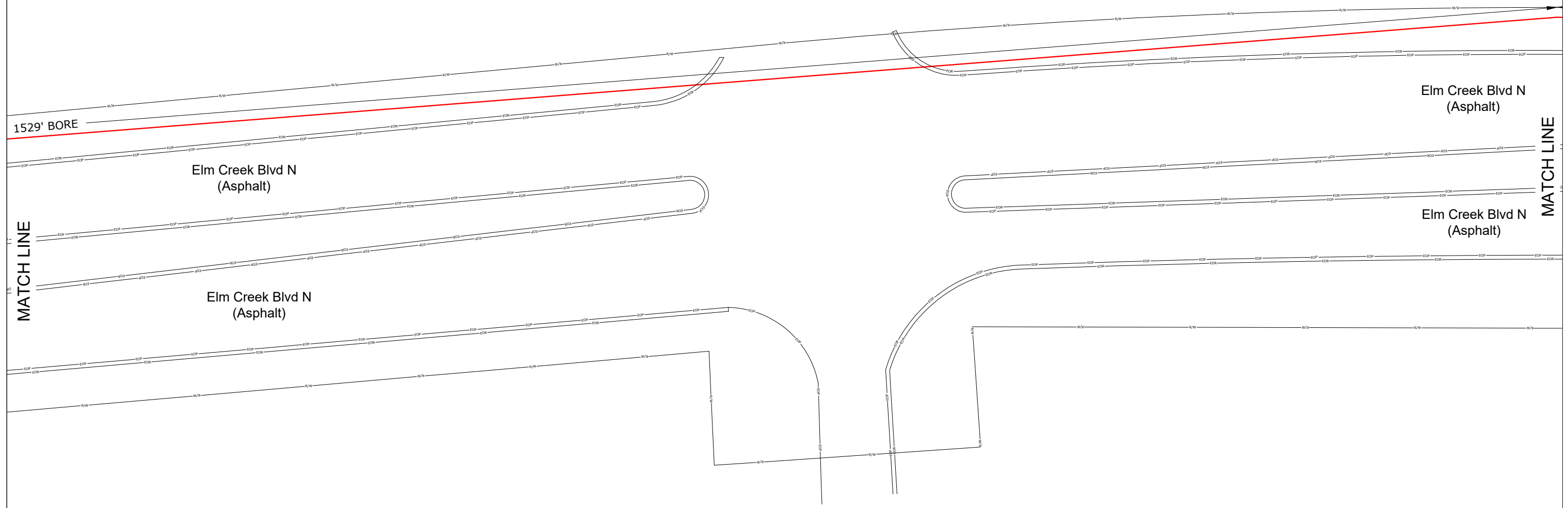
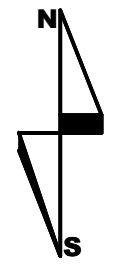

7550 MERIDIAN CIRCLE NORTH
 NORTECH SYSTEMS
 HENNEPIN COUNTY
 CITY PERMIT - MAPLE GROVE, MN





SCALE: 1"=50'



ENGINEER: CENTURYLINK
 CPA/CONTRACTOR: CENTURYLINK/TELCOM
 DRAWN BY: TELCOM CONSTRUCTION

PROJECT: N.634670_619189 WIRE CENTER: MPGVMNXXA
 1.) LOCATE ALL UTILITIES BEFORE DIGGING
 2.) ANY CONFLICTING UNDERGROUND UTILITIES WILL BE POT HOLED.
 SHEET: 06 OF 08 REV:01 DATE:11/18/2019

DRAFTING SYMBOLS

	EXISTING HANDHOLE
	EXISTING PEDESTAL
	EXISTING UTILITY CABINET
	EXISTING ADDRESS

DRAFTING LINETYPES

EDGE OF CURB	
SIDEWALK/PATH	
PROPERTY LINE	
RIGHT-OF-WAY	
CENTERLINE	

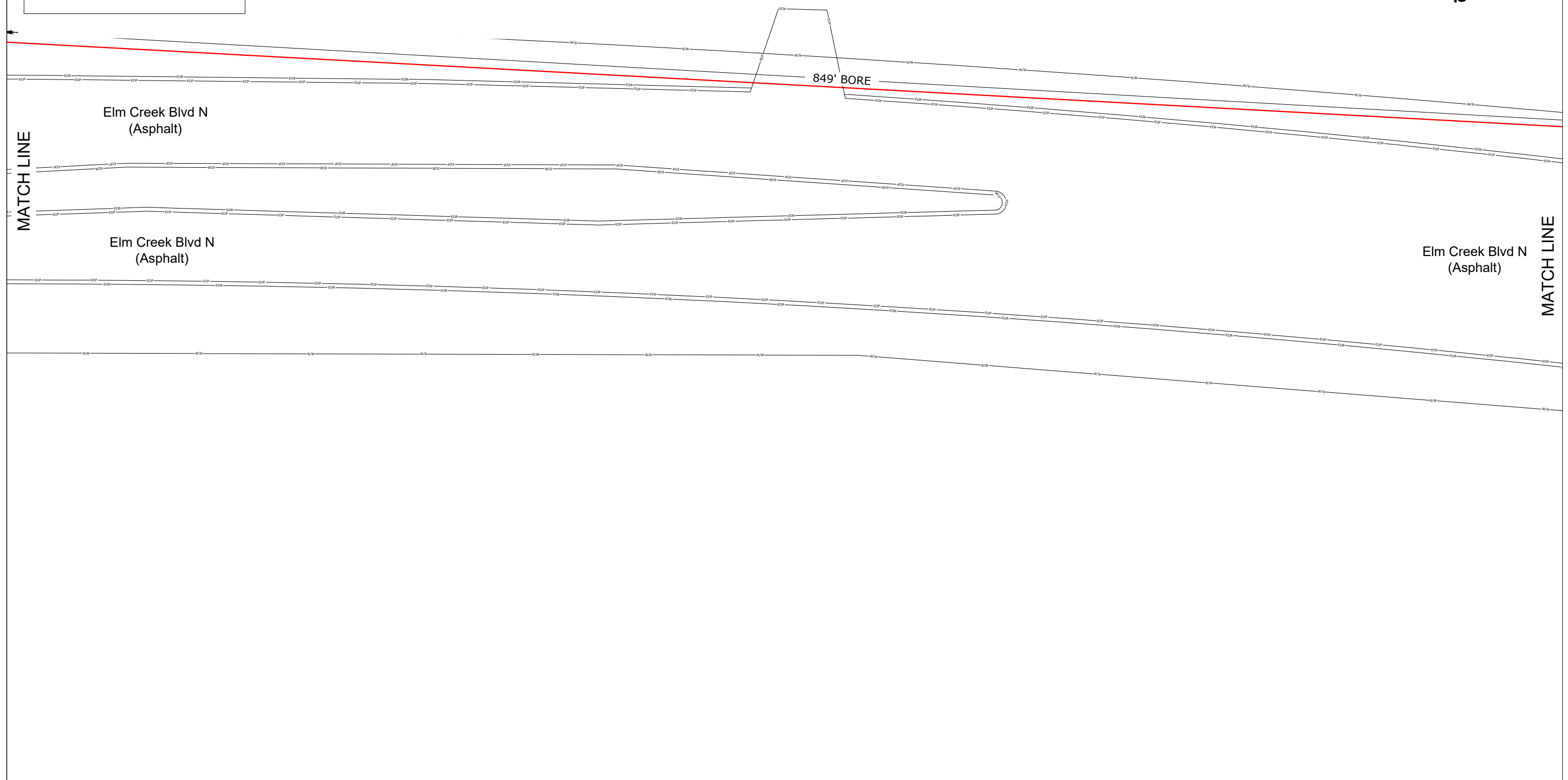
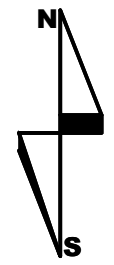

7550 MERIDIAN CIRCLE NORTH
 NORTECH SYSTEMS
 HENNEPIN COUNTY
 CITY PERMIT - MAPLE GROVE, MN





SCALE: 1"=50'



ENGINEER: CENTURYLINK
 CPA/CONTRACTOR: CENTURYLINK/TELCOM
 DRAWN BY: TELCOM CONSTRUCTION

PROJECT: N.634670_619189 WIRE CENTER: MPGVMNXA
 1.) LOCATE ALL UTILITIES BEFORE DIGGING
 2.) ANY CONFLICTING UNDERGROUND UTILITIES WILL BE POT HOLED.
 SHEET: 07 OF 08 REV:01 DATE:11/18/2019

DRAFTING SYMBOLS

	EXISTING HANDHOLE
	EXISTING PEDESTAL
	EXISTING UTILITY CABINET
	EXISTING ADDRESS

DRAFTING LINETYPES

EDGE OF CURB	
SIDEWALK/PATH	
PROPERTY LINE	
RIGHT-OF-WAY	
CENTERLINE	

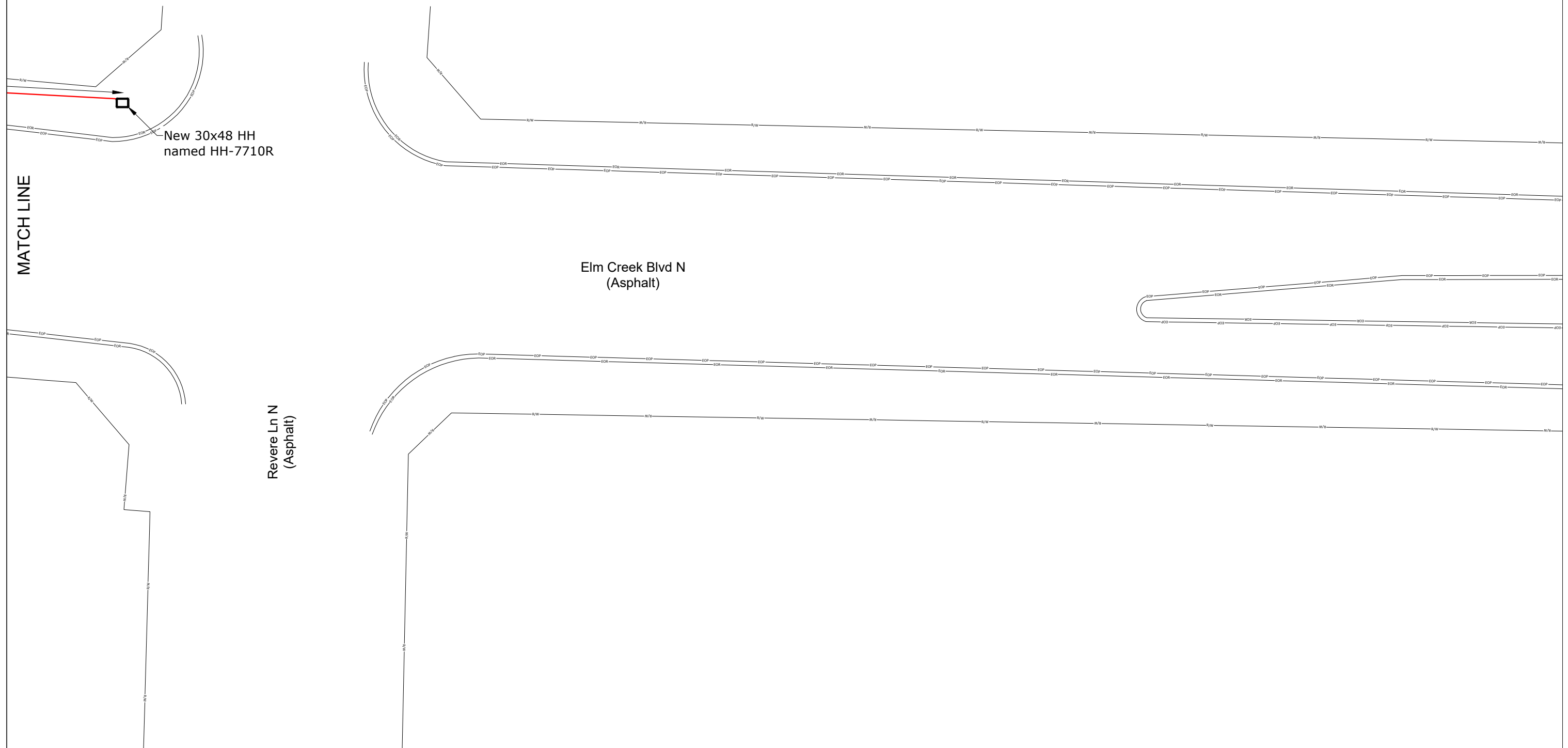
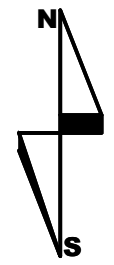

New 30x48 HH
named HH-7710R

MATCH LINE

Elm Creek Blvd N
(Asphalt)

Revere Ln N
(Asphalt)

7550 MERIDIAN CIRCLE NORTH
 NORTECH SYSTEMS
 HENNEPIN COUNTY
 CITY PERMIT - MAPLE GROVE, MN

SCALE: 1"=50'



ENGINEER: CENTURYLINK
 CPA/CONTRACTOR: CENTURYLINK/TELCOM
 DRAWN BY: TELCOM CONSTRUCTION

PROJECT: N.634670_619189 WIRE CENTER: MPGVMNXA
 1.) LOCATE ALL UTILITIES BEFORE DIGGING
 2.) ANY CONFLICTING UNDERGROUND UTILITIES WILL BE POT HOLED.
 SHEET: 08 OF 8 REV:01 DATE:11/18/2019