

**DRAFTING LINETYPES**

EDGE OF ROAD	EOR
ROW	R/W
CENTERLINE	- - -
PROPERTY LINE	- · - · -
SIDEWALK	S/W
PROPOSED BORE ROUTE	(Green line)

**DRAFTING SYMBOLS**

	EXISTING HANDHOLE
	EXISTING ADDRESS
	EXISTING CONCRETE

**PERMIT NOTES:**

- 1.) This project will provide Switched Ethernet service to 13800 83rd Way N., Maple Grove, MN.
- 2.) Begin at existing handhole, HH-13784 and bore new 125" ID and new U024 fiber 80' west and 20' north to customer's south building wall. Riser up 2' and core drill hole in wall to customer's DMARC.
- 3.) All disturbed surfaces will be restored to as good as or better condition than found condition.
- 4.) All existing underground utilities will be located prior to construction.



The subsurface utility information in this plan is utility quality level D. This utility level was determined according to the guidelines of CI/ASCE 38-02, entitled "Standard Guidelines for the collection and depiction of existing subsurface utility data. It shall be the contractors responsibility to utilize the Gopher State One Call Evacuation Notice system required by MN statute Chapter 216d for all underground utility locations.

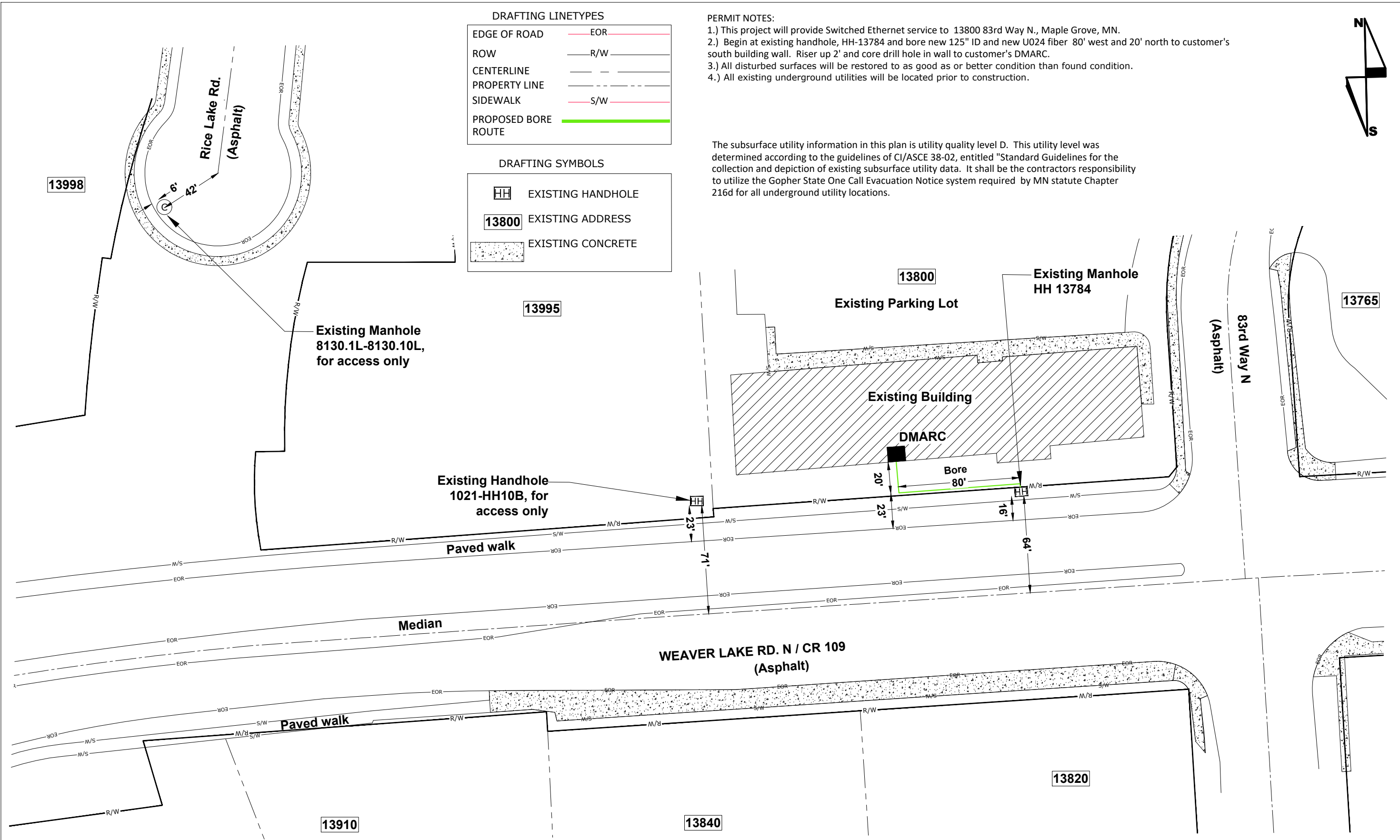

13800 83rd Way N  
 NORTH MEMORIAL SLEEP CENTER  
 HENNEPIN COUNTY  
 CITY PERMIT SKETCH - Maple Grove, MN



ENGINEER: CENTURYLINK  
 CPA/CONTRACTOR: CENTURYLINK/TELCOM  
 DRAWN BY: TELCOM CONSTRUCTION

PROJECT: N.634670 WIRE CENTER: OSSEO (OSSEMNXO)  
 1.) LOCATE ALL UTILITIES BEFORE DIGGING  
 2.) POT HOLE ALL BURIED UTILITY CROSSINGS  
 3.) SEE NOTES ABOVE  
 SHEET: 01 OF 01 REV: 00 DATE: 11/08/2019

SCALE: 1"=60'