

**DRAFTING LINETYPES**

EDGE OF ROAD	— EOR —
ROW	— R/W —
CENTERLINE	— — — —
PROPERTY LINE	- - - - -
RAILROAD TRACK	+ + + + +
PROPOSED BORE ROUTE	— — — —
ROUTE THROUGH EXISTING DUCT	— — — —

**DRAFTING SYMBOLS**

	EXISTING HANDHOLE
	EXISTING PEDESTAL
	PROPOSED HANDHOLE
	EXISTING ADDRESS
	EXISTING CONCRETE

**PERMIT NOTES:**

- 1.) This project will provide Switched Ethernet service to 10949 91st Ave. N, Maple Grove, MN.
- 2.) Begin at existing handhole, HH-845-HH10. Bore new 1.25" ID and new U072 fiber 14' north and 351' east to existing 4" duct at railroad crossing. Jet new U072 fiber 60' east. Bore new 1.25" ID and new U024 fiber 205' to customer's north property line and place new 30"x48" handhole, HH 10949-91 over duct. Bore new 1.25" ID and new U024 fiber 96' east and 263' south to an existing pedestal. Jet new fiber 10' west through existing CBO to customer's DMARC.
- 3.) All disturbed surfaces will be restored to as good as or better condition than found condition.
- 4.) All existing underground utilities will be located prior to construction.

The subsurface utility information in this plan is utility quality level D. This utility level was determined according to the guidelines of CI/ASCE 38-02, entitled "Standard Guidelines for the collection and depiction of existing subsurface utility data. It shall be the contractors responsibility to utilize the Gopher State One Call Evacuation Notice system required by MN statute Chapter 216d for all underground utility locations.

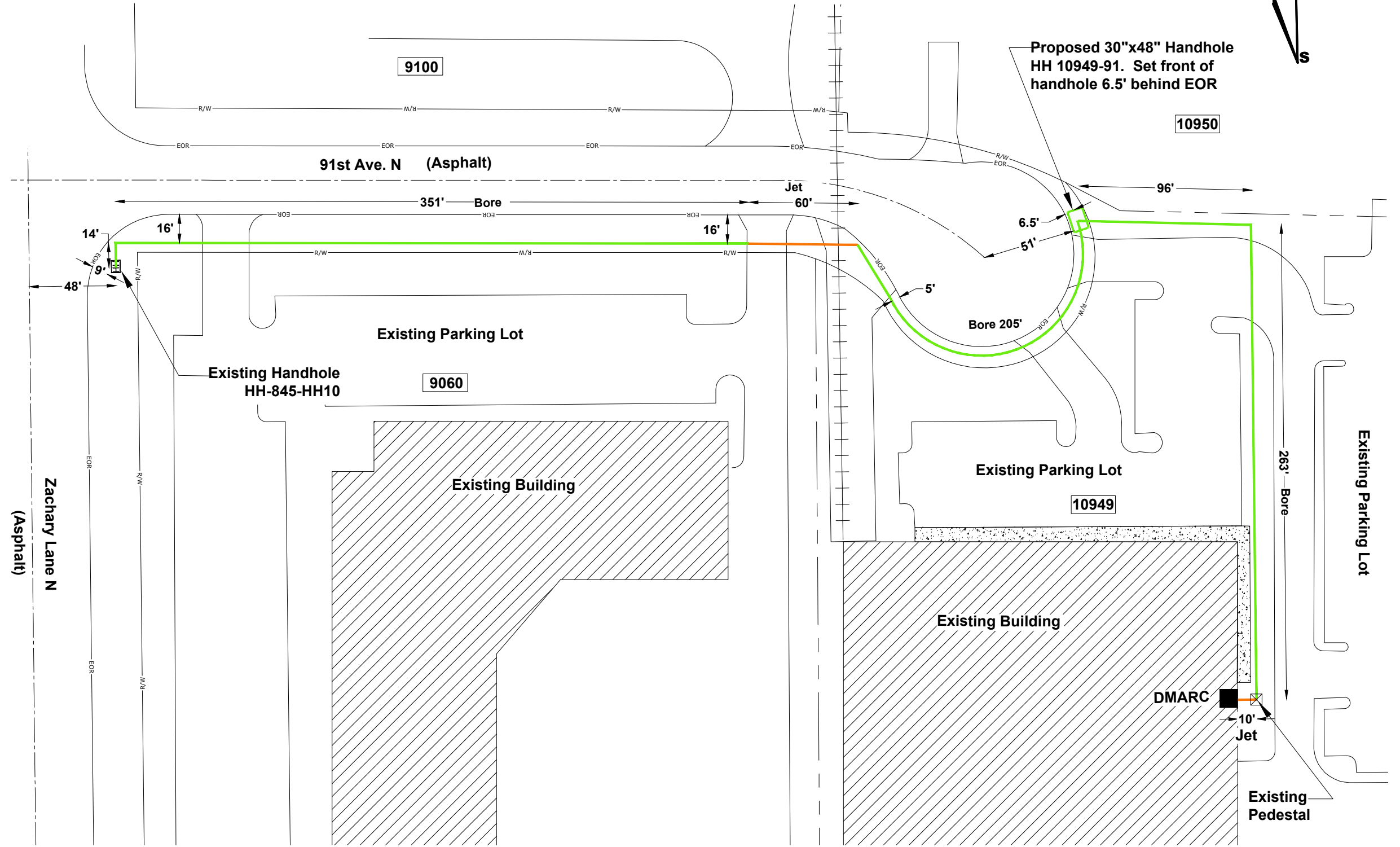

10949 91st Ave. N  
 CONAGRA BRANDS  
 HENNEPIN COUNTY  
 CITY PERMIT SKETCH - Maple Grove, MN

SCALE: 1"=60'



ENGINEER: CENTURYLINK  
 CPA/CONTRACTOR: CENTURYLINK/TELCOM  
 DRAWN BY: TELCOM CONSTRUCTION

PROJECT: N.632654 WIRE CENTER: OSSEO (OSSEMNXO)  
 1.) LOCATE ALL UTILITIES BEFORE DIGGING  
 2.) POT HOLE ALL BURIED UTILITY CROSSINGS  
 3.) SEE NOTES ABOVE  
 SHEET: 01 OF 01 REV: 01 DATE: 11/08/2019