

**9103 RICE LAKE RD
SET PEDESTAL FOR 120V SVC
FOR MONUMENT LIGHT.**

ECK063 -13.8KV (1/2)

**Restoration
Restore grassy area
at pedestal location.**

**Set pedestal P1 K02 at base of pole.
Run wire down pole and make connections
for a 120v monument light service.**

**Existing service burned the feeder pole down
last winter. Located across from 9080 Rice Lk Rd.**

Electrician-
Robert Nelson w/ Nelson Electric
763-444-1523

Designer-
John Pfothenauer
763-493-1876; 612-963-3804

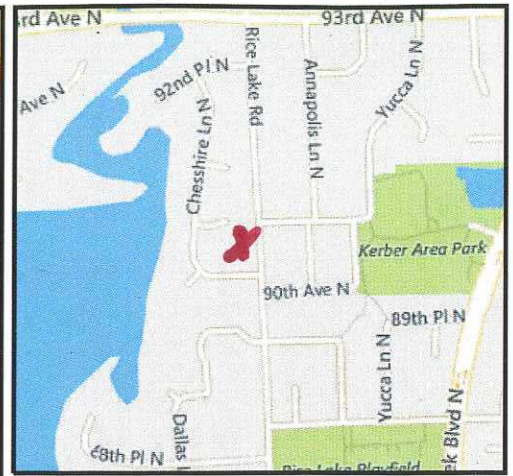

Work Order Information	
Service Request #	:
Design Number	: 00000900775
Designer/Planner ID	: pftj01
Designer/Planner Name	: Pfothenauer, John
Designer/Planner Ph #	: (763) 493-1876
Manager Approval	:

Joint Utility	
E:	G:
T:	C:

Design Location	
Division	: Maple Grove
County	: HENNEPIN
City	: MAPLE GROVE
Address	: 9103 RICE LAKE RD
T: 119N	R: 22W S: 15
Map #	: K52036 Permit :

Electric	
Feeder: ECK063	Voltage: 13.8KV
Phase: ABC	Bkup Dev ID:

Gas	
System :	Pressure :
Size :	Material :
Dead End :	

Work Order # :
Date: 10/09/2019
Sketch: 1 Of 1 Sketch Data
Scale: 1" equals 100'



CONSTRUCTION USE ONLY

NO CHANGES (BUILT AS DESIGNED)
 CHANGES MADE AS INDICATED
(ALL URD MUST HAVE ACTUAL MEASUREMENTS FROM THE FIELD SITE)

RFO _____
FOREMAN _____ DATE _____
TEAM LEADER _____

DISCLAIMER: THERE ARE NO REPRESENTATIONS OR WARRANTIES (EXPRESS OR IMPLIED) ABOUT THE ACCURACY OF THIS PRINT. THIS PRINT IS PROVIDED WITH NO CLAIM AS TO PRINT COMPLETENESS, TIMELINESS, ACCURACY OF CONTENT OR USEFULNESS. STATE LAW REQUIRES ANYONE DIGGING, GRADING OR EXCAVATING TO OBTAIN A PRIOR FIELD LOCATE OF ALL UTILITIES; THIS PRINT DOES NOT DISCHARGE THIS REQUIREMENT OR ANY OTHER REQUIREMENT. THE COMPANY AND ITS AFFILIATES ASSUME NO LEGAL RESPONSIBILITY OR LIABILITY FOR THE RECIPIENT'S USE (OR ANY OTHER PARTIES' USE) OF THE PRINT, INCLUDING THE RECIPIENT'S INTENDED PURPOSE IN USING THE PRINT. NO COMPANY EMPLOYEE OR OTHER PARTY HAS BEEN AUTHORIZED TO PROVIDE THIS PRINT FOR PLANNING OR ESTIMATING PURPOSES; RELY ON THIS PRINT AT YOUR OWN RISK. BY ACCEPTING THIS PRINT, THE RECIPIENT & ANY OTHER PARTY RECEIVING A COPY OF THE PRINT ACKNOWLEDGES AND AGREES TO THIS DISCLAIMER. For All Field Locates Call 811