

CUSTOMER APPROVAL OF DESIGN I/C:

SIGNATURE: _____

PRINTED NAME: _____ DATE: _____

Please review Center Point Energy design for installing Natural Gas to your facility. Verify the route of the Service Line and Meter Location on the building. If there is a conflict please contact the Designer or Sales Rep as shown in the Title Block. Before a natural gas service lines can be installed, you must clearly mark all privately-owned underground facilities including: septic tanks, drain fields, sewer lines, water wells, sprinkler systems, invisible fences, electric lines and pipelines. CenterPoint Energy and its representatives are not responsible for damage to these items if they are not clearly marked at time of installation.

WHEN BUTT FUSING TO EXISTING IN-SERVICE POLYETHYLENE, VISUALLY INSPECT FOR THE PRESENCE OF HYDROCARBON PERMEATION IMMEDIATELY AFTER REMOVING FUSION IRON. IF ANY BUBBLING IS IDENTIFIED ON THE HEATED SURFACE, DO NOT JOIN TO NEW PE PIPE. ALLOW TO COOL AND CUT THIS END OFF (12" LENGTH) AND SEND TO THE GOLDEN VALLEY LAB WITH STREET LOCATION AND W.O. #. COMPLETE TIE-IN/EXTENSION USING AN ELECTROFUSION COUPLING(S). DOCUMENT IN FIELD NOTES.

Project area cleared for internal impacts. Pipe being removed is unregulated for disposal if coating does not exist or is non-asbestos. Refer to CNP Construction and Service Manual CS-B-1.110, CS-B-1.330, and CS-B-1.100, for pipe to be abandoned.



PROPRIETARY AND CONFIDENTIAL

91409089

M52900 MAPLE GROVE

ONE CALL:

Hennepin
*NE22 T119/R22
* = this Page

LEGEND:

- ACTIVE
- DESIGNED
- PROPOSED
- ABANDONED
- A ABANDONED

- Interruptible
- Existing
- Normal
- Future
- Proposed

Address: 13250 GROVE DR
Customer: GROVE DRIVE REDEVELOPMENT
Contact Person: BOB BRAMSTEDT
Contact Phone: 651-295-0127
Sales Rep: SHELLY HOUDE
Sales Rep Phone: 763-785-5428
Construction Hotline: 612-321-5310
Copies To Pipeline Integrity: No
Curb Valve: No
Copies to Corrosion: No
Corrosion Approval: None
Follow Internal Pipe Sampling Requirements? No
GFIP#: NA
Permits: CITY
Requested Install Date: 10-13-19
Approval: **BMJ - 9/13/19**

PROJECT DESCRIPTION:
GROVE DRIVE REDEVELOPMENT

DESIGNER: Ronald McKibbon
PHONE #: 612-321-5492
DRAWN BY: Ronald McKibbon
DESIGN DATE: 9/13/2019

Revised Print
Destroy All Others
Revision History
Date:
Description:
Design Approval:

IC Services 1" : 80'
SCAN DATE: SHEET 1 OF 1

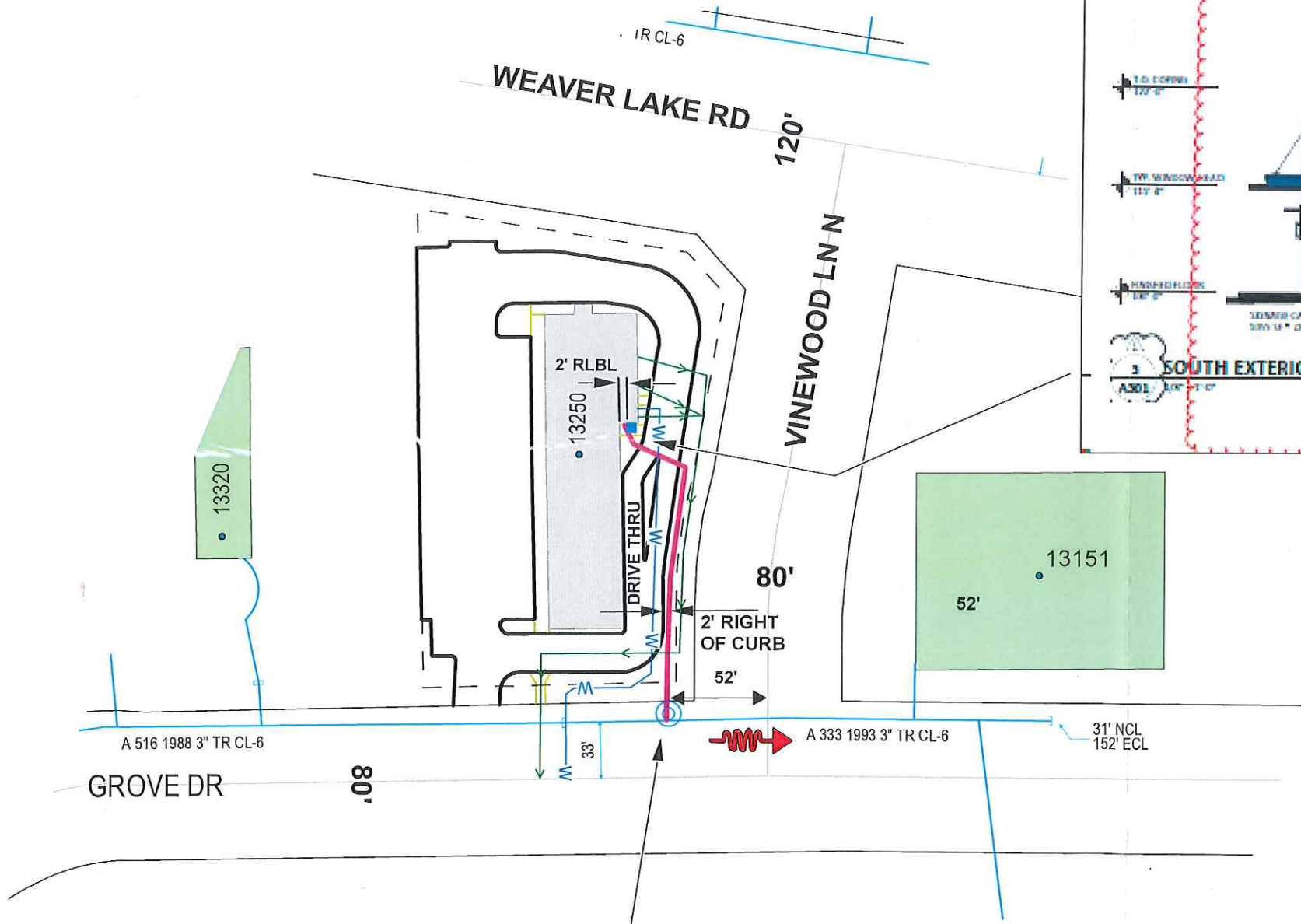

STE A (DENTAL)
METER W/O# 91409022 - I/C Move-in Small Meter Install-Original - CSV
* INSTALL 1-1/4" RISER TEE OFF RISER *
INSTALL: 425TC OSM ERT'D METERSET (CL-6 357CFH) BELOW
W/ 3/4" X 1" 1813C REG @2#PSI, W/ 3/16" ORIFICE
INSTALL: 1-1/4" CUSTOMER BALL VALVE ON OUTLET OF METER
TAG METER AS: STE A (DENTAL)
OFF 1-1/4" STYLE F ANODELESS RISER W/BYPASS, W/SLEEVE
MTRSET EQUIP# 15302922

STE B - CARIBOU
METER W/O# 91409027 - I/C Move-in Small Meter Install-Original - CSV
* OFF 1-1/4" RISER TEE OFF RISER ABOVE OTHER METER *
INSTALL: 425TC OSM ERT'D METERSET (CL-6 357CFH) ABOVE
W/ 3/4" X 1" 1813C REG @2#PSI, W/ 3/16" ORIFICE
INSTALL: 1-1/4" CUSTOMER BALL VALVE ON OUTLET OF METER
TAG METER AS: STE B (CARIBOU)
OFF 1-1/4" STYLE F ANODELESS RISER W/BYPASS, W/SLEEVE
MTRSET EQUIP# 15302923

SVC W/O# 91409089 - Install New I/C Service Line - Plastic - CSV
INSTALL: 3"IPS X 1-1/4" IPS PE2406/2708 SVC TEE W/ .8" TAP
@ 33' NCL GROVE DR, 52' WCL VINEWOOD LN N
INSTALL: 1-1/4"IPS, SDR 10, 5500SCFH EFVB VALVE OFF TEE
INSTALL: 180' OF 1-1/4" IPS PE 2406/2708 CL-6 SVC LINE
W/ 1-1/4" STYLE F ANODELESS RISER W/ BYPASS, W/SLEEVE
@ 2' RLBL ON SOUTH WALL
SVC EQUIP# 64770629

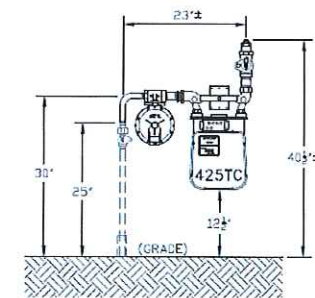

ELEVATION VIEW
425TC METER, 3/4"x1" 1813C REGULATOR

DESIGNER EXPRESS DESIGN

9/13/2019 4:27:51 PM