

DRAFTING LINETYPES

EDGE OF ROAD	— EOR —
ROW	— R/W —
CENTERLINE	— —
SIDEWALK	— S/W —
PROPERTY LINE	- - - - -

DRAFTING SYMBOLS

	EXISTING HANDHOLE
	EXISTING ADDRESS

PERMIT NOTES:

- 1.) This IP Connect project will provide Switched Ethernet service to 6820 Wedgewood Road N, Maple Grove, MN.
- 2.) This is a splicing job only. Begin at existing handhole HH 1422-HH15 and push new fiber south to customer's DMARC.
- 3.) All disturbed surfaces will be restored to as good as or better condition than found condition.
- 4.) All existing underground utilities will be located prior to construction.

The subsurface utility information in this plan is utility quality level D. This utility level was determined according to the guidelines of CI/ASCE 38-02, entitled "Standard Guidelines for the collection and depiction of existing subsurface utility data. It shall be the contractors responsibility to utilize the Gopher State One Call Evacuation Notice system required by MN statute Chapter 216d for all underground utility locations.

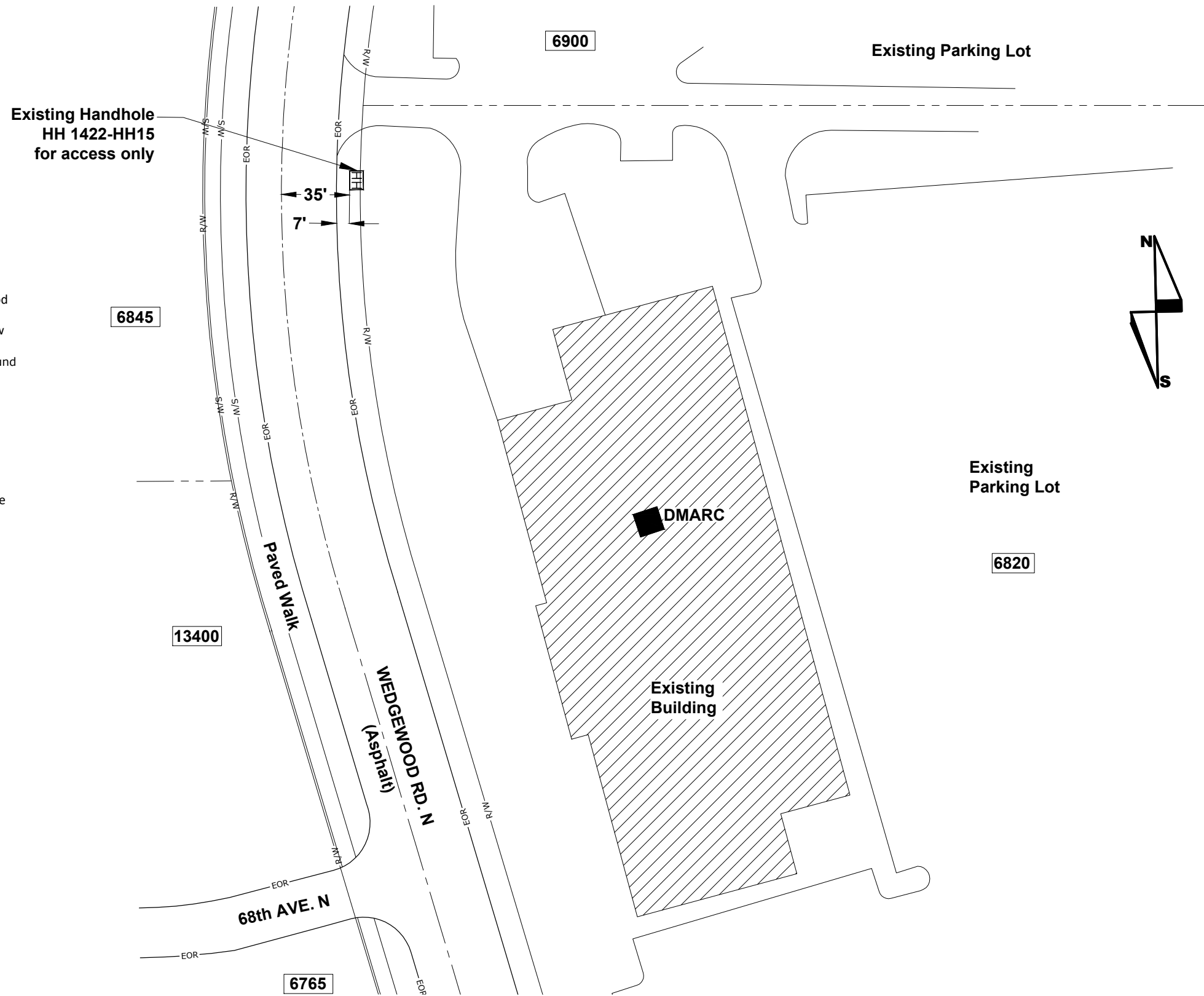

6820 Wedgewood Rd. N  
 ABO TT LABORATORIES  
 HENNEPIN COUNTY  
 CITY PERMIT SKETCH - Maple Grove, MN

SCALE: 1"=60'



ENGINEER: CENTURYLINK  
 CPA/CONTRACTOR: CENTURYLINK/TELCOM  
 DRAWN BY: TELCOM CONSTRUCTION

PROJECT: N.592585 WIRE CENTER: MAPLE GROVE (MPGVMNXB)  
 1.) LOCATE ALL UTILITIES BEFORE DIGGING  
 2.) POT HOLE ALL BURIED UTILITY CROSSINGS  
 3.) SEE NOTES ABOVE  
 SHEET: 01 OF 01 REV: 00 DATE: 08/27/2019