

DRAFTING LINETYPES	
EDGE OF ROAD	— EOR —
ROW	— R/W —
CENTERLINE	- - - - -
PROPERTY LINE	- · - · - · -
SIDEWALK	— S/W —

DRAFTING SYMBOLS	
	EXISTING HANDHOLE
	EXISTING ADDRESS

- PERMIT NOTES:
- 1.) This IP Connect project will provide Switched Ethernet service to 18755 70th Way N, Maple Grove, MN.
 - 2.) This is a splicing job only. Begin at existing handhole, HH 241205-HH4 on the northwest corner of County Road 116 and County Road 10. Place 200' of U072 fiber stub. Push county on existing fiber from existing handhole 241205-HH4 to customer's DMARC.
 - 3.) All disturbed surfaces will be restored to as good as or better condition than found condition.
 - 4.) All existing underground utilities will be located prior to construction.
 - 5.) See Sheets 2 - 5 for Access Only structure locations.

The subsurface utility information in this plan is utility quality level D. This utility level was determined according to the guidelines of CI/ASCE 38-02, entitled "Standard Guidelines for the collection and depiction of existing subsurface utility data. It shall be the contractors responsibility to utilize the Gopher State One Call Evacuation Notice system required by MN statute Chapter 216d for all underground utility locations.

18755 70th Way N
 ALLINA HEALTH
 HENNEPIN COUNTY
 CITY PERMIT SKETCH - Maple Grove, MN

SCALE: 1"=100'



ENGINEER: CENTURYLINK
 CPA/CONTRACTOR: CENTURYLINK/TELCOM
 DRAWN BY: TELCOM CONSTRUCTION

PROJECT: N.592589 WIRE CENTER: MAPLE GROVE WEAVER LAKE (MPGVMNXB)
 1.) LOCATE ALL UTILITIES BEFORE DIGGING
 2.) POT HOLE ALL BURIED UTILITY CROSSINGS
 3.) SEE NOTES ABOVE
 SHEET: 01 REV: 00 DATE: 08/23/2019

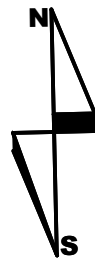

DRAFTING LINETYPES

EDGE OF ROAD	— EOR —
ROW	— R/W —
CENTERLINE	— C/L —
PROPERTY LINE	— P/L —
SIDEWALK	— S/W —

DRAFTING SYMBOLS

	EXISTING HANDHOLE
	EXISTING ADDRESS

Existing Handhole,
HH-2TL for access only.
58' east of C/L
19' east of EOR

Existing Handhole,
HH 1313-HH15 for
access only.
74' east of C/L
26' east of EOR

Existing Handhole,
HH 728LR for
access only.
20' east of C/L
4' east of EOR

See sheet 1 for
more detail.

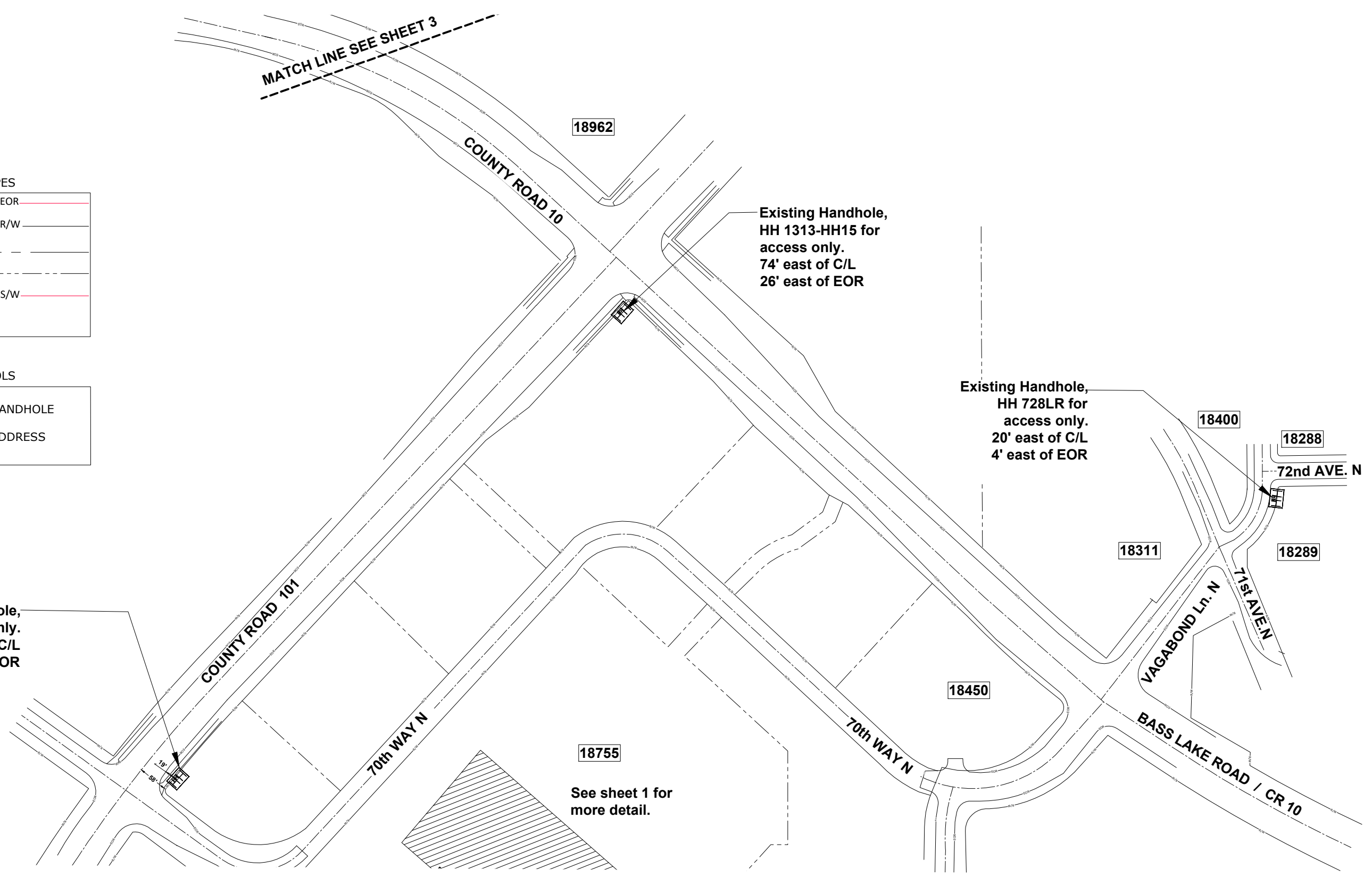

18755 70th Way N
ALLINA HEALTH
HENNEPIN COUNTY
CITY PERMIT SKETCH - Maple Grove, MN

SCALE: 1"=200'



CenturyLink™

ENGINEER: CENTURYLINK

CPA/CONTRACTOR: CENTURYLINK/TELCOM

DRAWN BY: TELCOM CONSTRUCTION

PROJECT: N.592589 WIRE CENTER: MAPLE GROVE WEAVER LAKE (MPGVMNXB)

- 1.) LOCATE ALL UTILITIES BEFORE DIGGING
- 2.) POT HOLE ALL BURIED UTILITY CROSSINGS
- 3.) SEE NOTES ABOVE

SHEET: 02 REV: 00 DATE: 08/23/2019

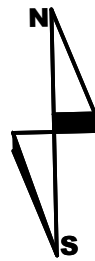

DRAFTING LINETYPES	
EDGE OF ROAD	— EOR —
ROW	— R/W —
CENTERLINE	— — —
PROPERTY LINE	— · — · —
SIDEWALK	— S/W —

DRAFTING SYMBOLS	
	EXISTING HANDHOLE
	EXISTING ADDRESS

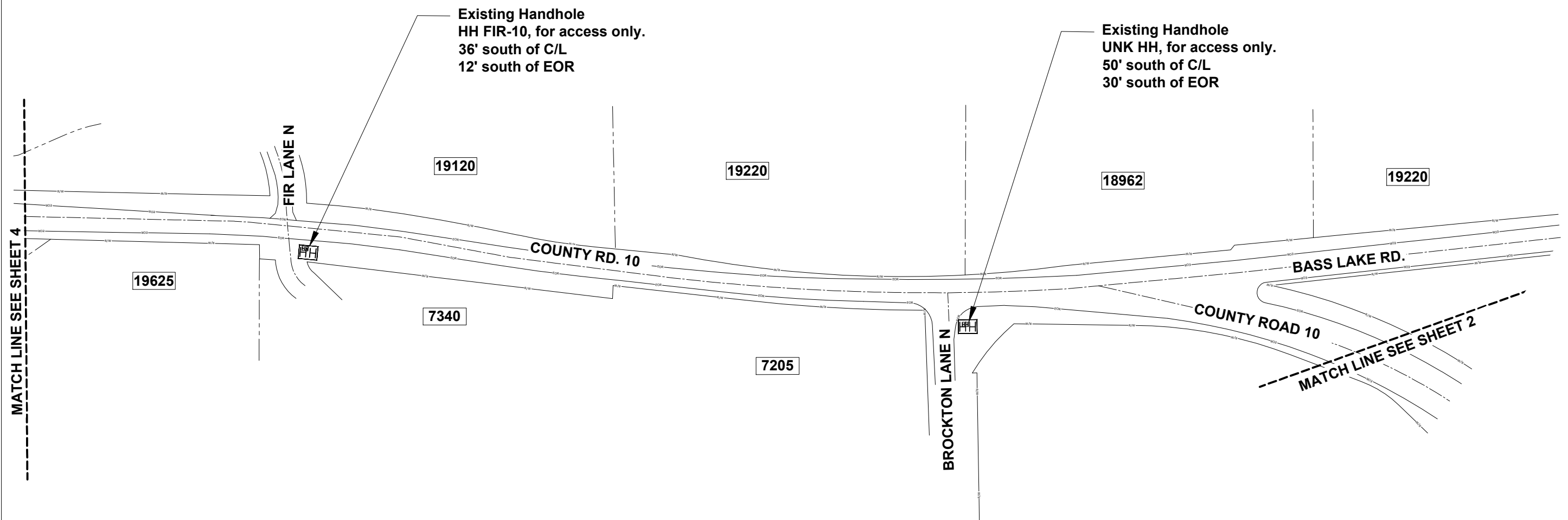

18755 70th Way N
 ALLINA HEALTH
 HENNEPIN COUNTY
 CITY PERMIT SKETCH - Maple Grove, MN

SCALE: 1"=200'



ENGINEER: CENTURYLINK
 CPA/CONTRACTOR: CENTURYLINK/TELCOM
 DRAWN BY: TELCOM CONSTRUCTION

PROJECT: N.592589 WIRE CENTER: MAPLE GROVE WEAVER LAKE (MPGVMNXB)
 1.) LOCATE ALL UTILITIES BEFORE DIGGING
 2.) POT HOLE ALL BURIED UTILITY CROSSINGS
 3.) SEE NOTES ABOVE
 SHEET: 03 REV: 00 DATE: 08/23/2019



Hennepin County Property Map

Date: 8/26/2019



PARCEL ID: 3011922330003

OWNER NAME: Hy-Vee Inc

PARCEL ADDRESS: 18755 70th Way N, Maple Grove MN 55311

PARCEL AREA: 11.19 acres, 487,257 sq ft

A-T-B: Abstract

SALE PRICE:

SALE DATA:

SALE CODE:

ASSESSED 2018, PAYABLE 2019

PROPERTY TYPE: Vacant Land-Commercial

HOMESTEAD: Non-Homestead

MARKET VALUE: \$3,414,300

TAX TOTAL: \$120,345.28

ASSESSED 2019, PAYABLE 2020

PROPERTY TYPE: Commercial-preferred

HOMESTEAD: Non-homestead

MARKET VALUE: \$4,692,900

Comments:

This data (i) is furnished 'AS IS' with no representation as to completeness or accuracy; (ii) is furnished with no warranty of any kind; and (iii) is not suitable for legal, engineering or surveying purposes. Hennepin County shall not be liable for any damage, injury or loss resulting from this data.

COPYRIGHT © HENNEPIN
COUNTY 2019