

SCALE: NTS

CENTURYLINK ENGINEER: SHAWN NIESS  
TELEPHONE: 651-312-5389  
EMAIL: SHAWN.NIESS@CENTURYLINK.COM

CENTURYLINK CPA: MARCIE DEMAIO  
TELEPHONE: 651-312-5265  
EMAIL: MARCIE.DEMAIO@CENTURYLINK.COM

PROJECT NUMBER: N.582190  
SITE ADDRESS: 11852 ELM CREEK BLVD N, MAPLE GROVE, MN  
COUNTY: CROW WING  
SECTION: 23, TOWN: 119N, RANGE: 22W  
COORDINATES: 45.094760, -93.426739

GOODMAN NETWORKS

# PERMIT DRAWING

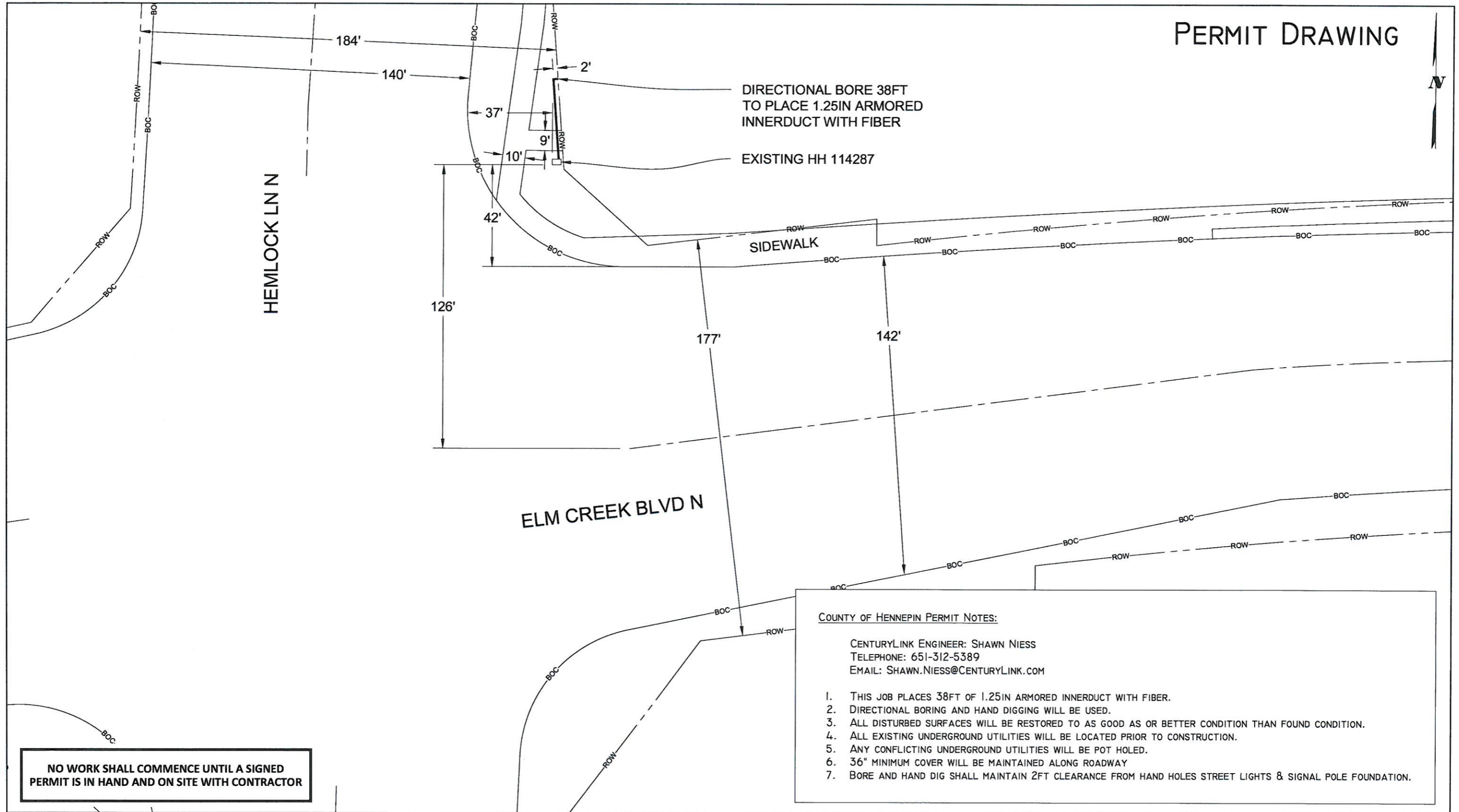

**NO WORK SHALL COMMENCE UNTIL A SIGNED PERMIT IS IN HAND AND ON SITE WITH CONTRACTOR**

**COUNTY OF HENNEPIN PERMIT NOTES:**

CENTURYLINK ENGINEER: SHAWN NIESS  
 TELEPHONE: 651-312-5389  
 EMAIL: SHAWN.NIESS@CENTURYLINK.COM

1. THIS JOB PLACES 38FT OF 1.25IN ARMORED INNERDUCT WITH FIBER.
2. DIRECTIONAL BORING AND HAND DIGGING WILL BE USED.
3. ALL DISTURBED SURFACES WILL BE RESTORED TO AS GOOD AS OR BETTER CONDITION THAN FOUND CONDITION.
4. ALL EXISTING UNDERGROUND UTILITIES WILL BE LOCATED PRIOR TO CONSTRUCTION.
5. ANY CONFLICTING UNDERGROUND UTILITIES WILL BE POT HOLED.
6. 36" MINIMUM COVER WILL BE MAINTAINED ALONG ROADWAY
7. BORE AND HAND DIG SHALL MAINTAIN 2FT CLEARANCE FROM HAND HOLES STREET LIGHTS & SIGNAL POLE FOUNDATION.



PERMITS REQUIRED: COUNTY OF HENNEPIN  
 W/C: MPGVMN  
 CPA: MDEMAIO

CONTACT PERSON: SHAWN NIESS  
 PHONE: 651-312-5389  
 FAX:  
 EMAIL: SHAWN.NIESS@CENTURYLINK.COM

JOB: N.582190  
 LOC.: 11852 ELM CREEK BLVD,  
 MAPLE GROVE, MN

DRAWING SYMBOLS			
	STREET LIGHT		FIRE HYDRANT
	VALVE		MANHOLE
	STORM DRAIN		UTILITY POLE
	PED/CABINET		TREE

0' 40'

SCALE: 1" = 40'

SHEET: 2 OF 2