

Needs permit

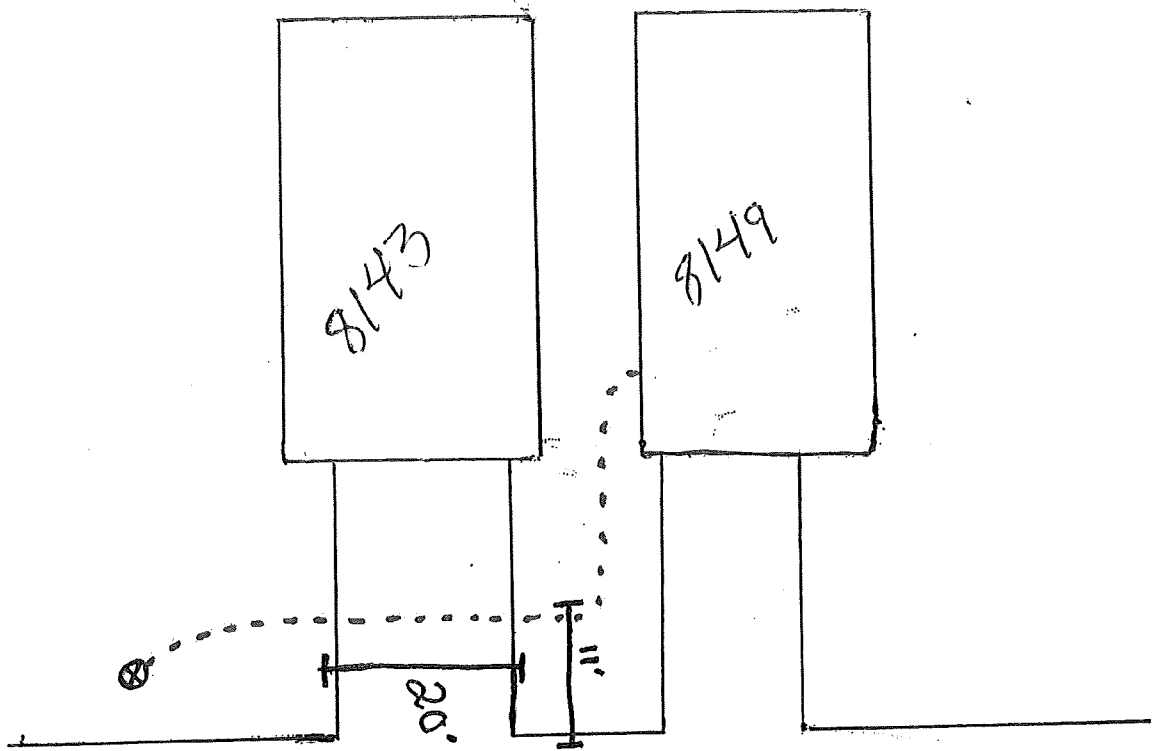

Arrowwood lane



8149 Arrowwood lane n
w.g. P&F
Need to leave neighbor's
Driveway



Hennepin County Property Map

Date: 8/7/2019



PARCEL ID: 2311922140121

OWNER NAME: Drp Mn 1 Llc

PARCEL ADDRESS: 8149 Arrowwood La N,
Maple Grove MN 55369

PARCEL AREA: 0.06 acres, 2,604 sq ft

A-T-B: Abstract

SALE PRICE:

SALE DATA:

SALE CODE:

ASSESSED 2018, PAYABLE 2019

PROPERTY TYPE: Vacant Land-Residential

HOMESTEAD: Non-Homestead

MARKET VALUE: \$36,700

TAX TOTAL: \$606.90

ASSESSED 2019, PAYABLE 2020

PROPERTY TYPE: Vacant Land-residential

HOMESTEAD: Non-homestead

MARKET VALUE: \$79,600

Comments:

This data (i) is furnished 'AS IS' with no representation as to completeness or accuracy; (ii) is furnished with no warranty of any kind; and (iii) is not suitable for legal, engineering or surveying purposes. Hennepin County shall not be liable for any damage, injury or loss resulting from this data.

COPYRIGHT © HENNEPIN
COUNTY 2019

Google Maps 8149 Arrowwood Ln N

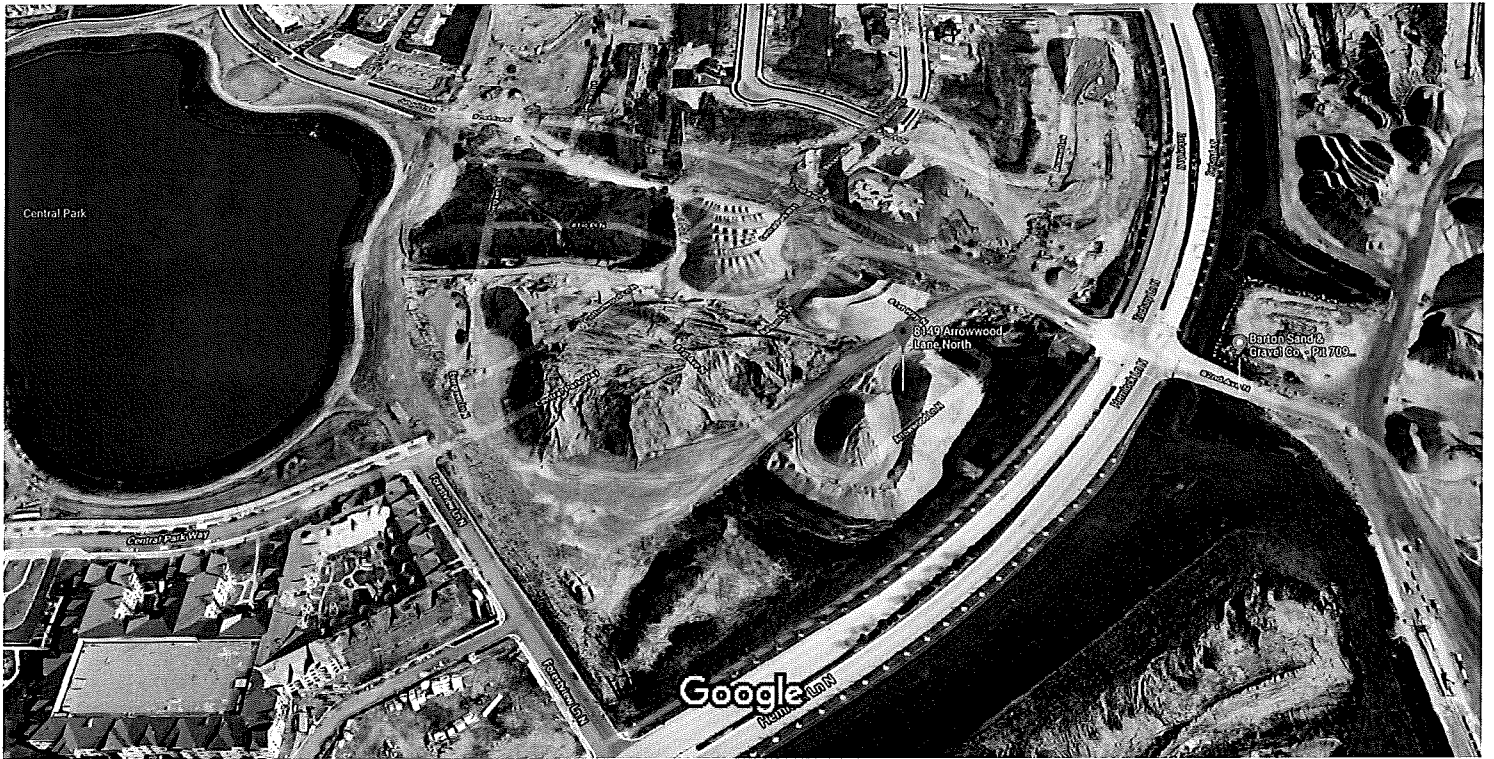

Imagery ©2019 Google, Map data ©2019 100 ft



8149 Arrowwood Ln N

Maple Grove, MN 55369



Directions



Save



Nearby



Send to your phone



Share



4H3F+2W Maple Grove, Minnesota