

DRAFTING SYMBOLS

	EXISTING HANDHOLE
	EXISTING PEDESTAL
	EXISTING ADDRESS
	EXISTING SIDEWALK
	EXISTING PAVED WALK

DRAFTING LINETYPES

EDGE OF ROAD	— EOR
ROW	— R/W
CENTERLINE	—
PROPERTY LINE	- - - -
PROPOSED BORE ROUTE	—
PROPOSED ROUTE THROUGH EXISTING DUCT	—

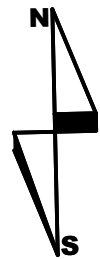

PERMIT NOTES:

- 1.) This IP Connect project will provide Fiber and Data service to 11905 Elm Creek Blvd. N, in the City of Maple Grove, MN.
- 2.) Begin at existing handhole 1233-HH1. Bore new 2" plastic duct and new UO24 fiber 65' east, 165' south and 30' west to meet customer's existing CBO. Then jet new UO24 fiber 21' west to customer's DMARC.
- 3.) All disturbed surfaces will be restored to as good as or better condition than found condition.
- 4.) All existing underground utilities will be located prior to construction.

The subsurface utility information in this plan is utility quality level D. This utility level was determined according to the guidelines of CI/ASCE 38-02, entitled "Standard Guidelines for the collection and depiction of existing subsurface utility data. It shall be the contractors responsibility to utilize the Gopher State One Call Evacuation Notice system required by MN statute Chapter 216d for all underground utility locations.

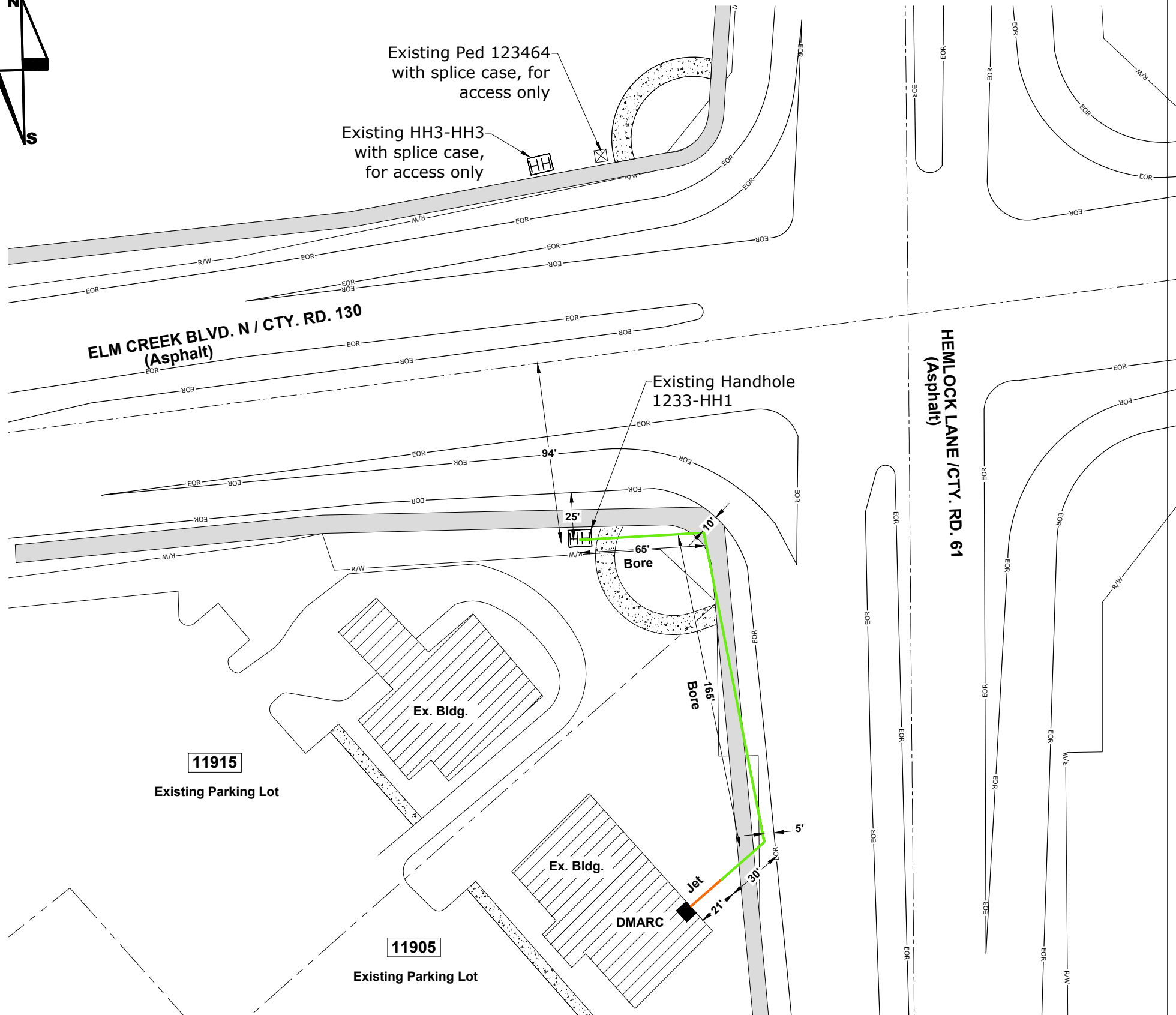

11905 Elm Creek Blvd. N  
 JARED JEWELRY  
 HENNEPIN COUNTY  
 CITY PERMIT SKETCH - MAPLE GROVE, MN

SCALE: 1"=60'



ENGINEER: CENTURYLINK  
 CPA/CONTRACTOR: CENTURYLINK/TELCOM  
 DRAWN BY: TELCOM CONSTRUCTION

PROJECT: N.586566 WIRE CENTER: OSSEO (OSSEMNXO)  
 1.) LOCATE ALL UTILITIES BEFORE DIGGING  
 2.) POT HOLE ALL BURIED UTILITY CROSSINGS  
 3.) SEE NOTES ABOVE  
 SHEET: 01 OF 01 REV:01 DATE:8/02/2019