

Revised 4-6-18		CMS#	19128391 HELD PERMIT	
CenturyLink BSW Order/Maintenance Work Authorization				
Company	T600	Exchange Name	MAPLE GROVE	
Work Activity	Fiber-Buried	Capital	Y	Service Order# 1520447692
Customer Name	Gilbert Aurelus		Phone#	
Address	18465 70th Ave N		One Call Ticket#	
City & Zip	Maple Grove, MN			
Location/Directions	SPRINGTIME PREBURY			
Description of Work or Special Instructions				

Held Order	Y	Permit:	Y	Bore:	Y	CBR#	763-807-0943
Tech Name and Tech #	Les Peterson AA09419		Employee Contact#				

Sketch (Include Cntr Line & Pedestal)	Material/Labor Units		Footage/Quantity	Comments
	Description	Notes		
Cntr Line foot	33	SEB3-22	BSW-3 & plow picmt	
		SEB3-221	BSW-3 & hand dig picmt	
Ped#	A0FZ5	SEPCUTOVER	CUTOVER BSW	
Parish/County	Hennep	BM83	BSW guard at house	1
		XXSEB-GL	Remove temp drop	
Township:		BM61(1.25)SEB	BSW Bore footage	150
Section		SEBO PER FT LBR	Fiber & plow picmt	60
Range		SEBO PER FT LBR I	Fiber & hand dig picmt	
		SEB6-22	BSW-6 & plow picmt	
		BM12(5/8)(8)	Ground Rod	
		Trip Charge	Trip Charge	1
		BM61(3)D-Rock CBL	Rock Boring	
		Permit	Permit	1
Nearest cross st.	Vagabond Ln		Plat Page	Map#

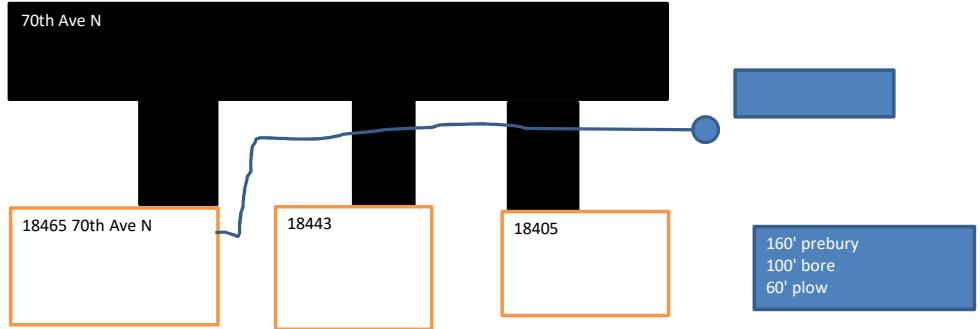

Originated By:		Date:		Completed By:		Date:	
Authorized By: (APS)		Date:		Inspected By:		Date:	
Authorized By: (AOM)		Date:					
Email sketch to:	MetroBSW@Centurylink.com						

1. Distance of the bury in Right-of-Way		3. Distance to the nearest intersection	
2. Distance from the terminal to the centerline		4. Nearest State Hwy mile marker	