

CenturyLink BSW Order/Maintenance Work Authorization

Company	T866	Exchange Name	MAPLE GROVE - MPGVMNXA	Service Order#	
Work Activity	Fiber-Buried	Capital	Y	Maintenance	
Customer Name	Michael Davis			Phone#	7633150227
Address	8320 Deerwood Ln N			One Call Ticket#	
City & Zip	Maple Grove MN				
Location/Directions					

Description of Work or Special Instructions Plow 130 ft of fiber from ped to nid. 80 ft right of way bore required

Held Order	Y	N	Permit:	Y	N	Bore:	Y	N	CBR#	9522502238
Tech Name and Tech #	Donald Evans			Employee Contact#	612-430-3133					

Sketch <small>(Include Cntr Line & Pedestal)</small>	Material/Labor Units Description	Notes	Footage/Quantity	Comments
Cntr Line foot	SEB3-22	BSW-3 & plow plcmt		
	SEB3-22T	BSW-3 & hand dig plcmt		
Ped#	SEPCUTOVER	CUTOVER BSW	1	
Parish/County	BM83	BSW guard at house	1	
	XXSEB-GL	Remove temp drop	1	Footage when temp can't be re-used
Township:	BM61(1.25)SEB	BSW Bore footage	80	
Section	SEBO PER FT LBR	Fiber & plow plcmt		
Range	SEBO PER FT LBR T	Fiber & hand dig plcmt	50	
	SEB6-22	BSW-6 & plow plcmt		
	BM2(5/8)(8)	Ground Rod		
	Trip Charge	Trip Charge	1	
	Permit	Permit	1	Any placement within the ROW requires a permit

Nearest cross st.	Plat Page	Map#
--------------------------	------------------	-------------

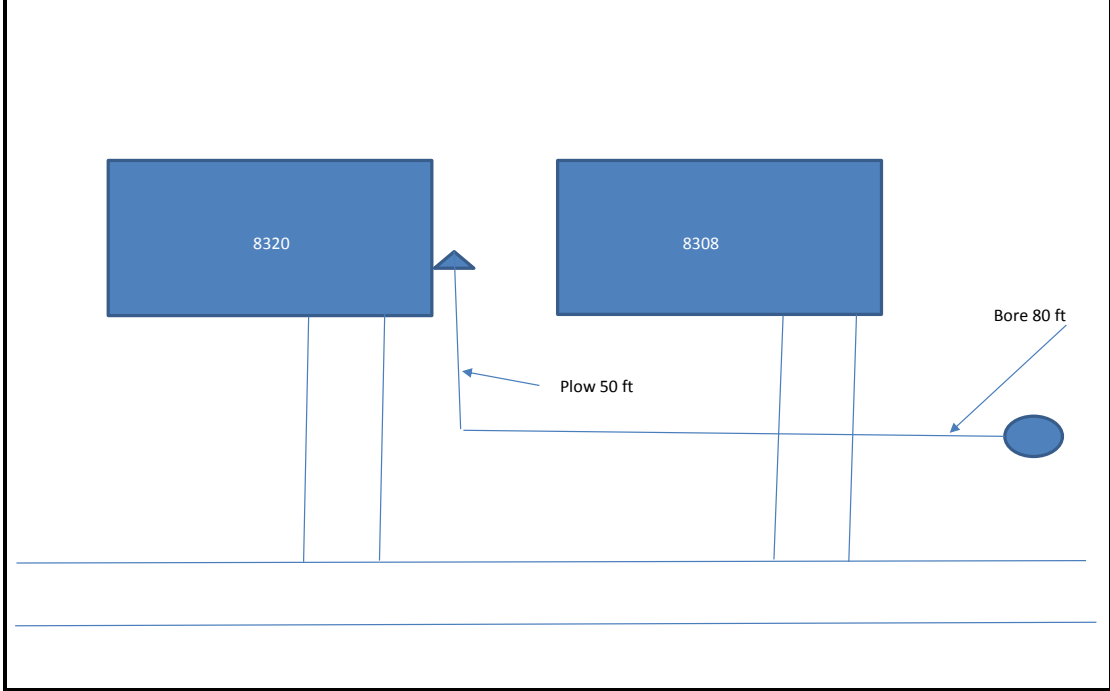

Originated By:	Donald Evans	Date:	7/11/19	Completed By:	
Authorized By: (APS)		Date:		Inspected By:	
Authorized By: (AOM)		Date:			

Email sketch to: MetroBSW@Centurylink.com

1. Distance of the bury in Right-of-Way	3. Distance to the nearest intersection
2. Distance from the terminal to the centerline	4. Nearest State Hwy mile marker