

CenturyLink BSW Order/Maintenance Work Authorization

Company	T866	Exchange Name	MAPLE GROVE - MPGVMNXA	Service Order#	
Work Activity	Fiber-Buried	Capital	Y	Maintenance	
Customer Name	Chad Fleck			Phone#	7634164761
Address	11691 86th Ave N			One Call Ticket#	
City & Zip	Maple Grove MN				
Location/Directions					
Description of Work or Special Instructions	Plow 120 ft of fiber from ped to nid. 60 ft of right of way bore required				

Held Order	N	Permit:	Y	Bore:	Y	CBR#	61239100044
Tech Name and Tech #	Donald Evans			Employee Contact#	612-430-3133		

Sketch		Material/Labor Units		Footage/Quantity	Comments
(Include Cntr Line & Pedestal)	Description	Notes			
Cntr Line foot#	SEB3-22	BSW-3 & plow plcmt			
	SEB3-22T	BSW-3 & hand dig plcmt			
Ped#	SEPCUTOVER	CUTOVER BSW		1	
Parish/County	BM83	BSW guard at house		1	
	XXSEB-GL	Remove temp drop		1	Footage when temp can't be re-used
Township:	BM61(1.25)SEB	BSW Bore footage		60	
Section	SEBO PER FT LBR	Fiber & plow plcmt			
Range	SEBO PER FT LBR T	Fiber & hand dig plcmt		65	
	SEB6-22	BSW-6 & plow plcmt			
	BM2(5/8)(8)	Ground Rod			
	Trip Charge	Trip Charge		1	
	Permit	Permit		1	Any placement within the ROW requires a permit

Nearest cross st.		Plat Page		Map#	
-------------------	--	-----------	--	------	--

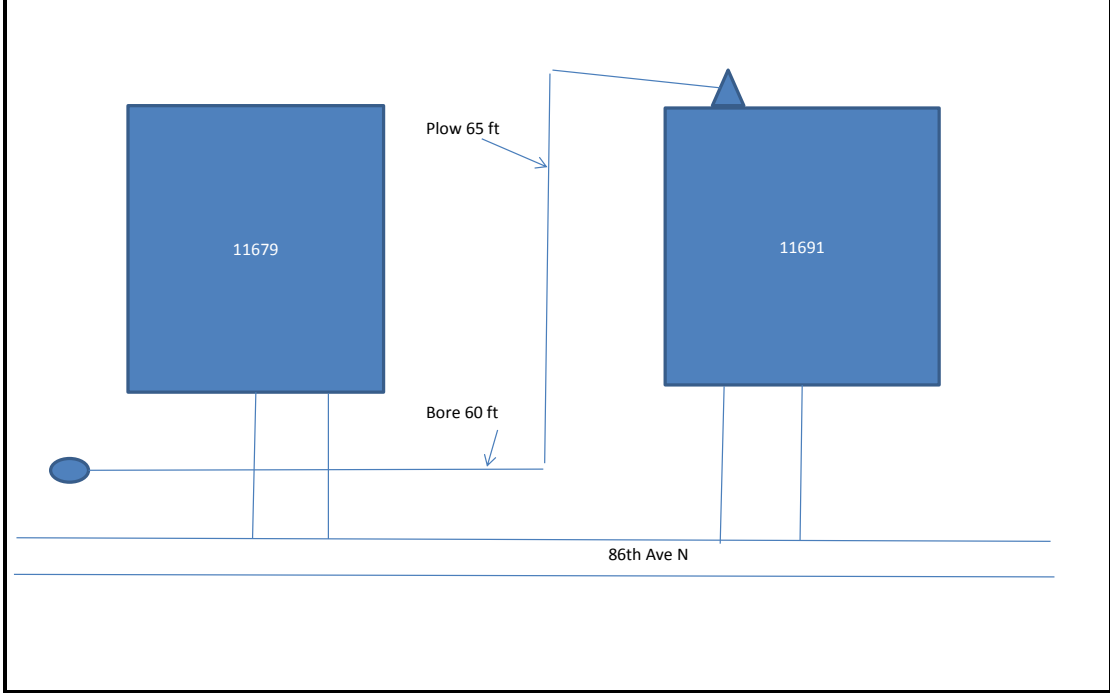

Originated By:	Ryan Einerwold	Date:	6/4/19	Completed By:		Date:	
Authorized By: (APS)		Date:		Inspected By:		Date:	
Authorized By: (AOM)		Date:					

Email sketch to: MetroBSW@Centurylink.com	
1. Distance of the bury in Right-of-Way	3. Distance to the nearest intersection
2. Distance from the terminal to the centerline	4. Nearest State Hwy mile marker