



# Hennepin County Property Map

Date: 6/4/2019



PARCEL ID: 2311922220047

OWNER NAME: Odyssey Homes Inc

PARCEL ADDRESS: 12641 84th PI N, Maple Grove MN 55369

PARCEL AREA: 0.18 acres, 8,000 sq ft

A-T-B: Abstract

SALE PRICE: \$410,000

SALE DATA: 02/2019

SALE CODE: Excluded From Ratio Studies

ASSESSED 2018, PAYABLE 2019

PROPERTY TYPE: Vacant Land-Residential

HOMESTEAD: Non-Homestead

MARKET VALUE: \$57,000

TAX TOTAL: \$942.74

ASSESSED 2019, PAYABLE 2020

PROPERTY TYPE: Residential

HOMESTEAD: Non-homestead

MARKET VALUE: \$452,300

### Comments:

new build

This data (i) is furnished 'AS IS' with no representation as to completeness or accuracy; (ii) is furnished with no warranty of any kind; and (iii) is not suitable for legal, engineering or surveying purposes. Hennepin County shall not be liable for any damage, injury or loss resulting from this data.

COPYRIGHT © HENNEPIN COUNTY 2019

E

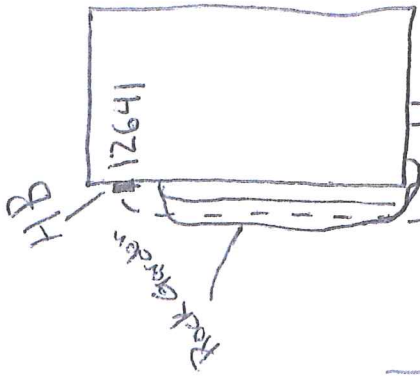
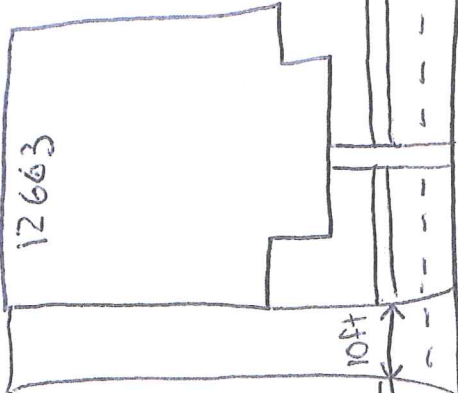

S

Ped

N

84<sup>th</sup> P I N

SWBx3

DWB 10ft

Total drop 208ft

W