

Escalated Cable Replacement
 15236 96TH AVE N
 Feeder: ECL061/C/7.97 KVA
 Directional Bore:
 Bore in 11800' of #2AL 1Ph cable from xfrmer N9 to J9 & from J9 to M7.
 Terminations:
 25 Terminations: M9, L9, K9, J9, M8, L8, K8, J8, H8, D8, E8, F07, D7, E7, F7, G7, H7, N7, J7, K7, L7, M7, D9, E9, P8
 -Replace only bad cable from xfrmer N9 to J9 & from J9 to F08. J9 to D9 & from D9 splice to the xfrmer M7. From xfrmer L7 to K7 splice to xfrmer J7. From N7 to xfrmer H7 splice Restorations

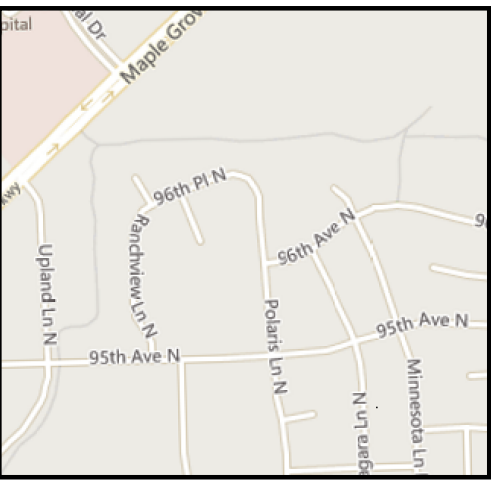

KPATCHA TOYISSON
 651-265-7033

Work Order Information	
Service Request #	:
Design Number	: 000000851102
Designer/Planner ID	: 233215
Designer/Planner Name	: Toyisson, Kpatcha
Designer/Planner Ph #	: (000) 000-0000
Manager Approval	:

Joint Utility	
E:	G:
T:	C:

Design Location	
Division	: Maple Grove
County	: Hennepin
City	: Maple Grove
Address	:
T: 119N	R: 22W S: 9
Map #	: K52014 Permit :

Electric	
Feeder:	Voltage:
Phase:	Bkup Dev ID:

Gas	
System	: Pressure :
Size	: Material :
Dead End	:

Work Order # :

Date: 03/12/2019
 Sketch: # Of # Sketch Data
 Scale: 1" equals 167'

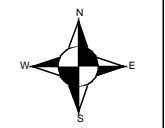

CONSTRUCTION USE ONLY

NO CHANGES (BUILT AS DESIGNED)
 CHANGES MADE AS INDICATED (ALL URD MUST HAVE ACTUAL MEASUREMENTS FROM THE FIELD SITE)

RFO _____
 FOREMAN _____ DATE _____
 TEAM LEADER _____

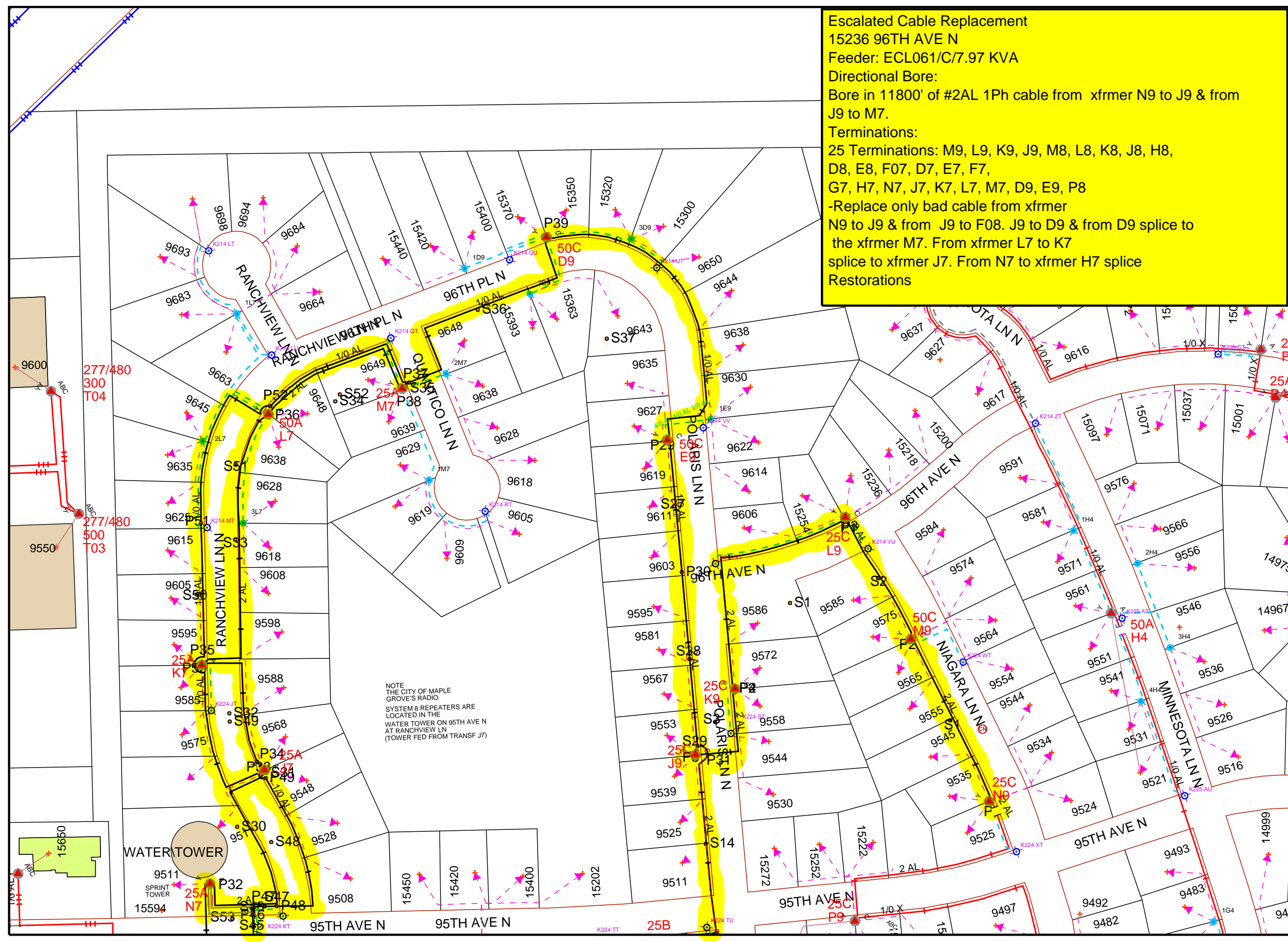

DISCLAIMER: THERE ARE NO REPRESENTATIONS OR WARRANTIES (EXPRESS OR IMPLIED) ABOUT THE ACCURACY OF THIS PRINT. THIS PRINT IS PROVIDED WITH NO CLAIM AS TO PRINT COMPLETENESS, TIMELINESS, ACCURACY OF CONTENT OR USEFULNESS. STATE LAW REQUIRES ANYONE DIGGING, GRADING OR EXCAVATING TO OBTAIN A PRIOR FIELD LOCATE OF ALL UTILITIES; THIS PRINT DOES NOT DISCHARGE THIS REQUIREMENT OR ANY OTHER REQUIREMENT. THE COMPANY AND ITS AFFILIATES ASSUME NO LEGAL RESPONSIBILITY OR LIABILITY FOR THE RECIPIENT'S USE (OR ANY OTHER PARTIES' USE) OF THE PRINT, INCLUDING THE RECIPIENT'S INTENDED PURPOSE IN USING THE PRINT. NO COMPANY EMPLOYEE OR OTHER PARTY HAS BEEN AUTHORIZED TO PROVIDE THIS PRINT FOR PLANNING OR ESTIMATING PURPOSES; RELY ON THIS PRINT AT YOUR OWN RISK. BY ACCEPTING THIS PRINT, THE RECIPIENT & ANY OTHER PARTY RECEIVING A COPY OF THE PRINT ACKNOWLEDGES AND AGREES TO THIS DISCLAIMER. For All Field Locates Call 811