

**CenturyLink BSW Order/Maintenance Work Authorization**

Company	T866	Exchange Name	MAPLE GROVE - MPGVMNXA	Service Order#	
Work Activity	Fiber-Buried	Capital	Y	Maintenance	
Customer Name	David Bejjam			Phone#	7633150470
Address	11790 86th Ave N			One Call Ticket#	
City & Zip	Maple Grove Mn				
Location/Directions					
Description of Work or Special Instructions	Pow 175 ft of fiber from ped to nid. 135 right of way bore required				

Held Order	Y	Permit:	Y	Bore:	Y	CBR#	7633901748
Tech Name and Tech #	Donald Evans			Employee Contact#	612-430-3133		

Sketch		Material/Labor Units		Footage/Quantity	Comments
(Include Cntr Line & Pedestal)	Description	Notes			
Cntr Line footd	SEB3-22	BSW-3 & plow plcmt			
	SEB3-22T	BSW-3 & hand dig plcmt			
Ped#	SEPCUTOVER	CUTOVER BSW		1	
Parish/County	BM83	BSW guard at house		1	
	XXSEB-GL	Remove temp drop		1	Footage when temp can't be re-used
Township:	BM61(1.25)SEB	BSW Bore footage		120	
Section	SEBO PER FT LBR	Fiber & plow plcmt			
Range	SEBO PER FT LBR T	Fiber & hand dig plcmt		30	
	SEB6-22	BSW-6 & plow plcmt			
	BM2(5/8)(8)	Ground Rod			
	Trip Charge	Trip Charge		1	
	Permit	Permit			Any placement within the ROW requires a permit

Nearest cross st.		Plat Page		Map#	
-------------------	--	-----------	--	------	--

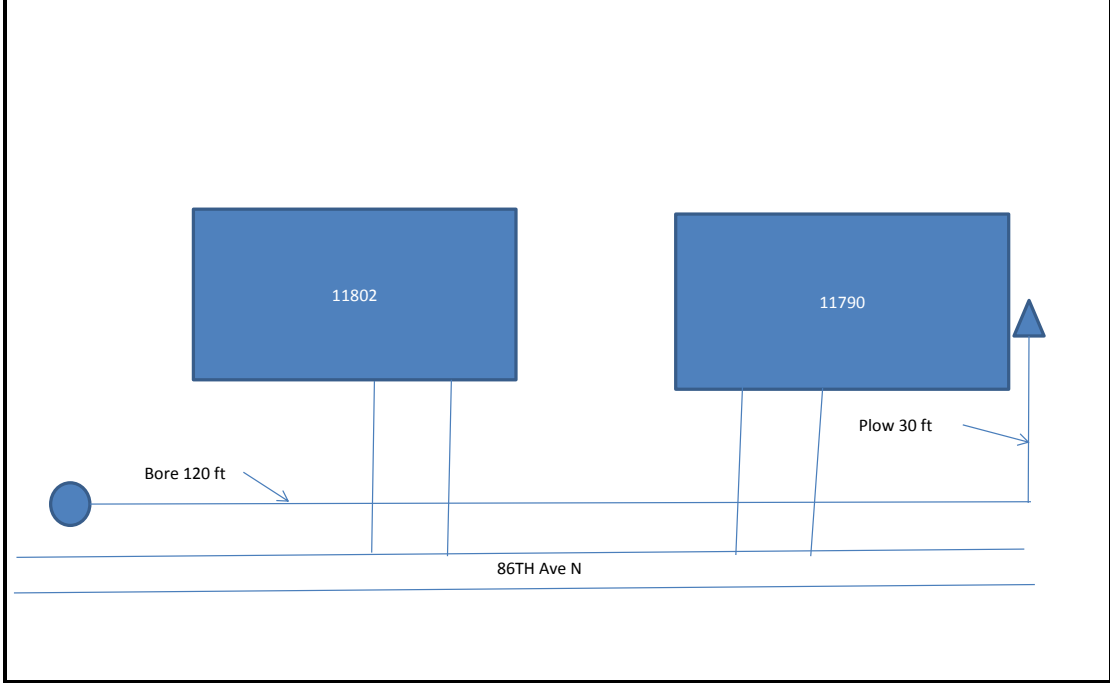

Proceed with order and place temp

This is an estimated dollar amount you can quote the customer. This is not exact and it's only to be used to see if the customer is interested to proceed.

**FALSE**

Originated By:	Donald Evans	Date:	5/6/19	Completed By:		Date:	
Authorized By: (APS)		Date:		Inspected By:		Date:	
Authorized By: (AOM)		Date:					

Email sketch to: [MetroBSW@Centurylink.com](mailto:MetroBSW@Centurylink.com)

1. Distance of the bury in Right-of-Way	3. Distance to the nearest intersection	
2. Distance from the terminal to the centerline	4. Nearest State Hwy mile marker	