

VICINITY MAP

WORK LOCATION

SHEET 2

WINDROSE
 HENNEPIN COUNTY SECTION 30, TOWNSHIP 119, RANGE 22W
 CITY PERMIT - MAPLE GROVE, MN 55311

SCALE: NTS



ENGINEER: **CENTURYLINK**
 LUCAS PELUSO
 PHONE: (952) 465-2925
 E-MAIL: LUCAS.PELUSO1@CENTURYLINK.COM

PROJECT: N.537444
 PERMIT TO PLACE NEW CONDUITS, FIBER
 OPTIC CABLES, PEDESTALS AND HAND HOLES
 SHEET: 01 OF 02 REV: 01 DATE: 5/6/2019

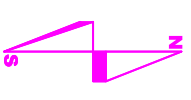

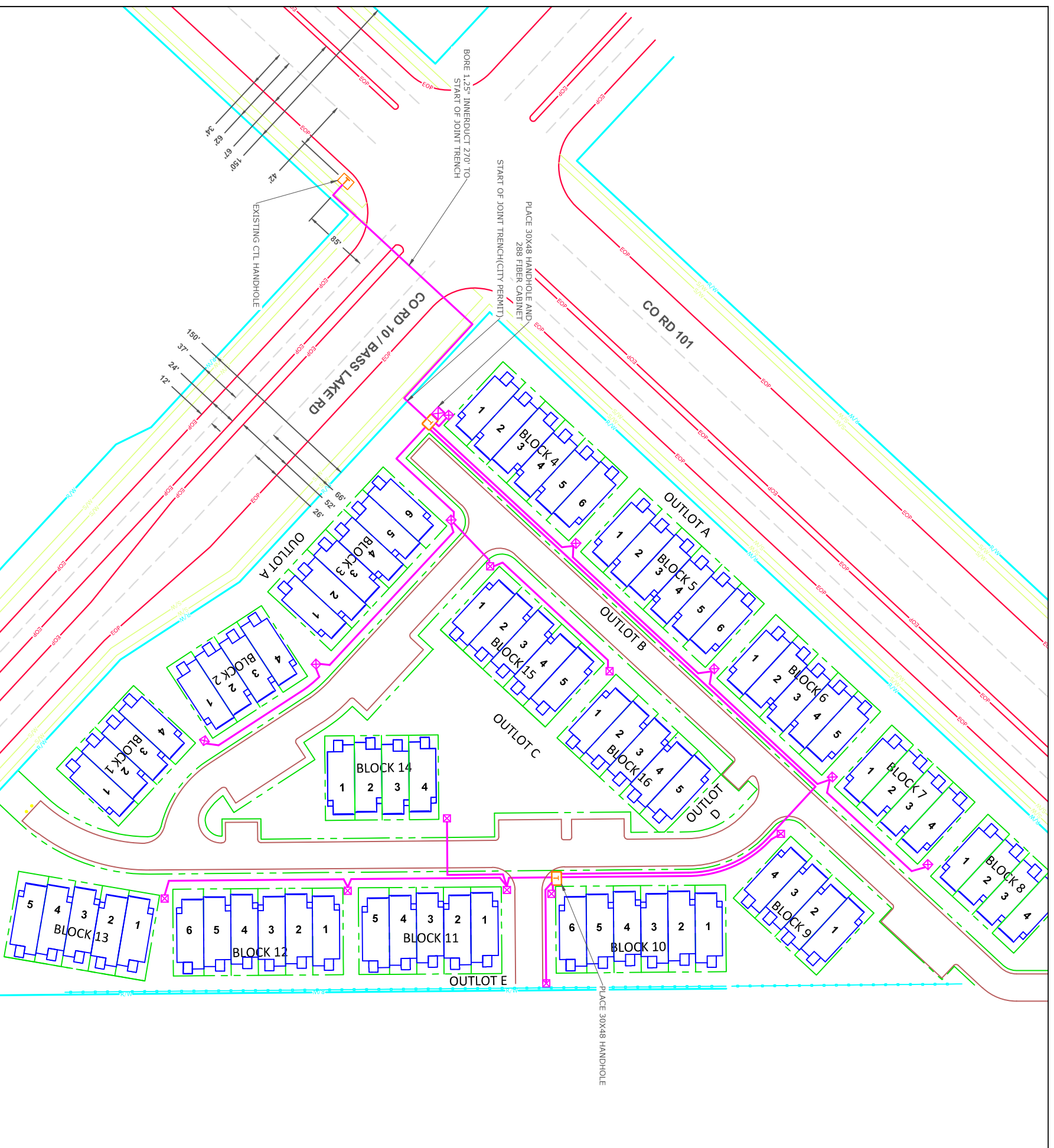

- CONSTRUCTION NOTES:**
- 1) ALL EXISTING UTILITIES WILL BE LOCATED PRIOR TO CONSTRUCTION.
 - 2) ALL DISTURBED SURFACES WILL BE RESTORED TO AS GOOD OR BETTER CONDITION THAN FOUND.
 - 3) JOINT TRENCH WILL DETERMINE EXACT LOCATION OF CABLE PLACEMENT. ALL ROUTES ARE 1.25" INNERDUCT. CROSSINGS ARE PLACED THROUGH 4" PIPE.
 - 4) ALL PEDESTALS PLACED WILL BE 8" PEDS UNLESS OTHERWISE INDICATED.
 - 5) STANDARD UTILITY EASEMENT IS 10', UNLESS OTHERWISE INDICATED.

WINDROSE
 HENNEPIN COUNTY SECTION 30, TOWNSHIP 119, RANGE 22W
 CITY PERMIT - MAPLE GROVE, MN 55311

SCALE: 1:100



ENGINEER: CENTURYLINK
 LUCAS PELUSO
PHONE: (952) 465-2925
E-MAIL: LUCAS.PELUSO1@CENTURYLINK.COM

PROJECT: N.537444
 PERMIT TO PLACE NEW CONDUITS, FIBER OPTIC CABLES, PEDESTALS AND HAND HOLES
SHEET: 02 OF 02 **REV:** 01 **DATE:** 5/6/2019

