

Revised 4-6-18		CMS#	19062279
CenturyLink BSW Order/Maintenance Work Authorization			
Company	T600	Exchange Name	MAPLE GROVE
Work Activity	Fiber-Buried	Capital	Y
Customer Name	Ted Lyons		Service Order#
Address	10024 107th PI N		Phone# 7633154288
City & Zip	Maple Grove Mn		One Call Ticket#
Location/Directions	Plow 190 ft of fiber from ped to nid. 150 ft right of way bore required		

Held Order	N	Permit:	Y	Bore:	Y	CBR#	6124248047
Tech Name and Tech #	Don Evans		Employee Contact#		6124303133		
Sketch	Material/Labor Units			Footage/Quantity	Comments		
(Include Cntr Line & Pedestal)	Description	Notes					
Cntr Line Footg	33	SEB3-22	BSW-3 & plow picmt				
		SEB3-22I	BSW-3 & hand dig picmt				
Ped#		SEPCUTOVER	CUTOVER BSW		1		
Parish/County		BM83	BSW guard at house		1		
		XXSEB-GL	Remove temp drop		1		
Township:		BM61(1.25)SEB	BSW Bore footage		150		
Section		SEBO PER FT LBR	Fiber & plow picmt				
Range		SEBO PER FT LBR T	Fiber & hand dig picmt		35		
		SEB6-22	BSW-6 & plow picmt				
		BM2(5/8)(8)	Ground Rod				
		Trip Charge	Trip Charge		1		
		BM61(3)D-Rock CBL	Rock Boring				
		Permit	Permit		1		
Nearest cross st.				Plat Page		Map#	

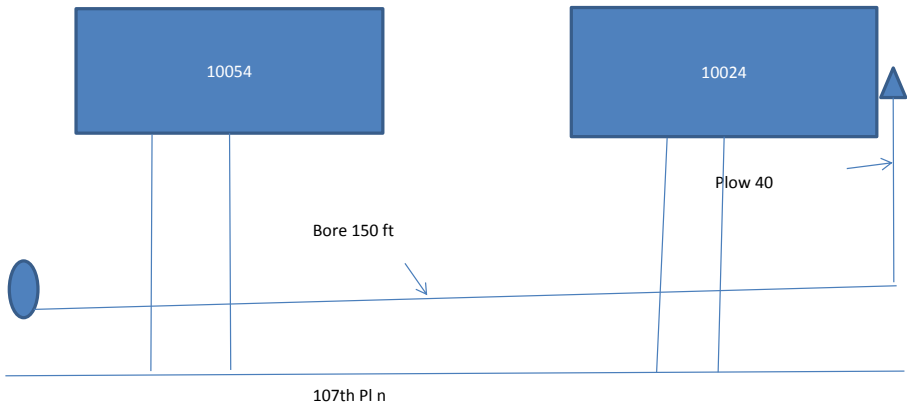

Originated By: Don Evans Date: 4/12/19 Completed By: _____ Date: _____
 Authorized By: (APS) _____ Date: _____ Inspected By: _____ Date: _____
 Authorized By: (AOM) _____ Date: _____
 Email sketch to: MetroBSW@Centurylink.com

1. Distance of the bury in Right-of-Way		3. Distance to the nearest intersection	
2. Distance from the terminal to the centerline		4. Nearest State Hwy mile marker	