

RDB-MG

13301 94th ave n

M.g.

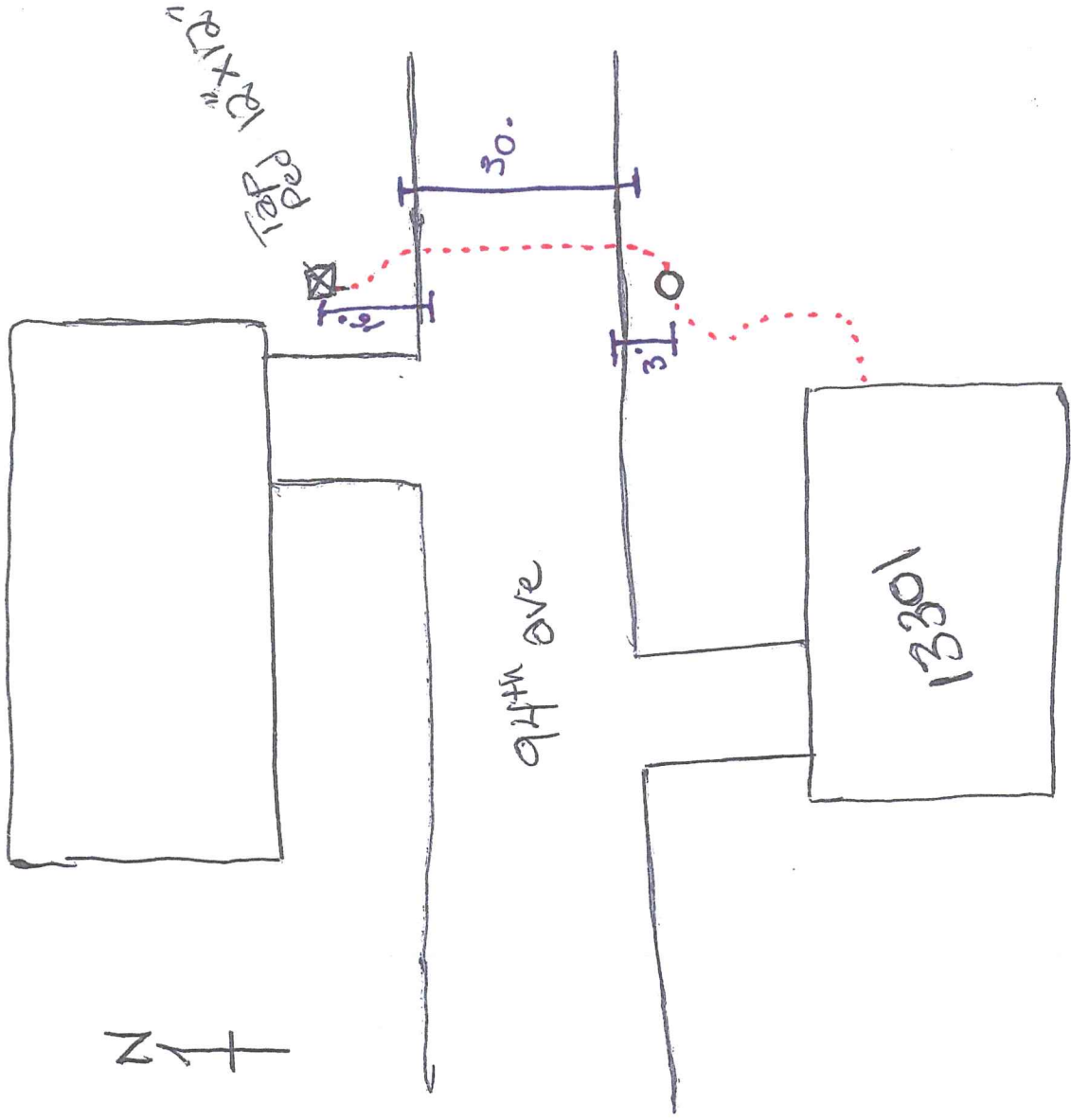



Hennepin County Property Map

Date: 4/9/2019



PARCEL ID: 1011922430017

OWNER NAME: C C & D J Leonard

PARCEL ADDRESS: 13301 94th Ave N, Maple Grove MN 55369

PARCEL AREA: 0.37 acres, 16,267 sq ft

A-T-B: Abstract

SALE PRICE: \$102,500

SALE DATA: 12/1991

SALE CODE: Warranty Deed

ASSESSED 2018, PAYABLE 2019
PROPERTY TYPE: Residential
HOMESTEAD: Homestead
MARKET VALUE: \$276,600
TAX TOTAL: \$4,058.76

ASSESSED 2019, PAYABLE 2020
PROPERTY TYPE: Residential
HOMESTEAD: Homestead
MARKET VALUE: \$298,300

Comments:

This data (i) is furnished 'AS IS' with no representation as to completeness or accuracy; (ii) is furnished with no warranty of any kind; and (iii) is not suitable for legal, engineering or surveying purposes. Hennepin County shall not be liable for any damage, injury or loss resulting from this data.

COPYRIGHT © HENNEPIN COUNTY 2019