

11084 MAPLE VALLEY DR
 ID: 37420001
 POI: K210 C01
 OSS073/B/7.9KV

TASK 1: DIRECTIONAL BORE
 BORE IN 160' OF 1/0 AL UG TRIPLEX CABLE FROM P1 TO P2

TASK 2: TERMINATION
 TERMINATE AT P1 AND P2

TASK 3: REMOVE ADD-A-PHASE

TASK 4: RESTORATION

NOTE: ABANDON EXISTING SVC CABLE IN PLACE
 REPLACE EXISTING TRANSFORMER PAD LOCK

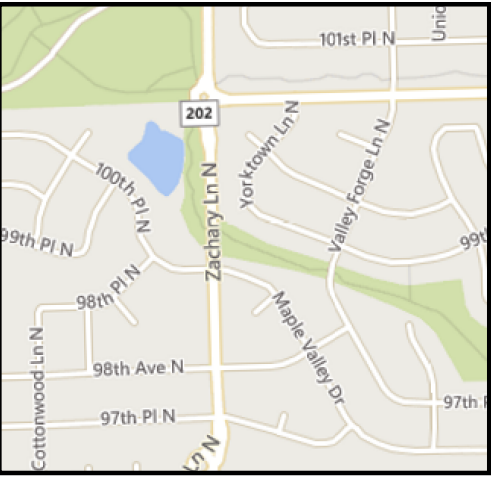

Work Order Information	
Service Request #	:
Design Number	: 000000856525
Designer/Planner ID	: 231249
Designer/Planner Name	: Barnett, Les
Designer/Planner Ph #	: (816) 414-1149
Manager Approval	:

Joint Utility	
E:	G:
T:	C:

Design Location	
Division	: Maple Grove
County	: Hennepin
City	: Maple Grove
Address	: 11084 Maple Valley Dr
T: 119N	R: 22W S: 12
Map #	: K52010 Permit : Maple Grove

Electric	
Feeder: OSS073	Voltage: 7.9KV
Phase: B	Bkup Dev ID:

Gas	
System	: Pressure
Size	: Material
Dead End	:

Work Order # : 000000102855836

Date: 04/01/2019
 Sketch: 1 Of 1 Sketch Data
 Scale: 1" equals 100'



CONSTRUCTION USE ONLY

NO CHANGES (BUILT AS DESIGNED)
 CHANGES MADE AS INDICATED
 (ALL URD MUST HAVE ACTUAL MEASUREMENTS FROM THE FIELD SITE)

RFO _____
 FOREMAN _____ DATE _____
 TEAM LEADER _____

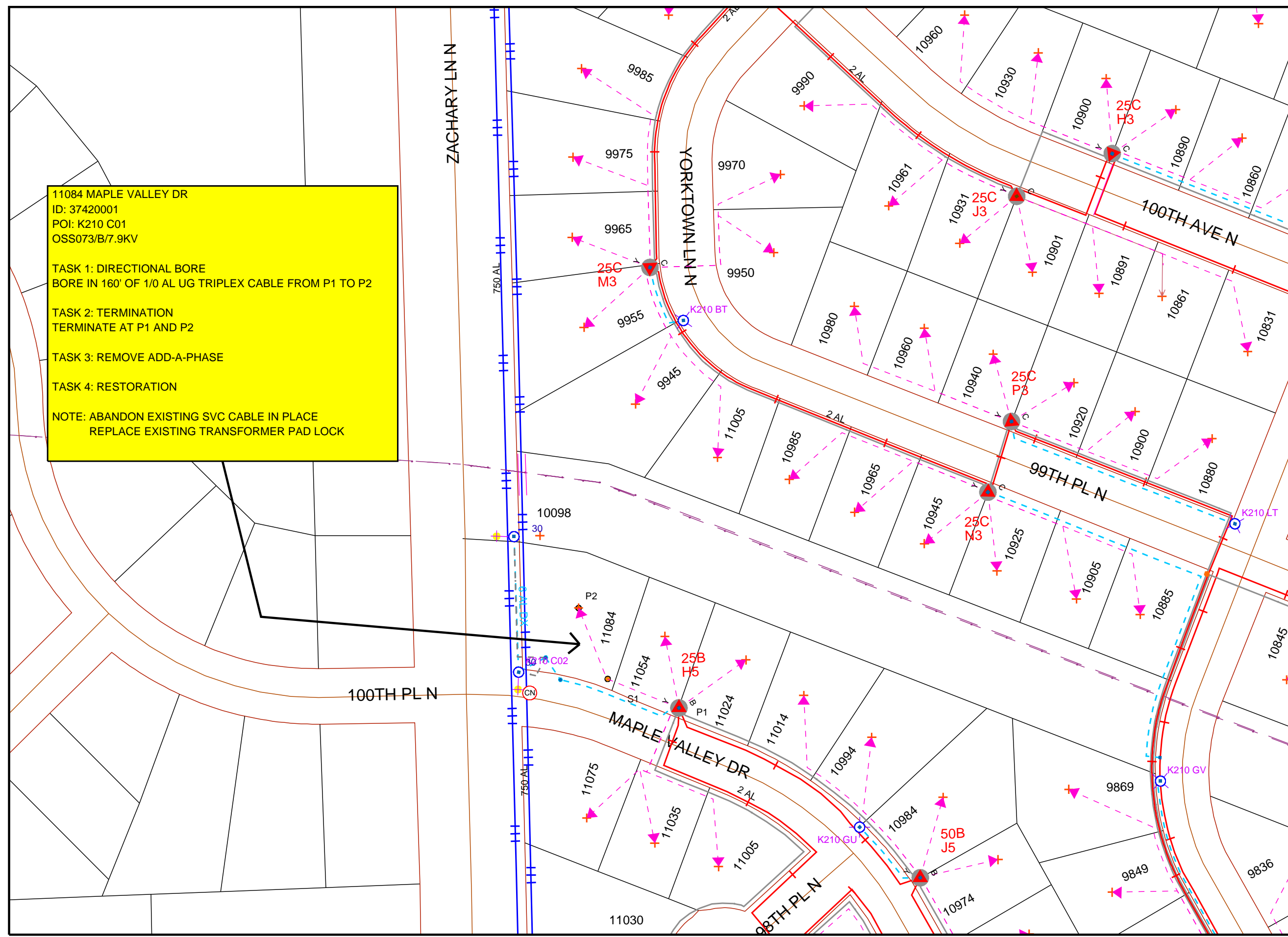

DISCLAIMER: THERE ARE NO REPRESENTATIONS OR WARRANTIES (EXPRESS OR IMPLIED) ABOUT THE ACCURACY OF THIS PRINT. THIS PRINT IS PROVIDED WITH NO CLAIM AS TO PRINT COMPLETENESS, TIMELINESS, ACCURACY OF CONTENT OR USEFULNESS. STATE LAW REQUIRES ANYONE DIGGING, GRADING OR EXCAVATING TO OBTAIN A PRIOR FIELD LOCATE OF ALL UTILITIES; THIS PRINT DOES NOT DISCHARGE THIS REQUIREMENT OR ANY OTHER REQUIREMENT. THE COMPANY AND ITS AFFILIATES ASSUME NO LEGAL RESPONSIBILITY OR LIABILITY FOR THE RECIPIENT'S USE (OR ANY OTHER PARTIES' USE) OF THE PRINT, INCLUDING THE RECIPIENT'S INTENDED PURPOSE IN USING THE PRINT. NO COMPANY EMPLOYEE OR OTHER PARTY HAS BEEN AUTHORIZED TO PROVIDE THIS PRINT FOR PLANNING OR ESTIMATING PURPOSES; RELY ON THIS PRINT AT YOUR OWN RISK. BY ACCEPTING THIS PRINT, THE RECIPIENT & ANY OTHER PARTY RECEIVING A COPY OF THE PRINT ACKNOWLEDGES AND AGREES TO THIS DISCLAIMER. For All Field Locates Call 811