

Revised 4-6-18		CMS#	19047122
CenturyLink BSW Order/Maintenance Work Authorization			
Company	T600	Exchange Name	MAPLE GROVE
Work Activity	Fiber-Buried	Capital	Y
Customer Name	Lynette Neus	Phone#	7634162671
Address	16078 70th P N	One Call Ticket#	
City & Zip	Maple Grove MN		
Location/Directions			
Description of Work or Special Instructions	Plow 175 ft from ped to nid. 75 ft of right of way bore required		

Held Order	N	Permit:	Y	Bore:	Y	CBR#	7635455412
Tech Name and Tech #	Don Evans		Employee Contact#		6124303133		

Sketch (Include Cntr Line & Pedestal)	Material/Labor Units		Footage/Quantity	Comments
	Description	Notes		
Cntr Line foot#	33	SEB3-22	BSW-3 & plow plcmt	
		SEB3-22T	BSW-3 & hand dig plcmt	
Ped#	A09F0	SEPCUTOVER	CUTOVER BSW	1
Parish/County		BM83	BSW guard at house	1
		XXSEB-GL	Remove temp drop	1
Township:		BM61(1.25)SEB	BSW Bore footage	75
Section		SEBO PER FT LBR	Fiber & plow plcmt	100
Range		SEBO PER FT LBR T	Fiber & hand dig plcmt	
		SEB6-22	BSW-6 & plow plcmt	
		BM2(5/8)(8)	Ground Rod	
		Trip Charge	Trip Charge	1
		BM61(3)D-Rock CBL	Rock Boring	
		Permit	Permit	1
Nearest cross st.			Plat Page	Map#

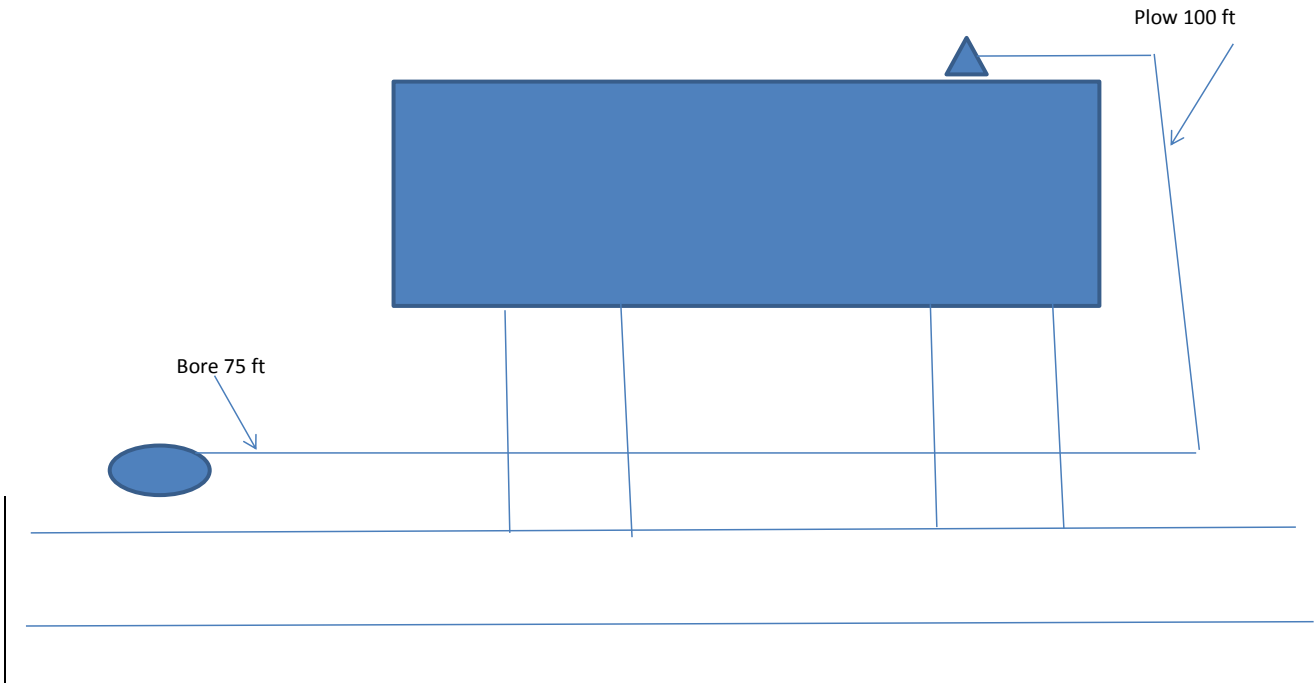

Originated By:	Don Evans	Date:	3/21/19	Completed By:		Date:	
Authorized By: (APS)		Date:		Inspected By:		Date:	
Authorized By: (AOM)		Date:					
Email sketch to:	MetroBSW@Centurylink.com						
1. Distance of the bury in Right-of-Way		3. Distance to the nearest intersection					
2. Distance from the terminal to the centerline		4. Nearest State Hwy mile marker					