

Revised 4-6-18		CMS#	19043956 - held order	
CenturyLink BSW Order/Maintenance Work Authorization				
Company	T600	Exchange Name	MAPLE GROVE	
Work Activity	Fiber-Buried	Capital	Y	Maintenance
Customer Name	Noel Morsch		Phone#	7634161563
Address	10698 Orchid Ln N		One Call Ticket#	
City & Zip	Mapke Grove Mn			
Location/Directions				
Description of Work or Special Instructions	Plow 200 ft of fiber from ped to nid. 150 ft right of way bore required			
Held Order	Y	Permit:	Y	Bore: Y
Tech Name and Tech #	Don Evans		Employee Contact#	6124303133
CBR#	7303704431			
Sketch	Material/Labor Units		Footage/Quantity	Comments
(Include Cntr Line & Pedestal)	Description	Notes		
Cntr Line foot#	33	SEB3-22	BSW-3 & plow plcmt	
		SEB3-22T	BSW-3 & hand dig plcmt	
Ped#	A0kA6	SEPCUTOVER	CUTOVER BSW	
Parish/County		BM83	BSW guard at house	1
		XXSEB-GL	Remove temp drop	
Township:		BM61(1.25)SEB	BSW Bore footage	150
Section		SEBO PER FT LBR	Fiber & plow plcmt	
Range		SEBO PER FT LBR T	Fiber & hand dig plcmt	50
		SEB6-22	BSW-6 & plow plcmt	
		BM2(5/8)(8)	Ground Rod	
		Trip Charge	Trip Charge	1
		BM61(3)D-Rock CBL	Rock Boring	
		Permit	Permit	1
Nearest cross st.			Plat Page	Map#

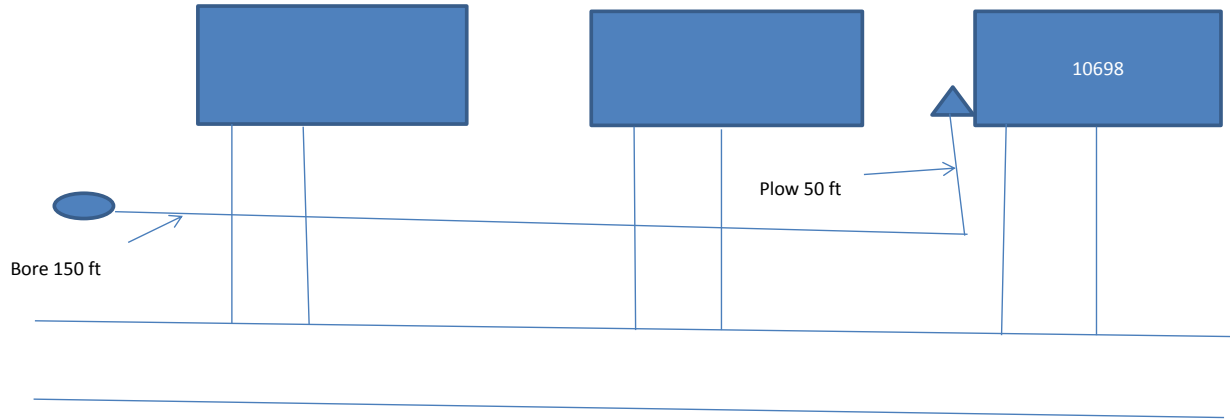

Originated By:	DonnEvans	Date:	3/15/19	Completed By:		Date:	
Authorized By: (APS)		Date:		Inspected By:		Date:	
Authorized By: (AOM)		Date:					
Email sketch to:	MetroBSW@Centurylink.com						

1. Distance of the bury in Right-of-Way		3. Distance to the nearest intersection	
2. Distance from the terminal to the centerline		4. Nearest State Hwy mile marker	