

BORE SECONDARY AND SET PEDESTAL TO FEED 2 NEW HOMES. ECK322 7.9 KV

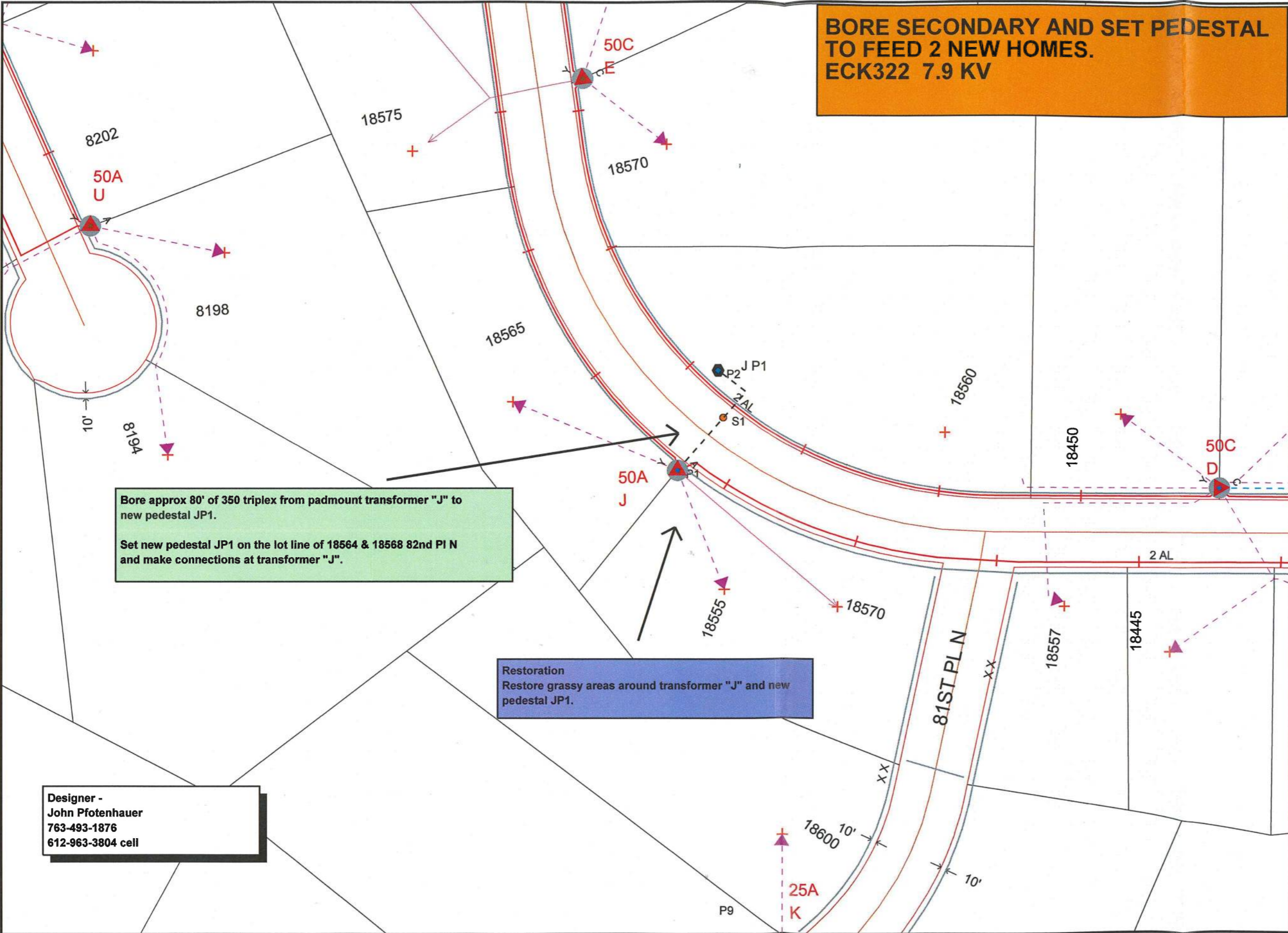

Bore approx 80' of 350 triplex from padmount transformer "J" to new pedestal JP1.
Set new pedestal JP1 on the lot line of 18564 & 18568 82nd Pl N and make connections at transformer "J".

Restoration
Restore grassy areas around transformer "J" and new pedestal JP1.

Designer -
John Pfothenauer
763-493-1876
612-963-3804 cell

Work Order Information

Service Request #	:	
Design Number	:	00000847426
Designer/Planner ID	:	ptj01
Designer/Planner Name	:	Pfothenauer, John
Designer/Planner Ph #	:	(763) 493-1876
Manager Approval	:	

Joint Utility

E:	G:
T:	C:

Design Location

Division	:	Maple Grove
County	:	Hennepin
City	:	Maple Grove
Address	:	18564 82nd Pl N
T: 119N	R: 22W	S: 19
Map #	:	J52070
Permit	:	

Electric

Feeder: ECK322	Voltage: 7970 KVA
Phase: A	Bkup Dev ID:

Gas

System	:	Pressure	:
Size	:	Material	:
Dead End	:		

Work Order #

Date: 02/19/2019
Sketch: 1 Of 1 Sketch Data
Scale: 1" equals 83'

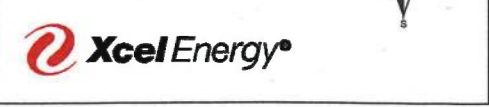

CONSTRUCTION USE ONLY

- NO CHANGES (BUILT AS DESIGNED)
- CHANGES MADE AS INDICATED (ALL URD MUST HAVE ACTUAL MEASUREMENTS FROM THE FIELD SITE)

RFO _____
FOREMAN _____ DATE _____
TEAM LEADER _____

DISCLAIMER: THERE ARE NO REPRESENTATIONS OR WARRANTIES (EXPRESS OR IMPLIED) ABOUT THE ACCURACY OF THIS PRINT. THIS PRINT IS PROVIDED WITH NO CLAIM AS TO PRINT COMPLETENESS, TIMELINESS, ACCURACY OF CONTENT OR USEFULNESS. STATE LAW REQUIRES ANYONE DIGGING, GRADING OR EXCAVATING TO OBTAIN A PRIOR FIELD LOCATE OF ALL UTILITIES; THIS PRINT DOES NOT DISCHARGE THIS REQUIREMENT OR ANY OTHER REQUIREMENT. THE COMPANY AND ITS AFFILIATES ASSUME NO LEGAL RESPONSIBILITY OR LIABILITY FOR THE RECIPIENT'S USE (OR ANY OTHER PARTIES' USE) OF THE PRINT, INCLUDING THE RECIPIENT'S INTENDED PURPOSE IN USING THE PRINT. NO COMPANY EMPLOYEE OR OTHER PARTY HAS BEEN AUTHORIZED TO PROVIDE THIS PRINT FOR PLANNING OR ESTIMATING PURPOSES; RELY ON THIS PRINT AT YOUR OWN RISK. BY ACCEPTING THIS PRINT, THE RECIPIENT & ANY OTHER PARTY RECEIVING A COPY OF THE PRINT ACKNOWLEDGES AND AGREES TO THIS DISCLAIMER. For All Field Locates Call 811