

GENERAL LOCATION ONLY.  
DO NOT USE TO LOCATE FOR EXCAVATION.  
CALL 1-800-252-1166 FOR ONSITE LOCATIONS AND STAKING.

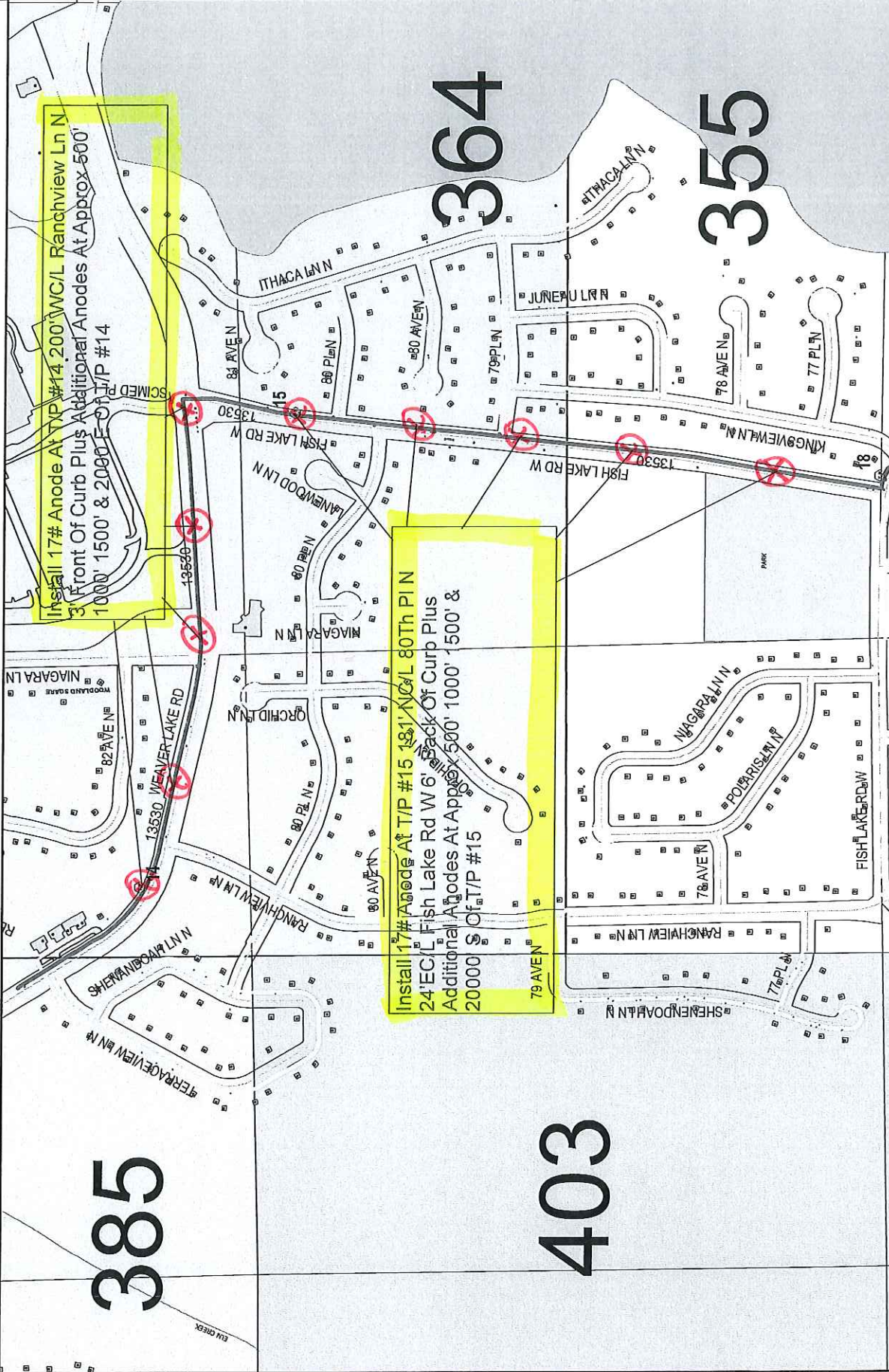

Scale: 1" = 543'



Install 17# Anode At T/P #14 200' WC/L Ranchview Ln N  
3' Front Of Curb Plus Additional Anodes At Approx 500'  
1000' 1500' & 2000' E Of T/P #14

Install 17# Anode At T/P #15 181' WC/L 80Th PIN  
24' ECL Fish Lake Rd W 6' Back Of Curb Plus  
Additional Anodes At Approx 500' 1000' 1500' &  
2000' S Of T/P #15

385

364

355

403

Work Order #: 88706404  
Design Date: 12/27/2018

City: Maple Grove  
CP Section #: 13530  
CP Area: 364-355  
Quad/Sec/Twp/Rng: SE 1/4, Sec21, T119/R22  
Designed By: D Justin  
Designer Phone #: 612-910-1555

GENERAL LOCATION ONLY.  
DO NOT USE TO LOCATE FOR EXCAVATION.  
CALL 1-800-252-1166 FOR ONSITE LOCATIONS AND STAKING.



Scale: 1" = 868'



North

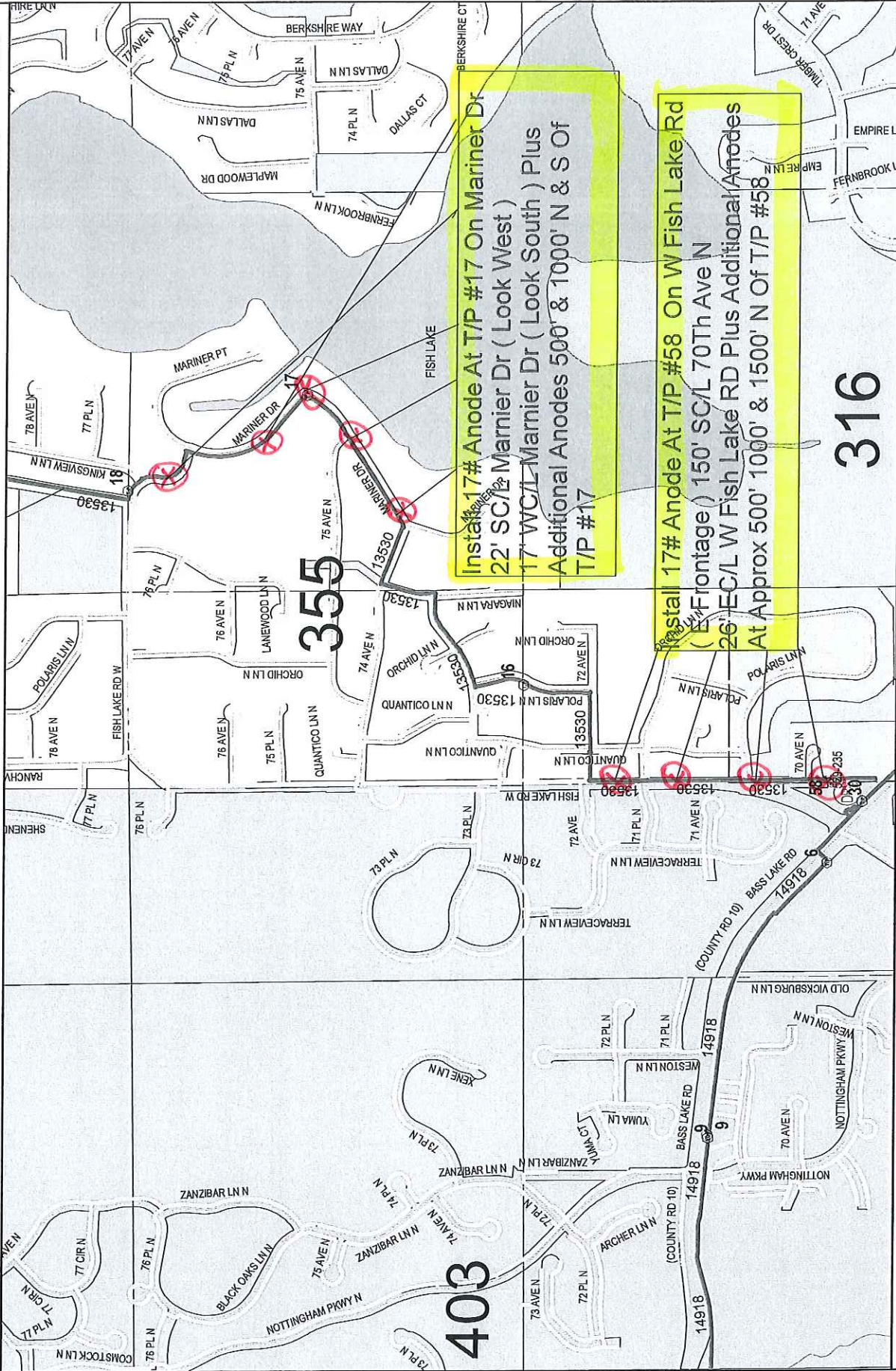

Install 17# Anode At T/P #17 On Mariner Dr  
22' SC/L Mariner Dr ( Look West )  
17' WC/L Mariner Dr ( Look South ) Plus  
Additional Anodes 500' & 1000' N & S Of  
T/P #17

Install 17# Anode At T/P #58 On W Fish Lake Rd  
( E Frontage ) 150' SC/L 70Th Ave N  
26' EC/L W Fish Lake Rd Plus Additional Anodes  
At Approx 500' 1000' & 1500' N Of T/P #58

Work Order #: 88706404  
Design Date: 12/27/2018

City: Maple Grove  
Quad/Sec/Twp/Rng: SW 1/4, Sec28, T119/R22

CP Section #: 13530  
CP Area: 355-316  
Designed By: D Justin  
Designer Phone #: 612-910-1555