

**ABRA Autobody - Bore new UG and set transformer.
ECK322 34.5KV**

Set new 277/480 75KVA padmount transformer and pad.
POI- K52012T01.

Service Connections
Customer is running 2 sets of #3/0AL secondary for a 277/480 3PH 400A service.
NOTE: Transformer K52012T01 will feed temp service to site.
Temp service is 277/480 3PH 4-wire 200A service.

Splice into existing 1/0AL 34.5KV cables in 2 locations for loop feed to new padmount transformer K52012T01.



Bore
Bore approx 400' of 1/0AL 3PH 34.5KV cable from splice pit to new 277/480 75KVA padmount transformer and back for a total of 800'.

Restoration
Restore grassy area in ROW at splice pit location.
Restore along bore route as needed.

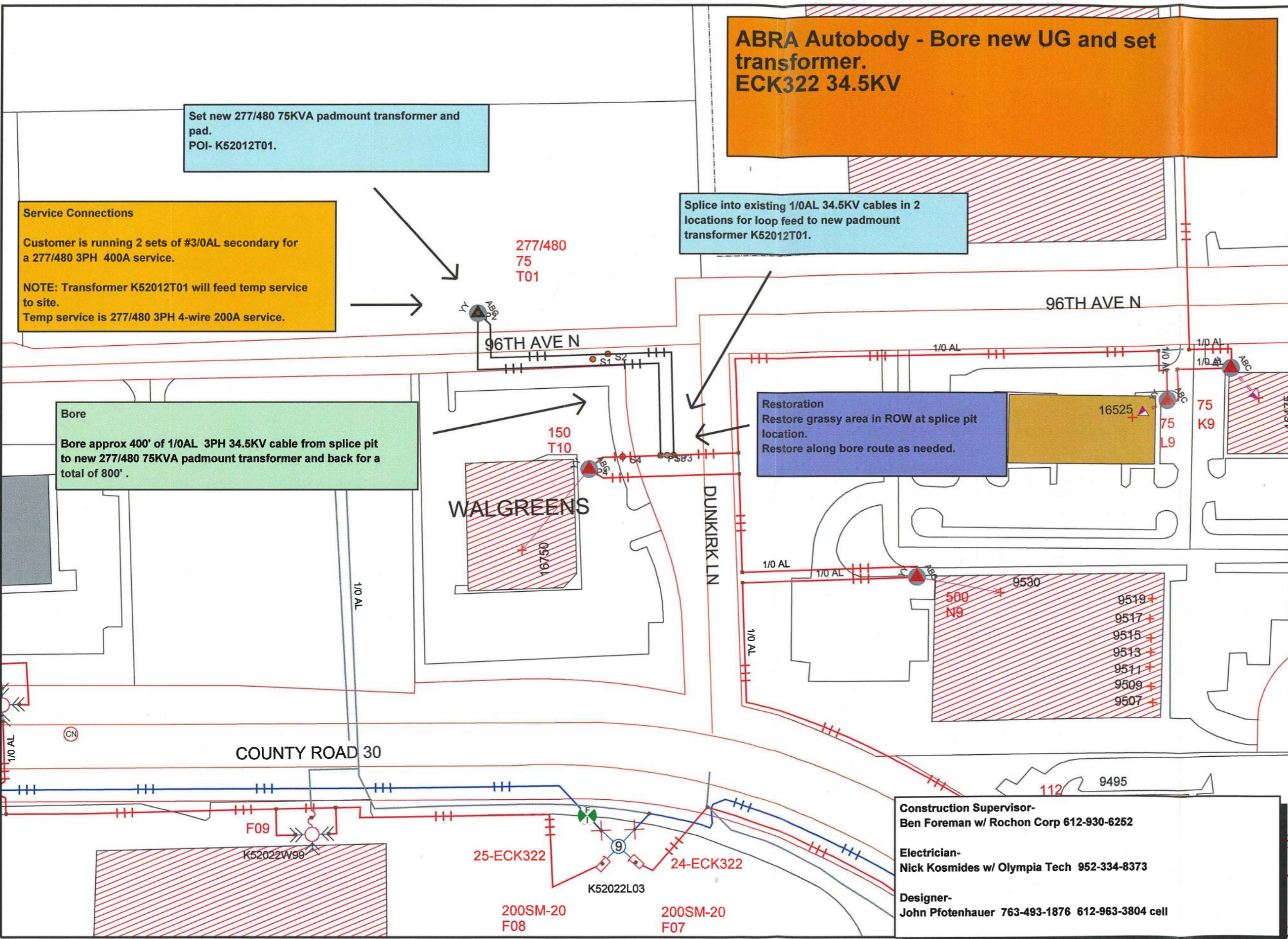

Work Order Information	
Service Request #	:
Design Number	: 00000826979
Designer/Planner ID	: pftj01
Designer/Planner Name	: Pfothenauer, John
Designer/Planner Ph #	: (763) 493-1876
Manager Approval	:

Joint Utility	
E:	G:
T:	C:

Design Location	
Division	: Maple Grove
County	: Hennepin
City	: Maple Grove
Address	: 16750 96th Ave N
T: 119N	R: 22W S: 8
Map #	: K52022 Permit :

Electric	
Feeder: ECK322	Voltage: 13800 KVA
Phase: ABC	Bkup Dev ID:

Gas	
System	: Pressure :
Size	: Material :
Dead End	:

Work Order #	:
Date:	12/11/2018
Sketch:	1 Of 1 Sketch Data
Scale:	1" equals 100'



Construction Supervisor-
Ben Foreman w/ Rochon Corp 612-930-6252

Electrician-
Nick Kosmides w/ Olympia Tech 952-334-8373

Designer-
John Pfothenauer 763-493-1876 612-963-3804 cell

CONSTRUCTION USE ONLY	
<input type="checkbox"/>	NO CHANGES (BUILT AS DESIGNED)
<input type="checkbox"/>	CHANGES MADE AS INDICATED (ALL URD MUST HAVE ACTUAL MEASUREMENTS FROM THE FIELD SITE)
RFO	_____
FOREMAN	_____ DATE _____
TEAM LEADER	_____

DISCLAIMER: THERE ARE NO REPRESENTATIONS OR WARRANTIES (EXPRESS OR IMPLIED) ABOUT THE ACCURACY OF THIS PRINT. THIS PRINT IS PROVIDED WITH NO CLAIM AS TO PRINT COMPLETENESS, TIMELINESS, ACCURACY OF CONTENT OR USEFULNESS. STATE LAW REQUIRES ANYONE DIGGING, GRADING OR EXCAVATING TO OBTAIN A PRIOR FIELD LOCATE OF ALL UTILITIES; THIS PRINT DOES NOT DISCHARGE THIS REQUIREMENT OR ANY OTHER REQUIREMENT. THE COMPANY AND ITS AFFILIATES ASSUME NO LEGAL RESPONSIBILITY OR LIABILITY FOR THE RECIPIENT'S USE (OR ANY OTHER PARTIES' USE) OF THE PRINT, INCLUDING THE RECIPIENT'S INTENDED PURPOSE IN USING THE PRINT. NO COMPANY EMPLOYEE OR OTHER PARTY HAS BEEN AUTHORIZED TO PROVIDE THIS PRINT FOR PLANNING OR ESTIMATING PURPOSES; RELY ON THIS PRINT AT YOUR OWN RISK. BY ACCEPTING THIS PRINT, THE RECIPIENT & ANY OTHER PARTY RECEIVING A COPY OF THE PRINT ACKNOWLEDGES AND AGREES TO THIS DISCLAIMER. For All Field Locates Call 811