

7779 Ranchview Ln N, Maple Grove

Task 1: Directional Bore
 Bore in 6600' of #2 AI UG cable from S70 to T4, T4 to S4, S4 to V4, V4 to X4, X4 to W4, W4 to R4, P4 to N4, N4 to M1, M1 to L1 and L1 to K1.

Task 2: Terminations
 Terminate at S70, T4, S4, V4, X4, W4, R4, P4, N4, M1, L1 and K1.

Task 3: Restoration

- LAST FAULT: R4 - W4; 7-30-16
- #2 AI UG Cable Replacement

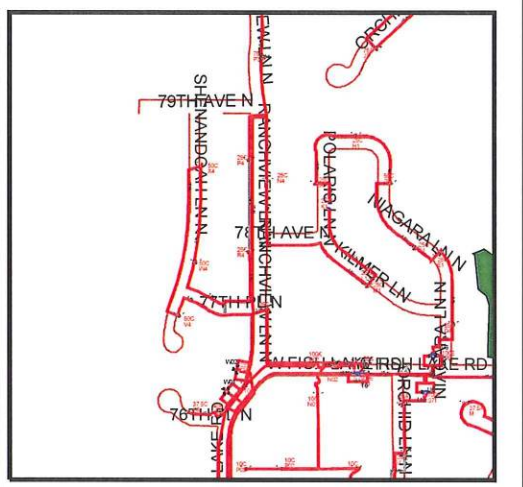
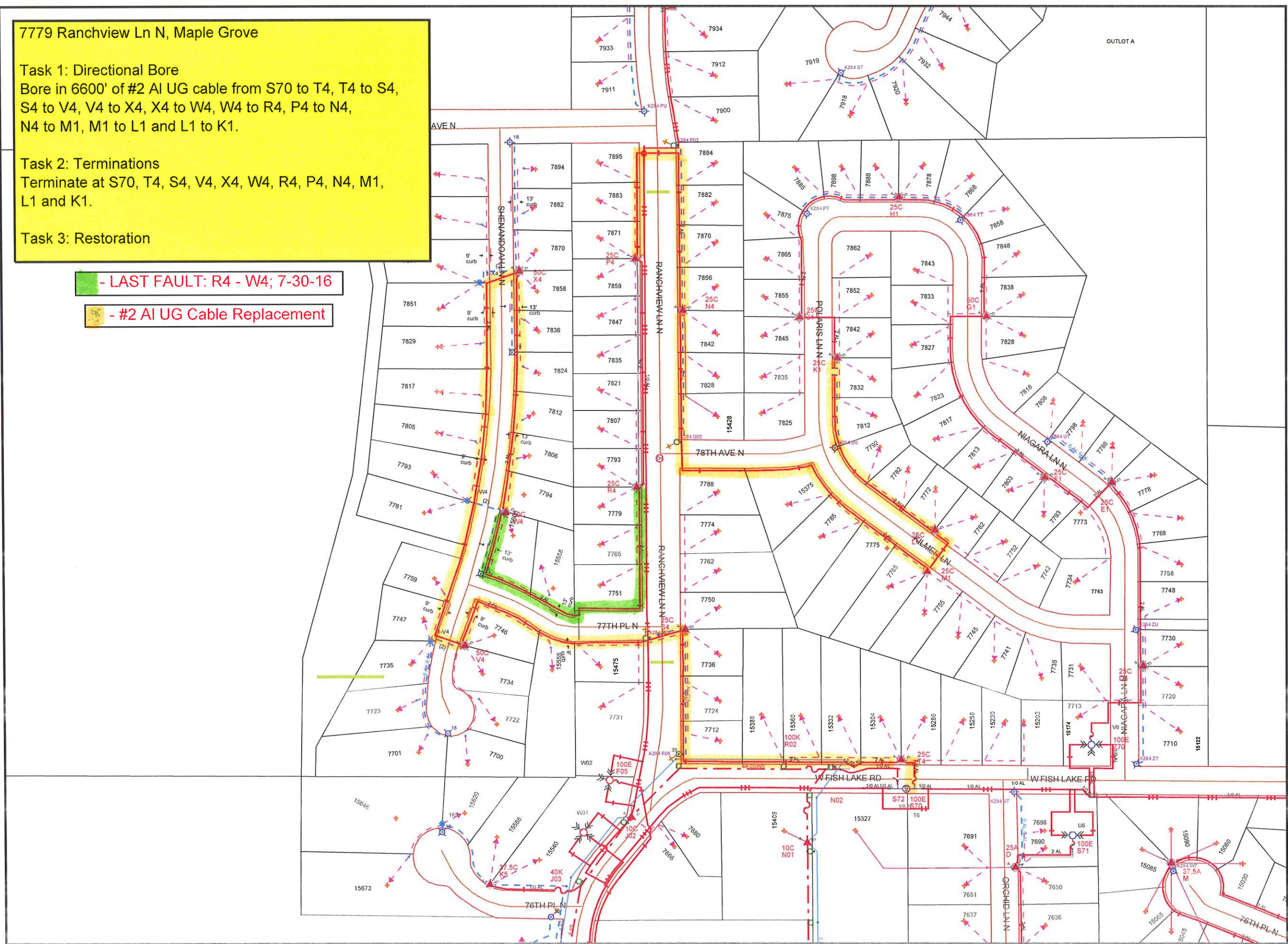

Alex Ludwig
 O (651)-229-5549
 C (320)-469-0718

Work Order Information	
Service Request #	:
Design Number	: 0000548475
Designer/Planner ID	: 224039
Designer/Planner Name	: Ludwig, Alex
Designer/Planner Ph #	: (651) 229-5549
Manager Approval	:

Joint Utility	
E:	G:
T:	C:

Design Location	
Division	: Maple Grove
County	: Hennepin
City	: Maple Grove
Address	: 7779 Ranchview Ln N
T: R: S:	: 119N R: 22W S: 21
Map #	: K52084
Permit	:

Electric	
Feeder: ECK062	Voltage: 7.97
Phase: C	Bkup Dev ID:

Gas	
System	: Pressure
Size	: Material
Dead End	:

Work Order # : 12436539
 Date: 09/07/2016
 Sketch: 1 Of 1 Sketch Data
 Scale: 1" equals 200'



CONSTRUCTION USE ONLY

NO CHANGES (BUILT AS DESIGNED)
 CHANGES MADE AS INDICATED (ALL URD MUST HAVE ACTUAL MEASUREMENTS FROM THE FIELD SITE)

RFO _____
 FOREMAN _____ DATE _____
 TEAM LEADER _____

DISCLAIMER: THERE ARE NO REPRESENTATIONS OR WARRANTIES (EXPRESS OR IMPLIED) ABOUT THE ACCURACY OF THIS PRINT. THIS PRINT IS PROVIDED WITH NO CLAIM AS TO PRINT COMPLETENESS, TIMELINESS, ACCURACY OF CONTENT OR USEFULNESS. STATE LAW REQUIRES ANYONE DIGGING, GRADING OR EXCAVATING TO OBTAIN A PRIOR FIELD LOCATE OF ALL UTILITIES; THIS PRINT DOES NOT DISCHARGE THIS REQUIREMENT OR ANY OTHER REQUIREMENT. THE COMPANY AND ITS AFFILIATES ASSUME NO LEGAL RESPONSIBILITY OR LIABILITY FOR THE RECIPIENT'S USE (OR ANY OTHER PARTIES' USE) OF THE PRINT, INCLUDING THE RECIPIENT'S INTENDED PURPOSE IN USING THE PRINT. NO COMPANY EMPLOYEE OR OTHER PARTY HAS BEEN AUTHORIZED TO PROVIDE THIS PRINT FOR PLANNING OR ESTIMATING PURPOSES; RELY ON THIS PRINT AT YOUR OWN RISK. BY ACCEPTING THIS PRINT, THE RECIPIENT & ANY OTHER PARTY RECEIVING A COPY OF THE PRINT ACKNOWLEDGES AND AGREES TO THIS DISCLAIMER. For All Field Locates Call 811