

GENERAL LOCATION ONLY.
DO NOT USE TO LOCATE FOR EXCAVATION.
CALL 1-800-252-1166 FOR ONSITE LOCATIONS AND STAKING.

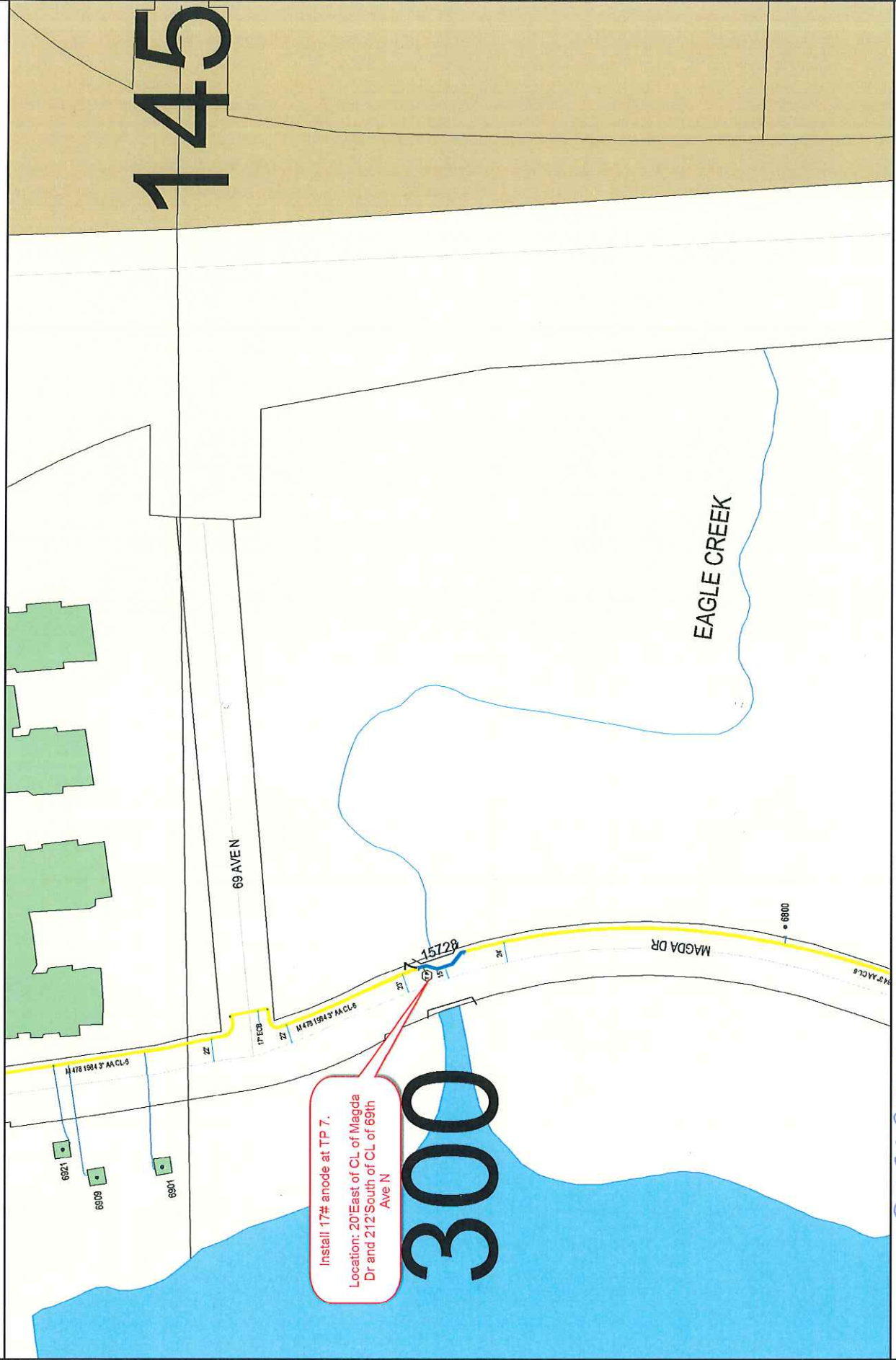

Scale: 1" = 157'



Install 17# anode at TP 7.
Location: 20' East of CL of Magda Dr and 212' South of CL of 69th Ave N

Work Order #: 87509151
Design Date: 8/30/18

City: Mimreapotts Maple grove CP Section #: 15728/15728 Designed By: Mike McCall
Quad/Sec/Twp/Rng: NE 1/4, Sec 36, 119/22 CP Area: 300 Designer Phone #: 612-979-8022