

Revised 4-6-18		CMS#	18152445 PERMIT	
<b>CenturyLink BSW Order/Maintenance Work Authorization</b>				
Company	T600	Exchange Name	MAPLE GROVE	
Work Activity	Fiber-Buried	Capital	Y	Service Order#
Customer Name	John Hanson		Phone#	7634240364
Address	8585 Magnolia Ct N		One Call Ticket#	
City & Zip	Maple Grove MN			
Location/Directions				
Description of Work or Special Instructions	Plow 170 of fiber from ped to Nid			

Held Order	N	Permit:	Y	Bore:	Y	CBR#	6514681009
Tech Name and Tech #	Don Evans		Employee Contact#	6124303133			
Sketch	Material/Labor Units			Footage/Quantity	Comments		
(Include Cntr Line & Pedestal)	Description	Notes					
Cntr Line Footg	33	SEB3-22	BSW-3 & plow picmt				
		SEB3-22T	BSW-3 & hand dig picmt				
Ped#		SEPCUTOVER	CUTOVER BSW	1			
Parish/County		BM83	BSW guard at house	1			
		XXSEB-GL	Remove temp drop	1			
Township:		BM61(1.25)SEB	BSW Bore footage	160			
Section		SEBO PER FT LBR	Fiber & plow picmt	45			
Range		SEBO PER FT LBR T	Fiber & hand dig picmt				
		SEB6-22	BSW-6 & plow picmt				
		BM2(5/8)(8)	Ground Rod				
		Trip Charge	Trip Charge	1			
		BM61(3)D-Rock CBL	Rock Boring				
		Permit	Permit	1			
Nearest cross st.				Plat Page	Map#		

**Estimated Cost**

--

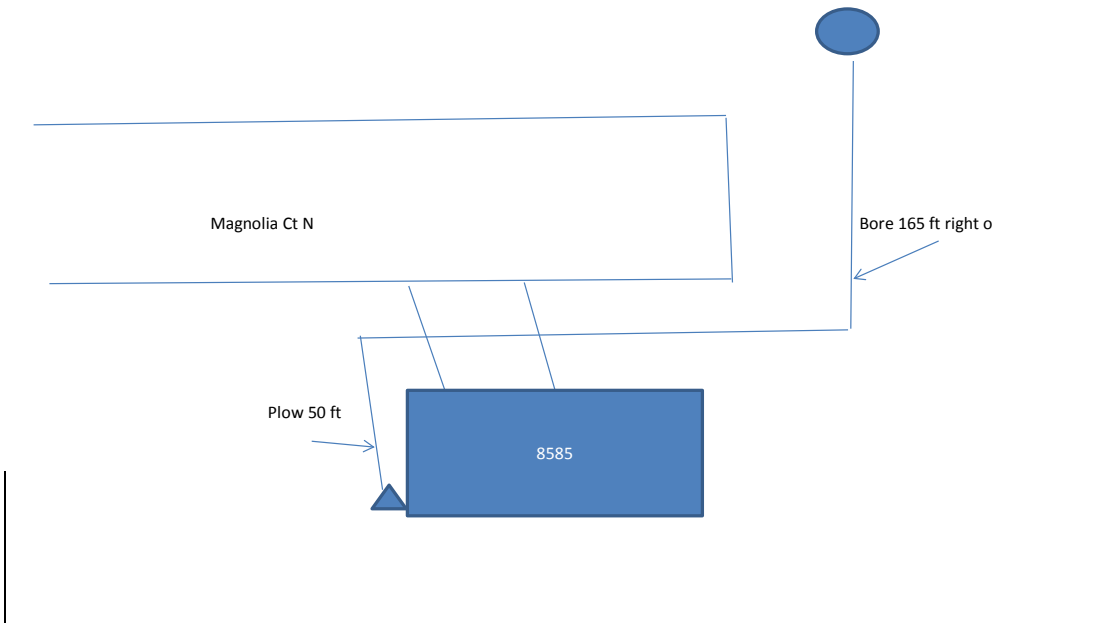

Originated By:	Don Evans	Date:	8/17/18	Completed By:		Date:	
Authorized By: (APS)		Date:		Inspected By:		Date:	
Authorized By: (AOM)		Date:					
Email sketch to:	MetroBSW@Centurylink.com						

1. Distance of the bury in Right-of-Way		3. Distance to the nearest intersection	
2. Distance from the terminal to the centerline		4. Nearest State Hwy mile marker	