

612-749-5955, Foreman #
Route Changes marked in Black
and Highlighted in Green.

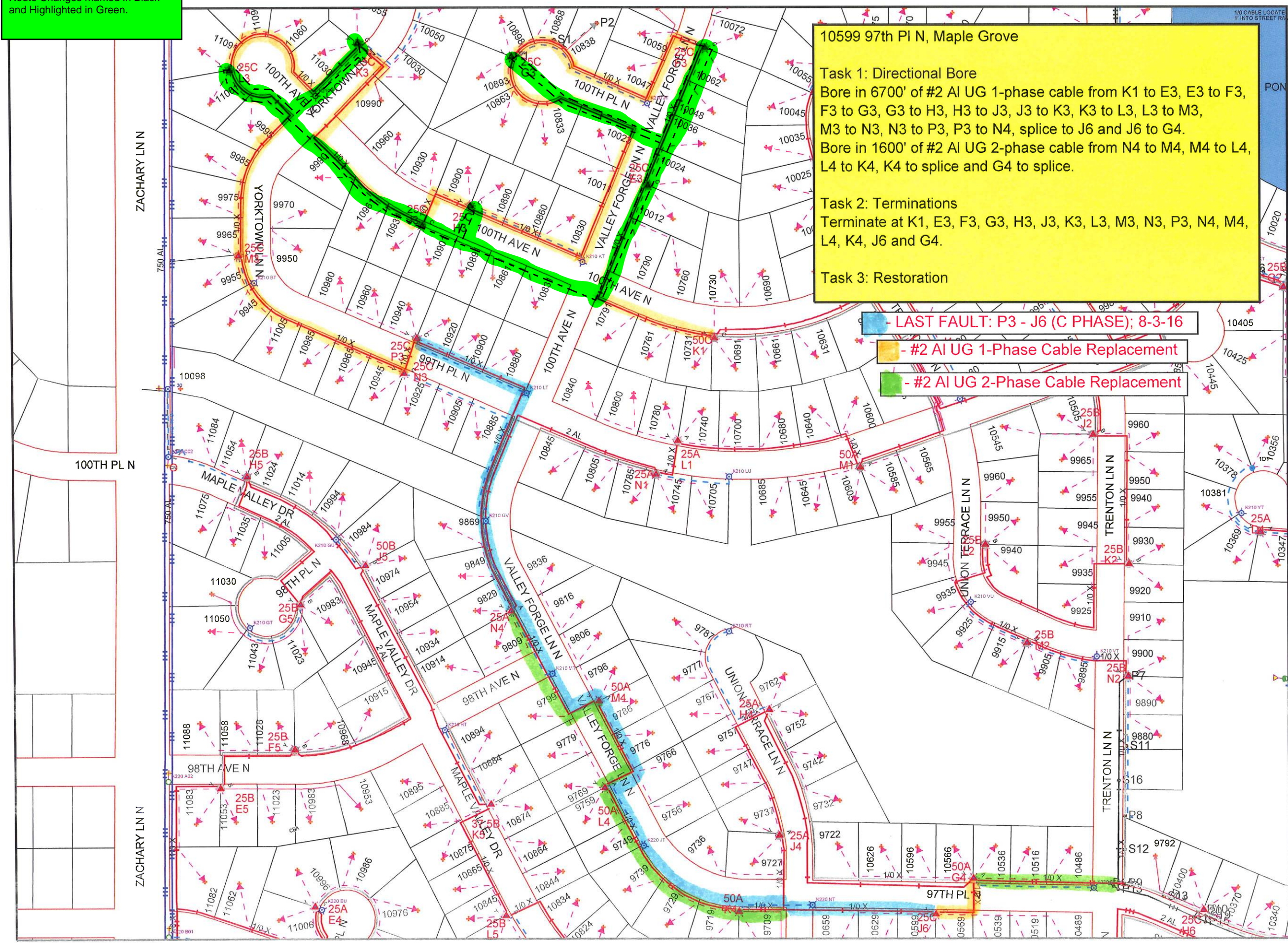

10599 97th PI N, Maple Grove

Task 1: Directional Bore
Bore in 6700' of #2 AI UG 1-phase cable from K1 to E3, E3 to F3, F3 to G3, G3 to H3, H3 to J3, J3 to K3, K3 to L3, L3 to M3, M3 to N3, N3 to P3, P3 to N4, splice to J6 and J6 to G4.
Bore in 1600' of #2 AI UG 2-phase cable from N4 to M4, M4 to L4, L4 to K4, K4 to splice and G4 to splice.

Task 2: Terminations
Terminate at K1, E3, F3, G3, H3, J3, K3, L3, M3, N3, P3, N4, M4, L4, K4, J6 and G4.

Task 3: Restoration

- LAST FAULT: P3 - J6 (C PHASE); 8-3-16
- #2 AI UG 1-Phase Cable Replacement
- #2 AI UG 2-Phase Cable Replacement

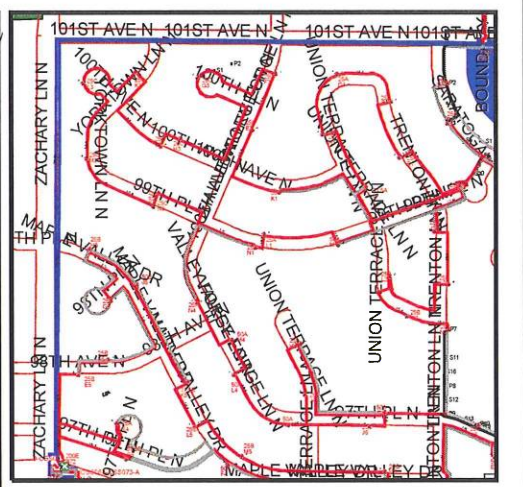

Alex Ludwig
O (651)-229-5549
C (320)-469-0718

Work Order Information	
Service Request #	: 0000548069
Design Number	: 224039
Designer/Planner ID	: Ludwig, Alex
Designer/Planner Ph #	: (651) 229-5549
Manager Approval	:

Joint Utility	
E:	G:
T:	C:

Design Location	
Division	: Maple Grove
County	: Hennepin
City	: Maple Grove
Address	: 10599 97th PI N
T: 119N	R: 22W S: 12
Map #	: K52010 Permit :

Electric	
Feeder: OSS073	Voltage: 7.97
Phase: AC	Bkup Dev ID:

Gas	
System	: Pressure :
Size	: Material :
Dead End	:

Work Order # : 12435292
Date: 09/02/2016
Sketch: 1 of 1 Sketch Data
Scale: 1" equals 200'

CONSTRUCTION USE ONLY	
<input type="checkbox"/>	NO CHANGES (BUILT AS DESIGNED)
<input type="checkbox"/>	CHANGES MADE AS INDICATED (ALL URD MUST HAVE ACTUAL MEASUREMENTS FROM THE FIELD SITE)
RFO	DATE
FOREMAN	DATE
TEAM LEADER	

DISCLAIMER: THERE ARE NO REPRESENTATIONS OR WARRANTIES (EXPRESS OR IMPLIED) ABOUT THE ACCURACY OF THIS PRINT. THIS PRINT IS PROVIDED WITH NO CLAIM AS TO PRINT COMPLETENESS, TIMELINESS, ACCURACY OF CONTENT OR USEFULNESS. STATE LAW REQUIRES ANYONE DIGGING, GRADING OR EXCAVATING TO OBTAIN A PRIOR FIELD LOCATE OF ALL UTILITIES. THIS PRINT DOES NOT DISCHARGE THIS REQUIREMENT OR ANY OTHER REQUIREMENT. THE COMPANY AND ITS AFFILIATES ASSUME NO LEGAL RESPONSIBILITY OR LIABILITY FOR THE RECIPIENT'S USE (OR ANY OTHER PARTIES' USE) OF THE PRINT, INCLUDING THE RECIPIENT'S INTENDED PURPOSE IN USING THE PRINT. NO COMPANY EMPLOYEE OR OTHER PARTY HAS BEEN AUTHORIZED TO PROVIDE THIS PRINT FOR PLANNING OR ESTIMATING PURPOSES; RELY ON THIS PRINT AT YOUR OWN RISK. BY ACCEPTING THIS PRINT, THE RECIPIENT & ANY OTHER PARTY RECEIVING A COPY OF THE PRINT ACKNOWLEDGES AND AGREES TO THIS DISCLAIMER. For All Field Locates Call 611

